

# DOUGLAS COUNTY, OREGON RIGHT-OF-WAY PLANS FOR MANNING RD. #168 M. P. 0.00 TO M. P. 0.49 2007

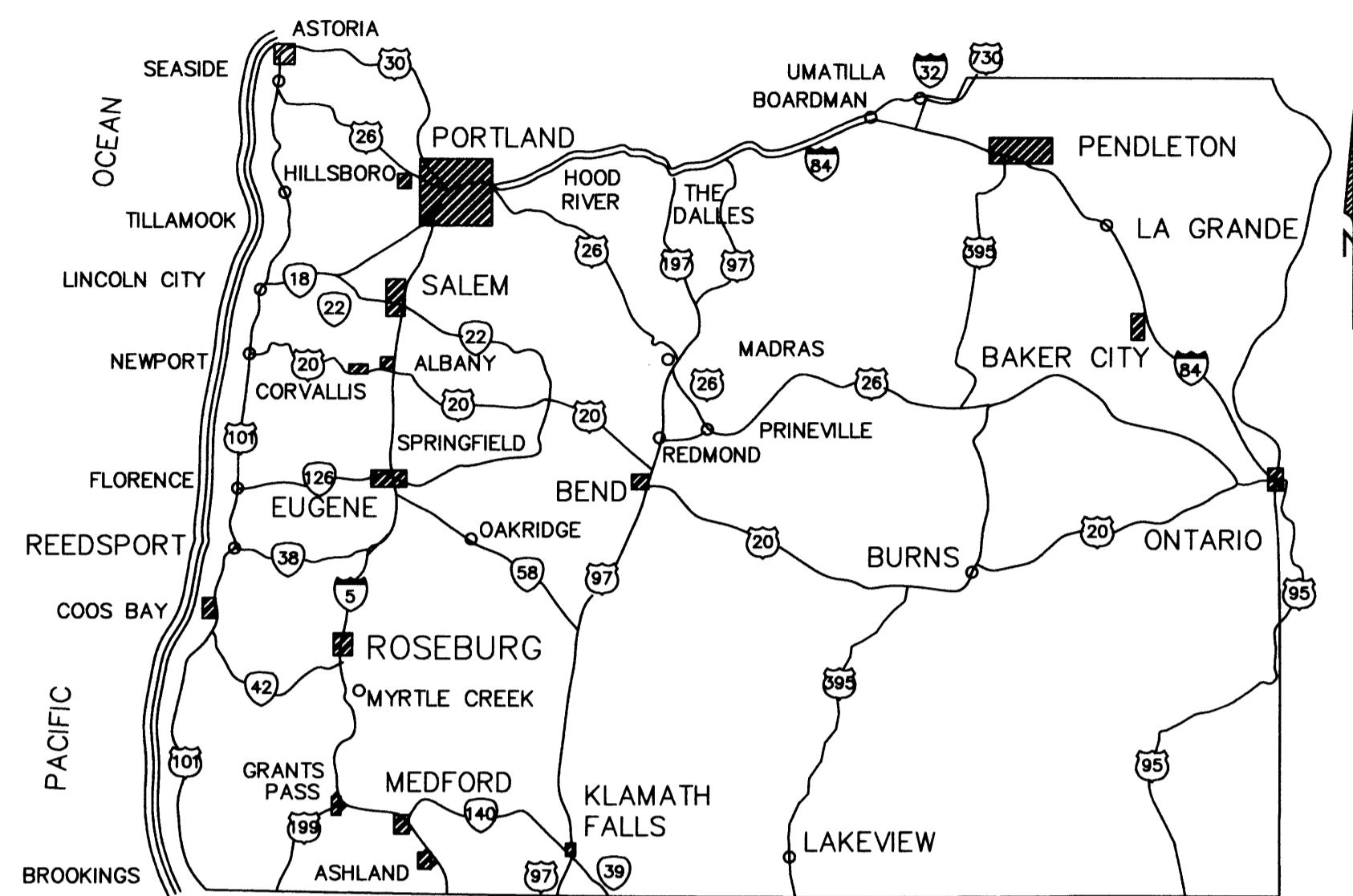

STATE OF OREGON

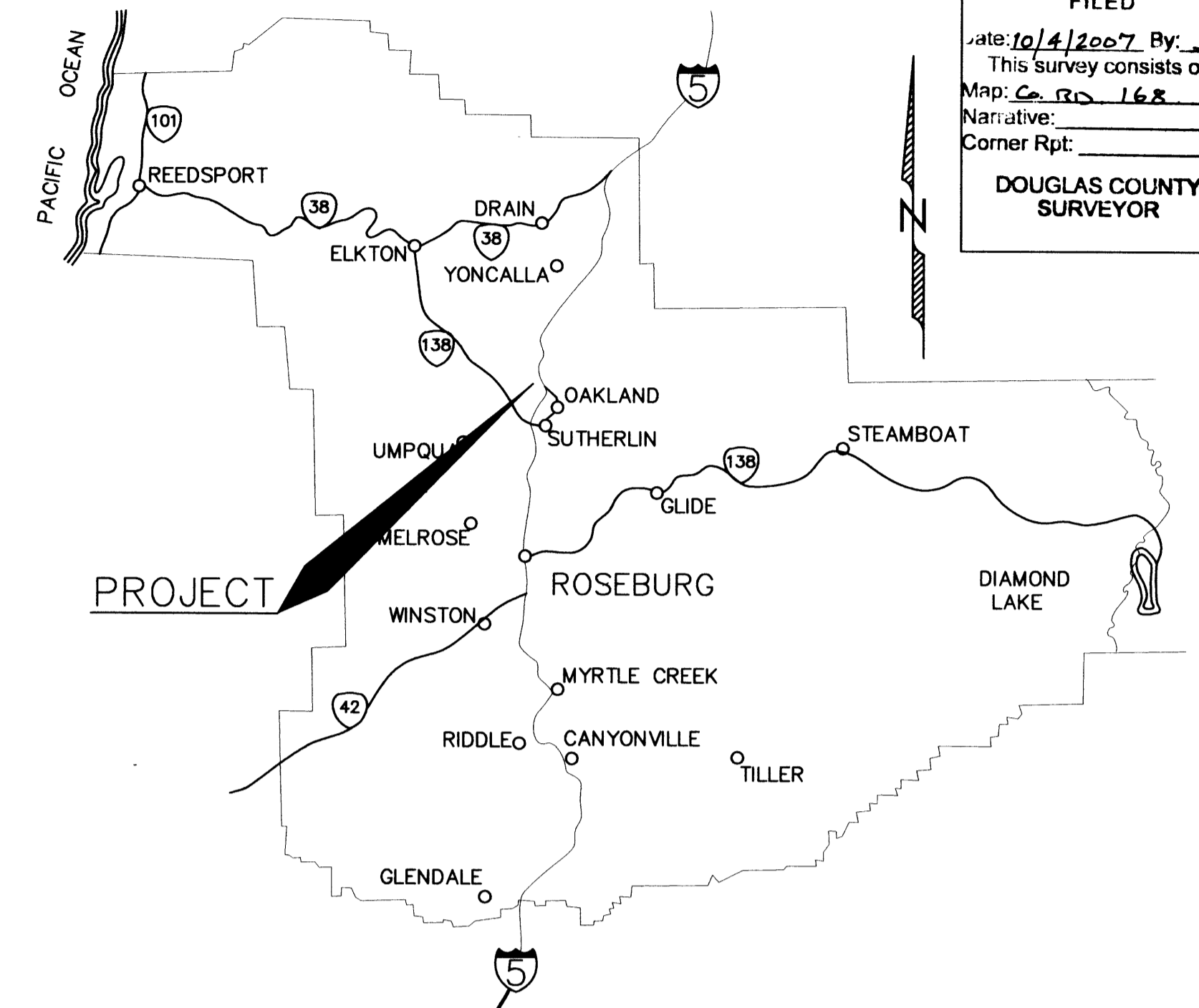

DOUGLAS COUNTY

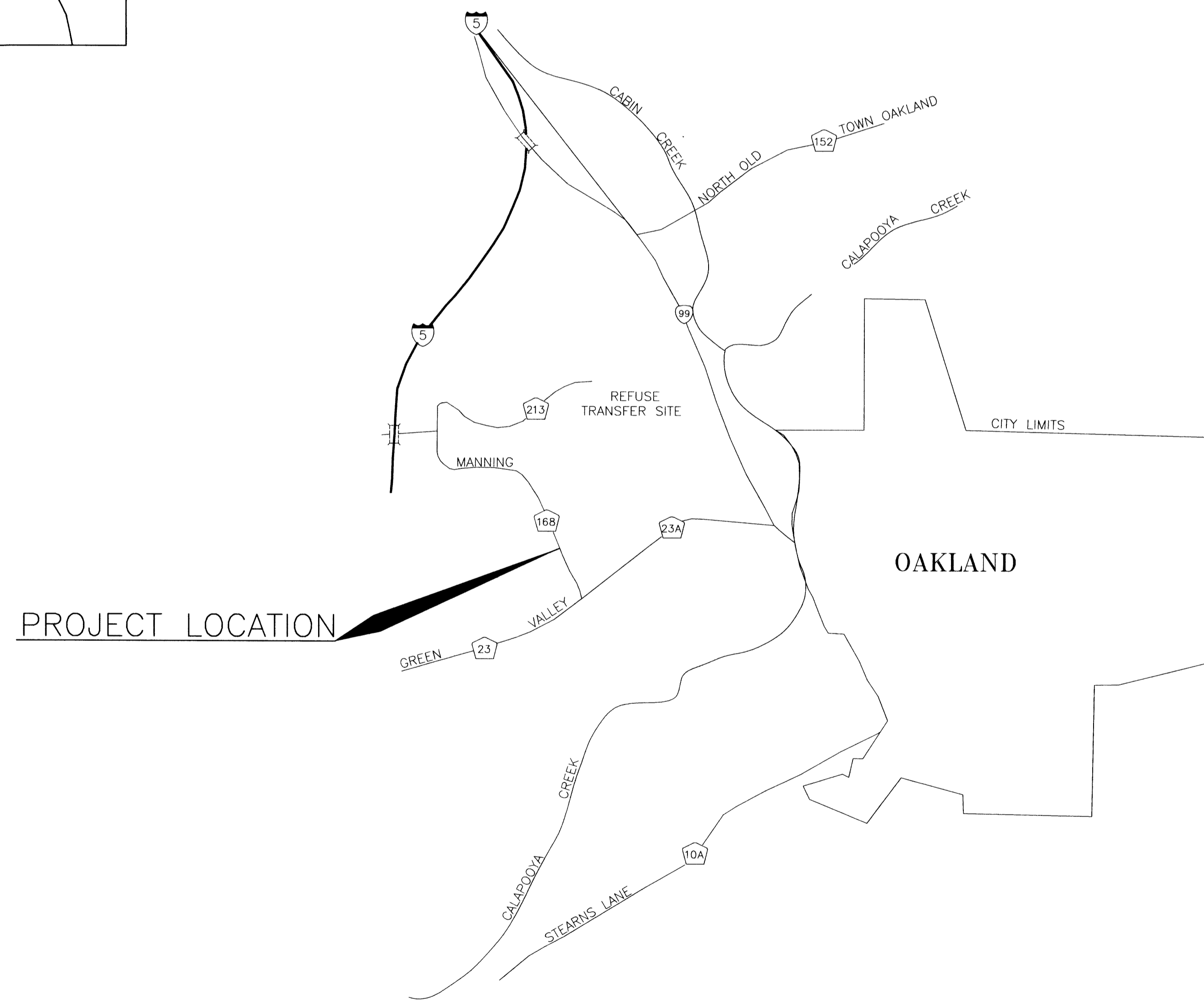

PROJECT LOCATION

LOCATION MAP

NO SCALE

FILED  
Date: 10/1/2007 By: JP  
This survey consists of: 5 Pgs  
Map: Co. Rd. 168  
Narrative:  
Corner Rpt:  
DOUGLAS COUNTY SURVEYOR

REGISTERED PROFESSIONAL LAND SURVEYOR  
*Donald G. Beecroft Jr.*  
OREGON JULY 23, 1991  
DONALD G. BEECROFT JR.  
2400  
EXPIRES 12-31-07

REVISIONS		

PROJECT NO. 10689  
DOUGLAS COUNTY  
DEPARTMENT OF PUBLIC WORKS  
RIGHT-OF-WAY PLANS  
MANNING ROAD. #168  
M. P. 0.00 TO 0.49  
ROBERT G. PAUL, PE, PLS DIRECTOR  
DATE: AUG. 2007 DRAWING NO. SHEET 1 OF 5

Co. Rd. #168 MP 0.00-0.49

RD168COV