

GENERAL SERVICES DIVISION  
 FEDERAL HOUSING ADMINISTRATION  
 CLOVERDALE ADDITION - ROSEBURG, OREGON  
 SCHEDULE P  
 ALAMEDA AVE.  
 STA. 0+00 TO 13+00

SCALE: AS NOTED	DATE: MARCH 24, 1957	SHEET	OF 9
DES. BY: DR. V.G.B.	CORNELL, HOWLAND, HAYES & MERRYFIELD	ENGINEERS	BOISE, IDAHO
CHK. BY: G.B.W./G.B.W.	BY: CK/APD	DWG. NO. C1371-3	

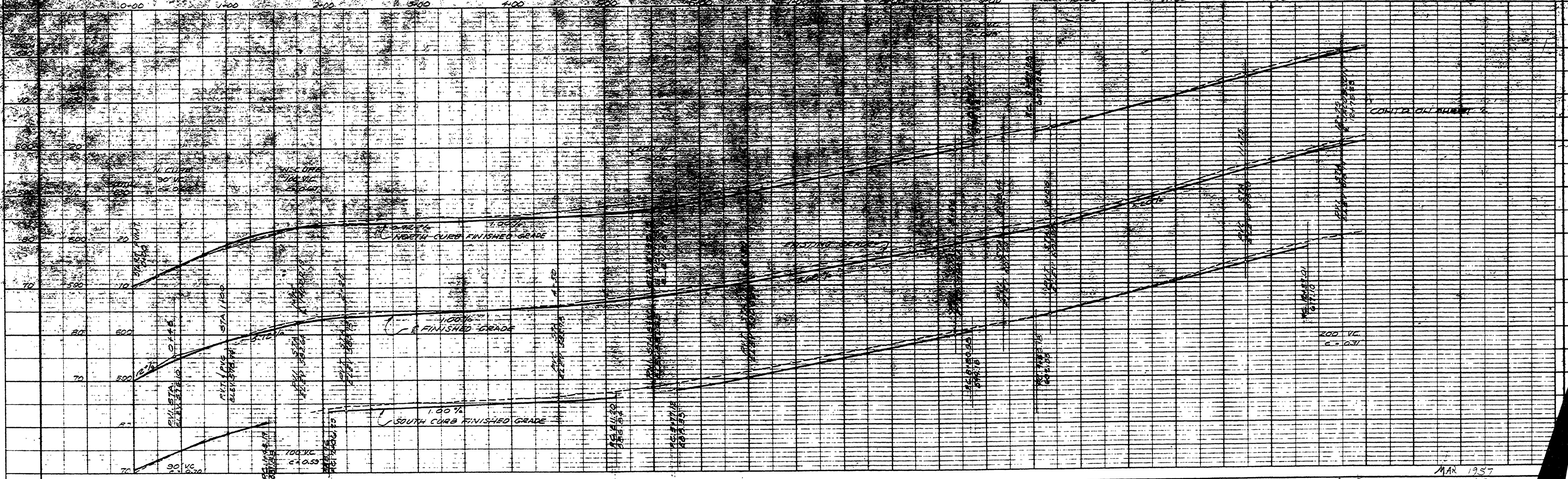
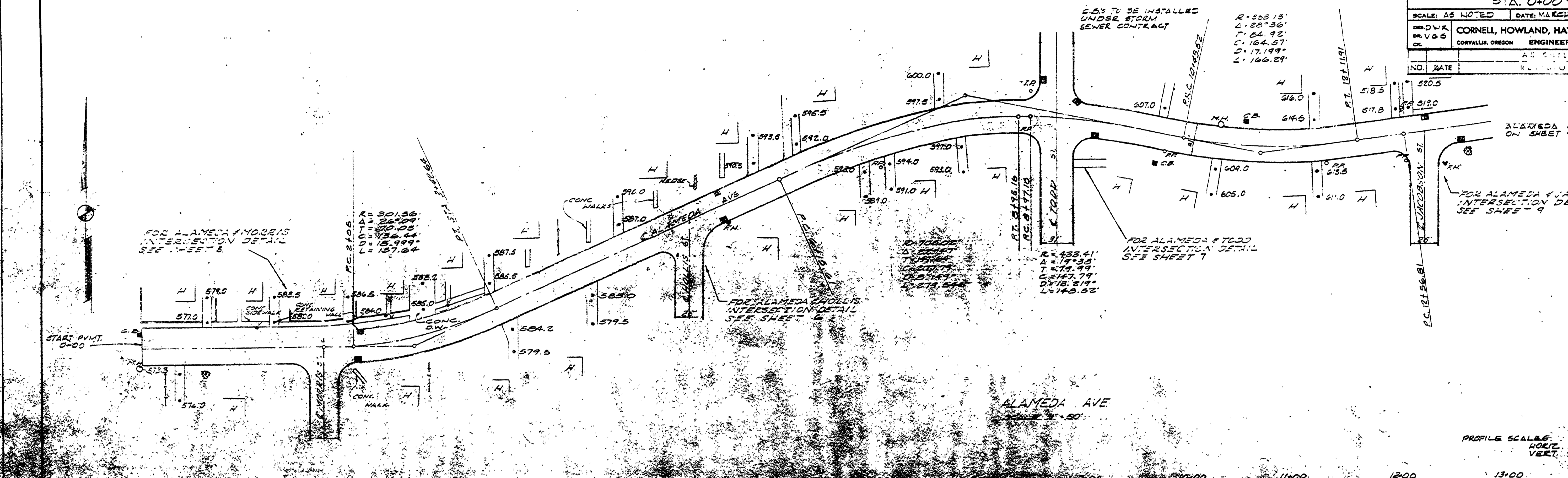

FILED  
 RECEIVED  
 COUNTY SURVEYOR  
 DOUGLAS COUNTY, ORE.

PROFILE SCALE:  
 HORIZ. 1" = 50'  
 VERT. 1" = 10'

00360090