

Shelby A. Matthews to Douglas County
 40' Right of Way St. 18+28.8 to 65+68.4
 Consideration \$500.00
 Road Record 8 Page 466
 Deed Record 92 Page 341

G.A. Lindblom to Douglas County
 St. 25+38.8 to St. 18+20
 40' Right of Way \$500.00
 Consideration \$500.00
 Road Record 8 Page 463
 Deed Record 92 Page 239

**DOUGLAS COUNTY
 HIGHWAY IMPROVEMENT
 FRANK STRADER ROAD**

SEC. 16-21, T27S, R4W.W.M.
 H. LEPPSTEIN, COUNTY SURVEYOR
 AUGUST 1928

Sheet 1.

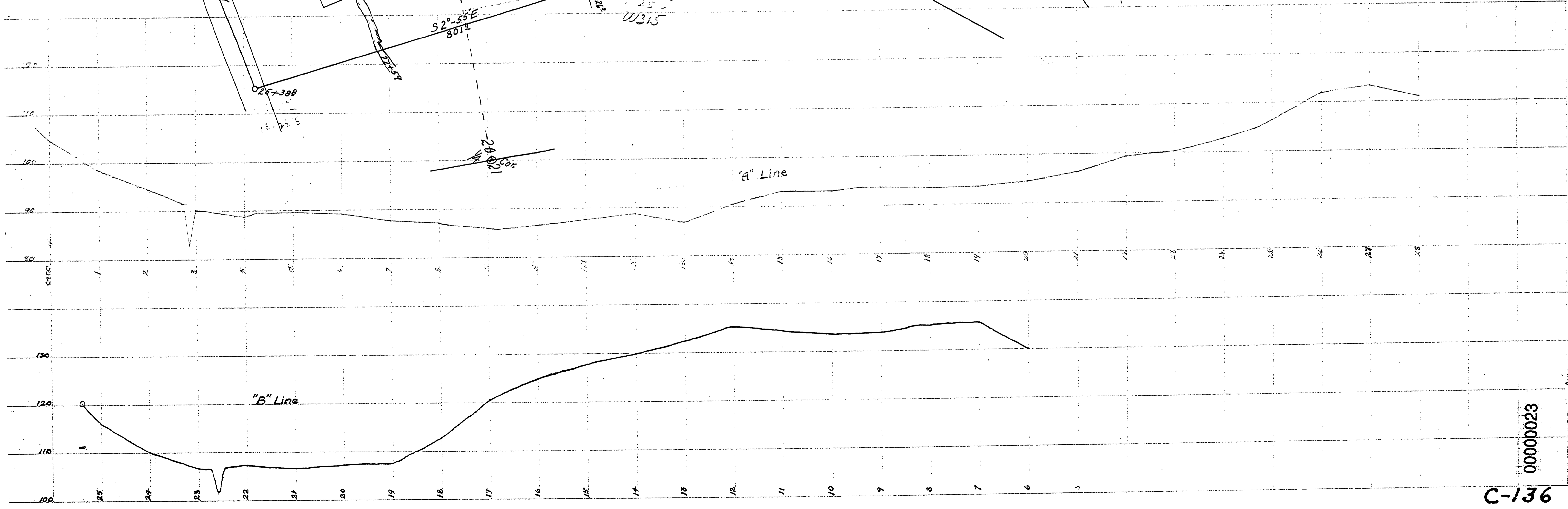

00000023
 C-136