

CHARLES G. & MARY HENDERER (Undivided 1/2 int.)
 CHARLES W. & MARCELLE E. HENDERER
 151/589
 NE 1/4 SW 1/4

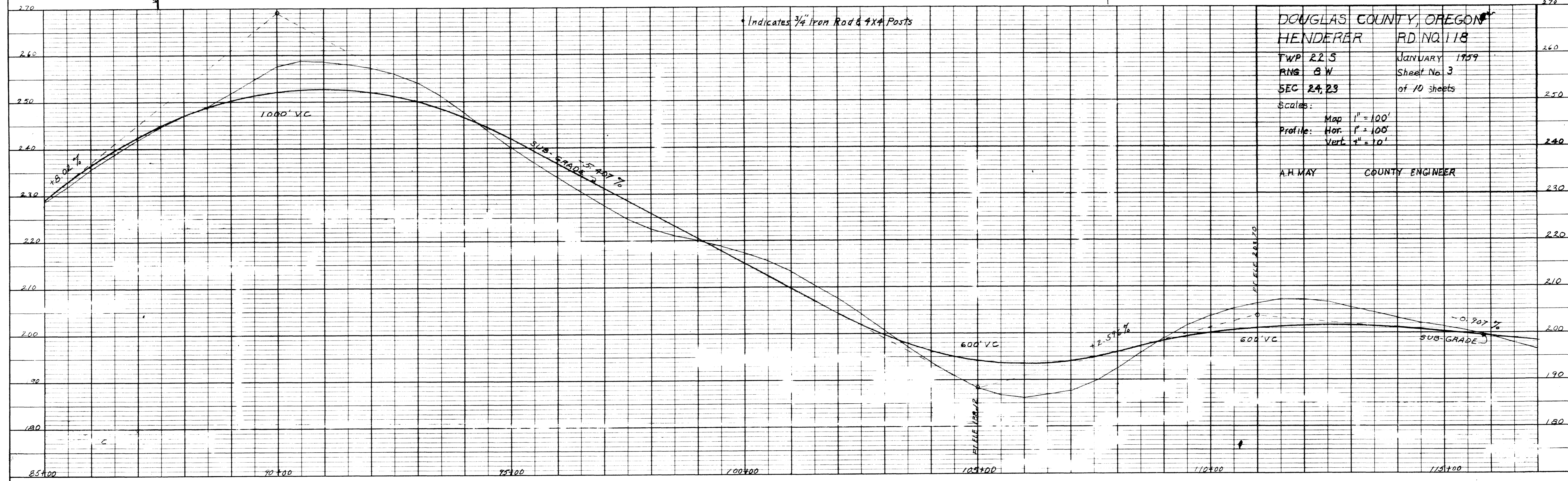

DOUGLAS COUNTY, OREGON
 HENDERER RD. NO. 118
 TWP 22 S JANUARY 1959
 RNS G W Sheet No. 3
 SEC 24, 23 of 10 sheets
 Scales: Map 1" = 100'
 Profile: Hor. 1" = 100'
 Vert. 1" = 10'
 A.H. MAY COUNTY ENGINEER

PLATE 1-PLAN PROFILE D.R. & R.E. STANBARD
 100% ACRYLIC FILM - MADE AND PRINTED IN U.S.A.
 ENGINEER DESIGNER CD