

TOWNSHIP 22S. RANGE 8 W.W.M.

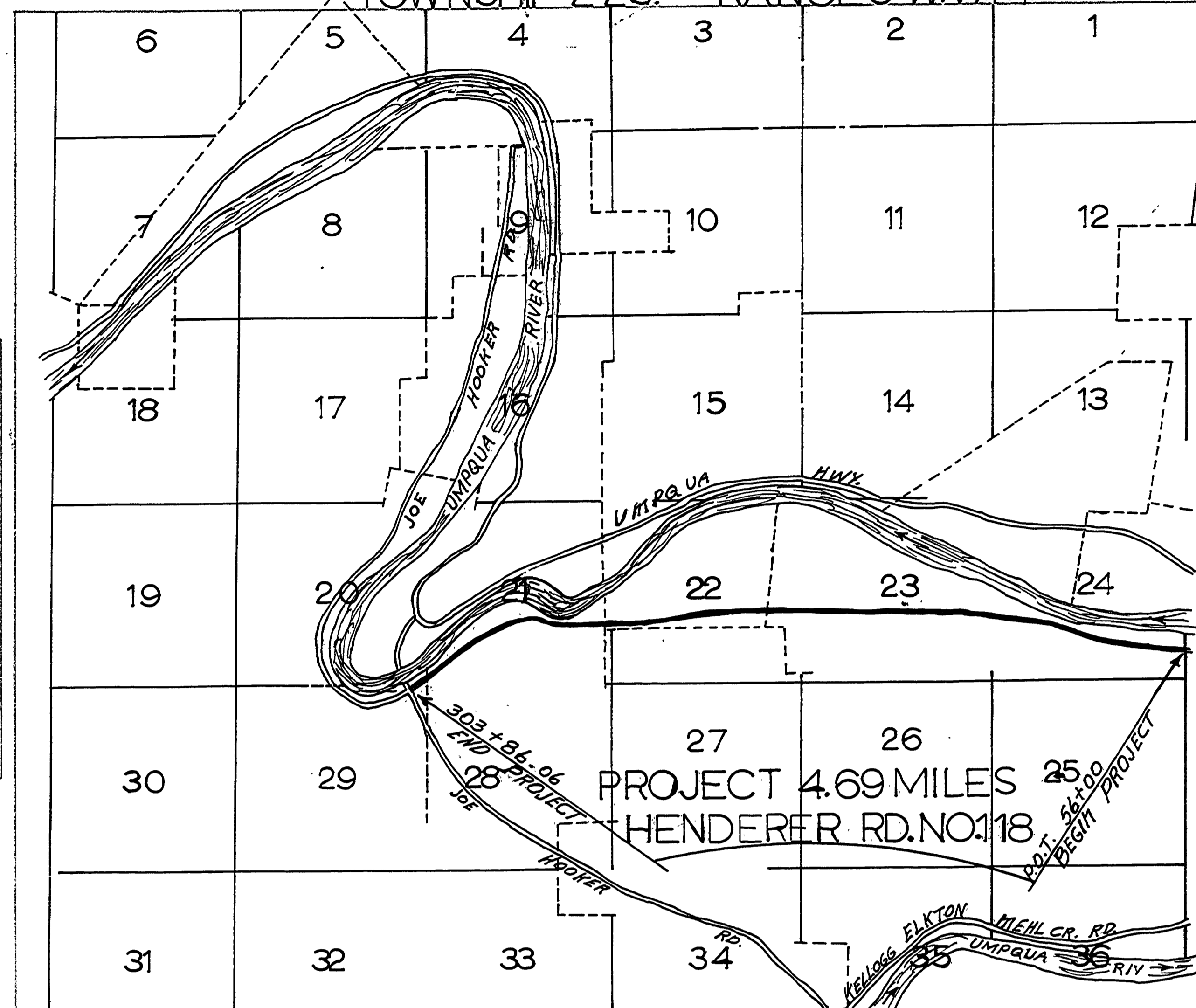

DOUGLAS COUNTY OREGON  
 PLANS FOR PROPOSED PROJECT  
 GRADING  
 HENDERER ROAD  
 COUNTY ROAD NO. 118

JAN. 1959

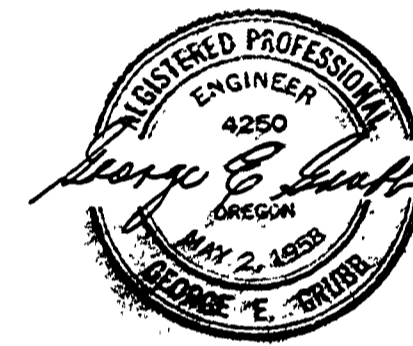

DATE	
BY	
FINAL SURVEY	SURVEYED
NOTE BOOK	PLOTTED
NO	AREAS CHECKED

DATE	
BY	
ORIGINAL SURVEY	SURVEYED
NOTE BOOK	PLOTTED
NO	AREAS CHECKED

TYPICAL SECTION

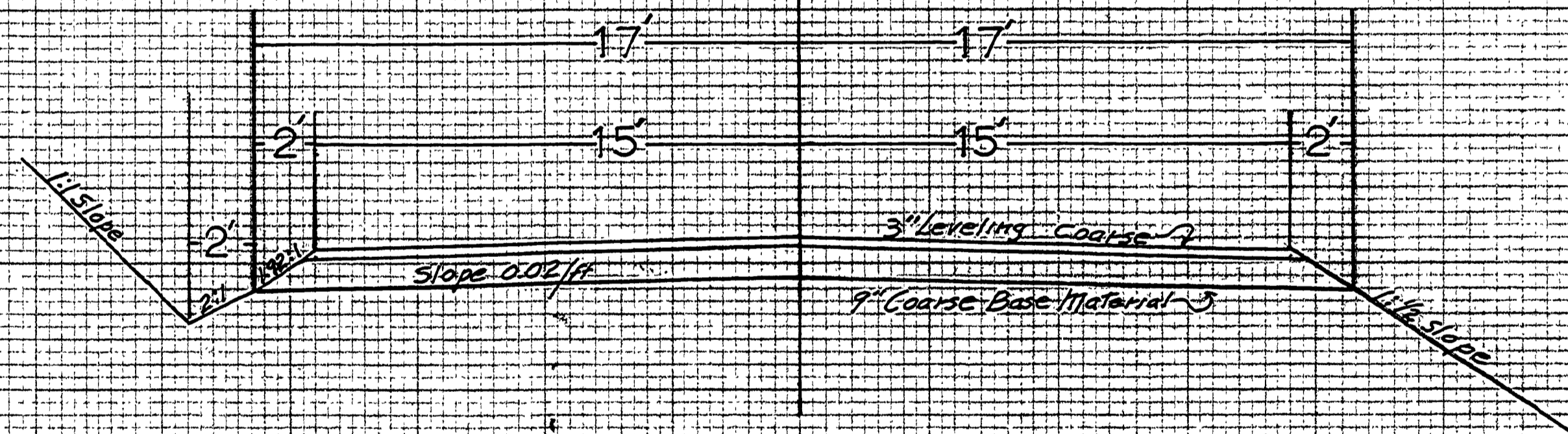

FILED  
 RECEIVED  
 FEB 11 1959  
 COUNTY SURVEYOR  
 DOUGLAS COUNTY, ORE.

PLATE 4 CROSS SECTION: S. P. R. & R. E. STANDARD  
 EUGENE DIEZGEN CO., CHICAGO, NEW YORK

101020670