

FILED
RECEIVED
FEB 19 1971
COUNTY SURVEYOR
DOUGLAS COUNTY, ORE.

DOUGLAS COUNTY OREGON

PLAN FOR PROPOSED PROJECT

GRADING & SURFACING

COUNTY RD. NO. 115A 2ND EXT.

SEPTEMBER 1966

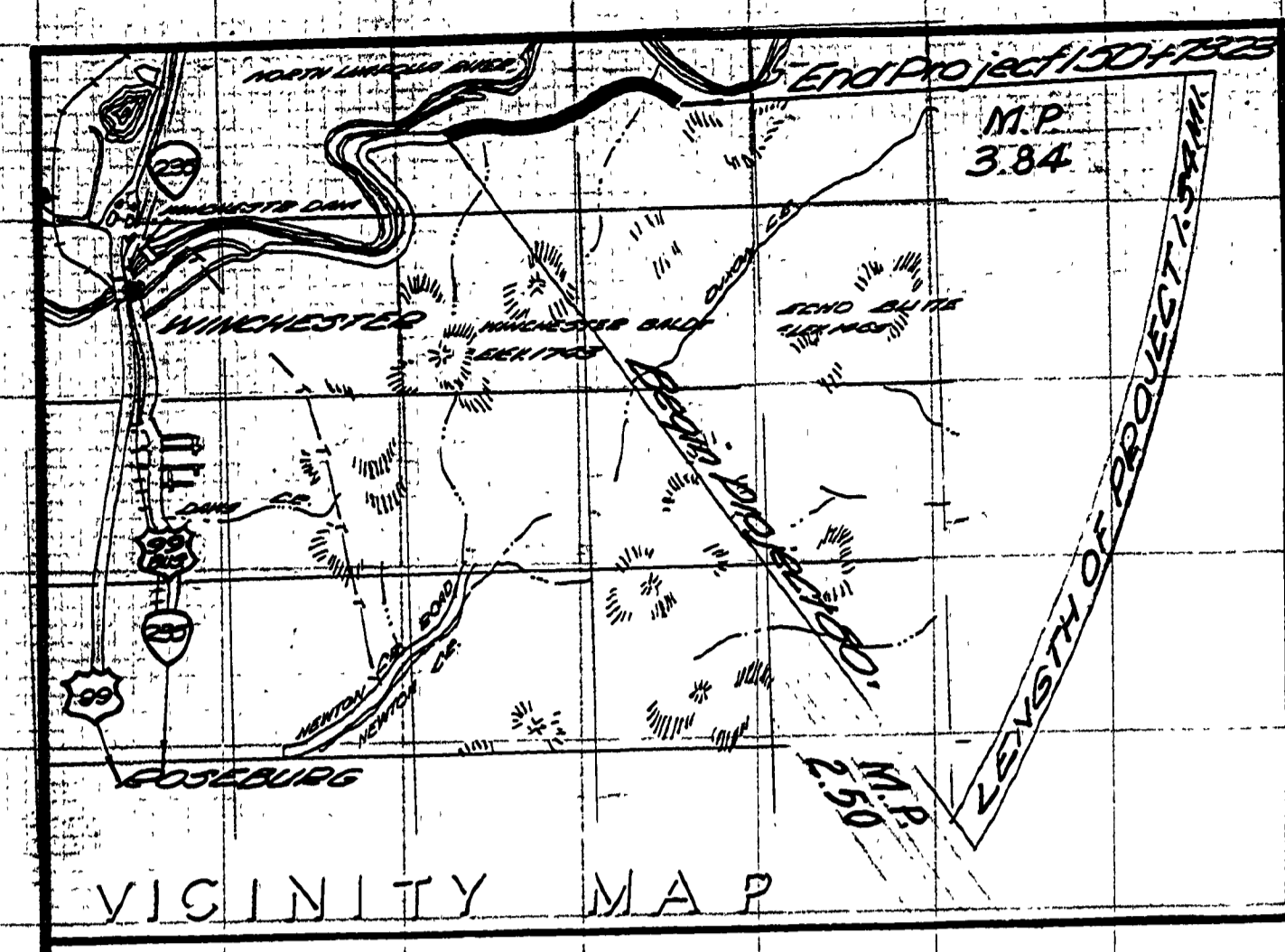

TYPICAL SECTION

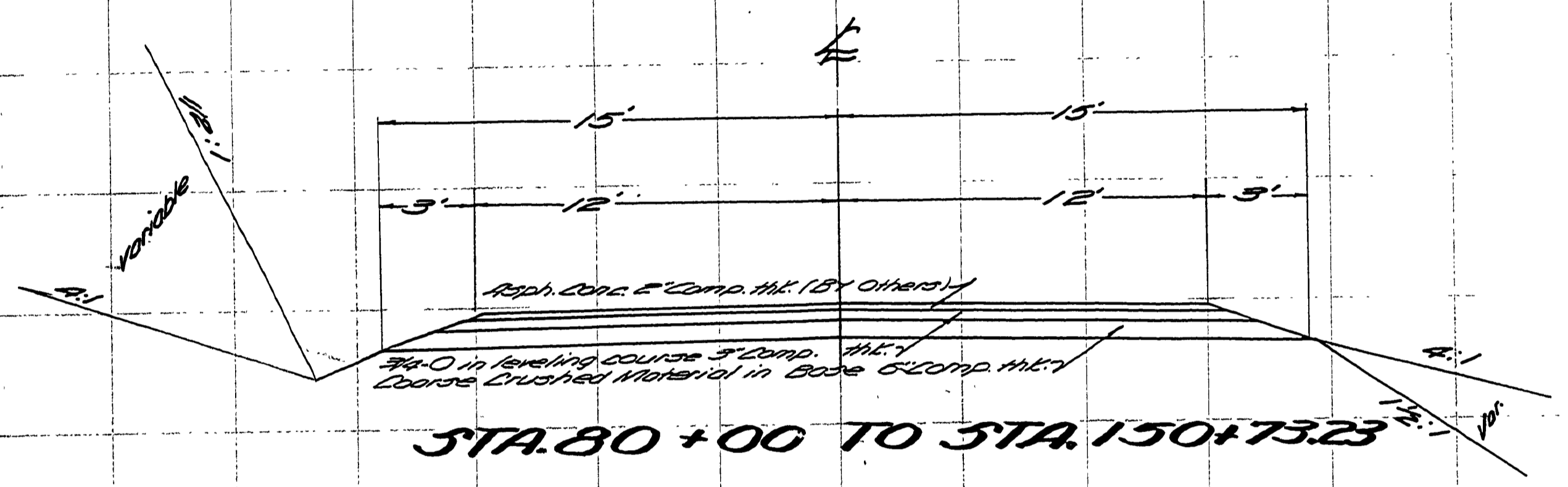

TYPICAL SECTION

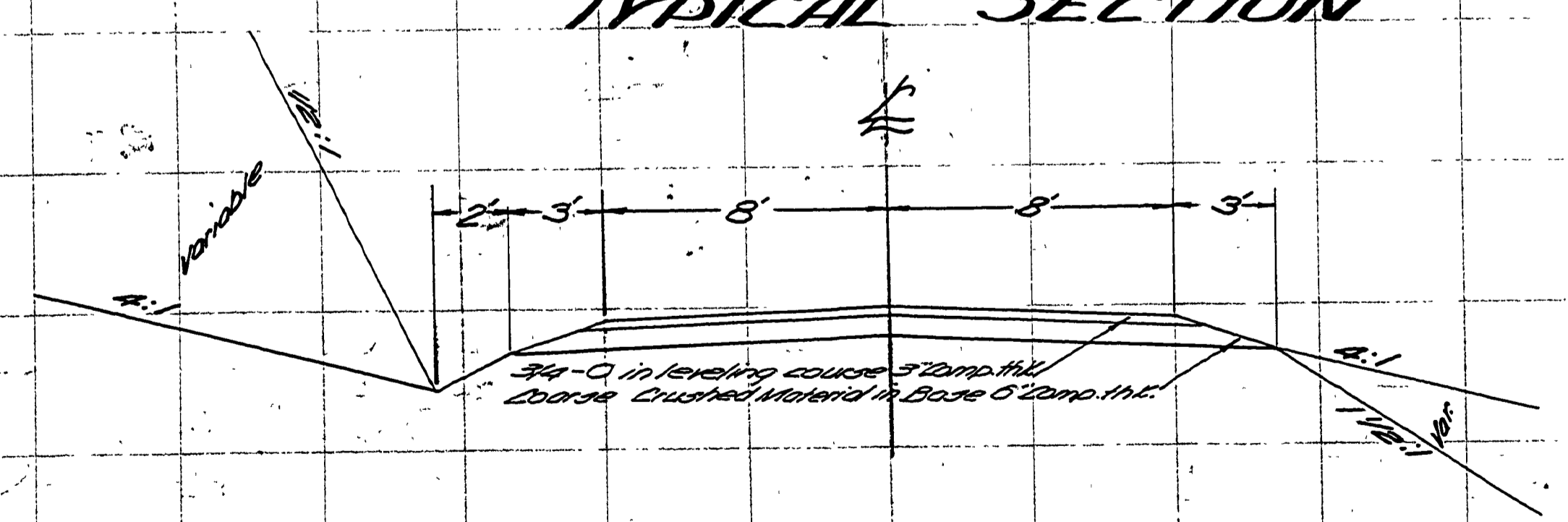

SHEET 1 OF 4

SEP. '66
C.R. # 115A 2ND EXT. (59)

02500380