

DATE	
BY	
FINAL SURVEY	
SURVEYED	
NOTE BOOK	
NO	

DATE	
BY	
ORIGINAL SURVEY	
SURVEYED	
NOTE BOOK	
NO	

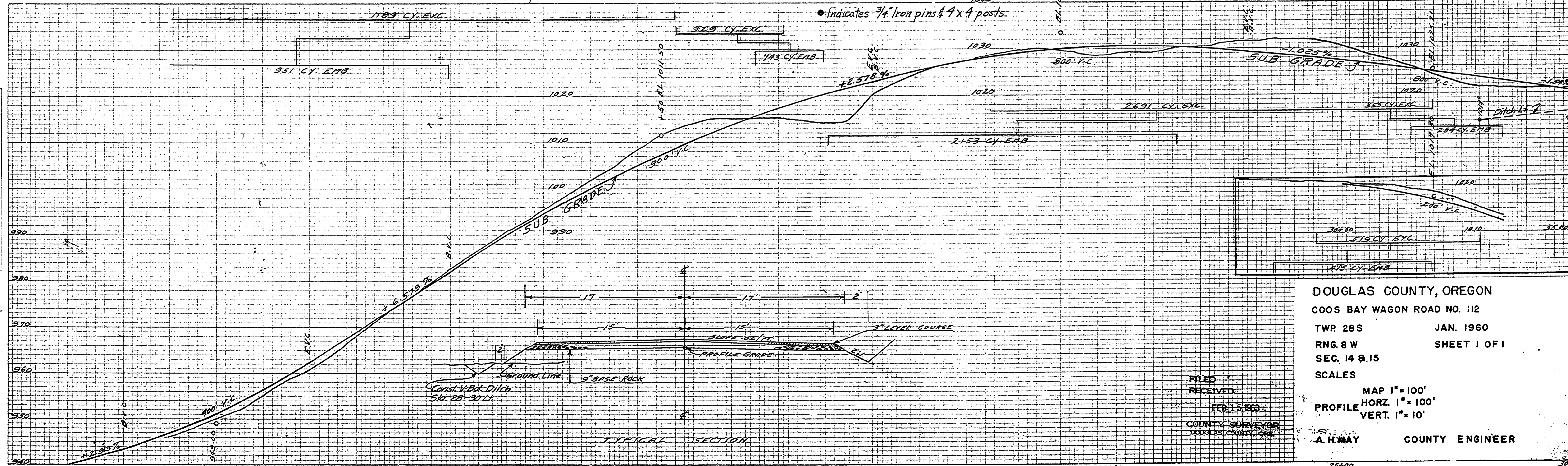

DOUGLAS COUNTY, OREGON
 COOS BAY WAGON ROAD NO. 112
 TWP. 28 S JAN. 1960
 RNG. 8 W SHEET 1 OF 1
 SEC. 14 & 15
 SCALES
 MAP 1" = 100'
 PROFILE HORIZ 1" = 100'
 VERT. 1" = 10'
 A. H. MAY COUNTY ENGINEER

FILED
 RECEIVED
 FEB 15 1960
 COUNTY SURVEYOR
 DOUGLAS COUNTY, OREG.

PLATE 4 CROSS SECTION B. P. R. & R. E. STANDARD 15'x10'
 EUGENE DETZLER CO. CHICAGO NEW YORK

M.P. 0.00 - 0.35

Card # 112

Jan '60

skt. 1 of 1

000000004