

DOUGLAS COUNTY OREGON PROPOSED PROJECT GRADING & SURFACING GREEN AVENUE CO. RD. 110

THIS PLAN CONSISTS
OF 2 SHEETS, PLUS
STANDARD DRAWING #1
FOR A TOTAL OF 3
SHEETS.

JUNE 1969



STANDARD SYMBOLS

- | | |
|-------------------------|-------------------------|
| □ Power Pole | ⊗ Water Meter |
| ○ Telephone Pole | ⊕ Fire Hydrant |
| ← Down Guy & Anchor Rod | ⊙ Manhole |
| ○ Telephone Pedestal | ● Property Corner |
| ● Gas Valve | —x—x— Fence |
| ✱ Gas Meter | —v—v— Climb Proof Fence |
| ○ Water Valve | ▬ Culvert |

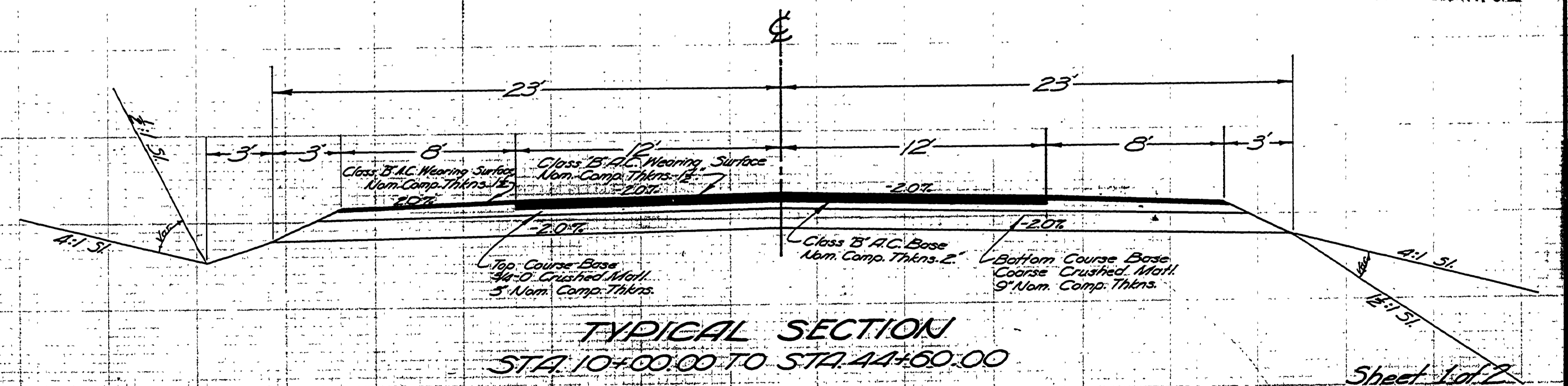
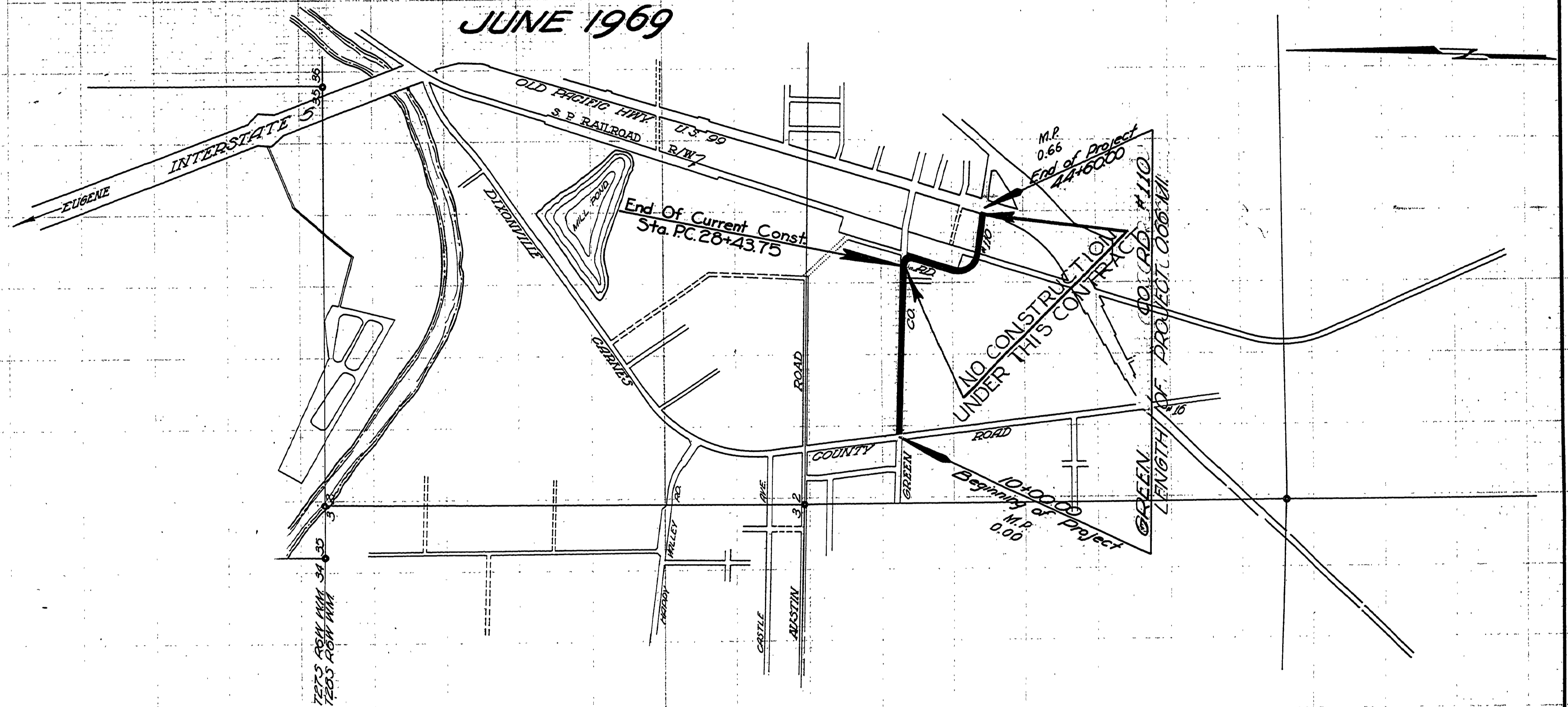

DATE
PLANNED
APR 1969
COUNTY SURVEYOR
DOUGLAS COUNTY, ORE.

Sheet 1 of 2