

# KENT CREEK ROAD

MAP AND PROFILE  
DOUGLAS COUNTY ROAD  
IN ROAD DIST. NO. 61

PETITION OF  
O.A. PARKER - VIA ALEXANDER ET AL  
LOCATED IN SECTIONS 32-5-6-7  
T28S R6W AND T29S R6W W1M.

SURVEYOR J.W. COLE  
VIEWERS R.L. STEARNS  
A.L. AIKINS

SCALE - HORIZONTAL 1" = 200'  
VERTICAL 1" = 20'  
OFFICE OF COUNTY SURVEYOR  
MARCH 26, 1923.

J.W. Cole  
COUNTY SURVEYOR

SHEET NO. 1

---DATA---

Petition of O.A. Parker, et al, filed in the County Clerk's Office, Douglas County, Mo., on the 13th day of March, 1923.  
Survey in Road District No. 61  
Survey ordered by County Court, Date 2/18/1923  
Survey by J.W. Cole  
Chainmen J.C. Richardson, J.C. Glavin, J.C. Glavin  
Viewers R.L. Stearns, A.L. Aikins  
Length of survey 16987.3 ft  
Width of Right of Way 40 ft  
Final survey ordered 5/11/1923  
Date plotted May 21 - 1923

Mile	Station	Monument	Reference	Bearing
1	0+00	Iron Pipe	2 1/2" W. Oak	S 25° E 70.9 ft
	6+69		Iron Pin	S 64° W 59.4 ft
	6+89		12" W. Oak	N 58° E 44.9 ft
1	20+40		6" W. Oak	S 32° E 51.0 ft
	32+18		10" Fir	N 43° 30' W 42.8 ft
			30" Maple	S 84° 20' W 44.5 ft
			12" W. Oak	S 59° 15' W 45.6 ft
			8" W. Oak	N 44° W 41.7 ft
1	35+80		32" W. Oak	N 42° 30' W 75.0 ft
			24" W. Oak	S 74° E 57.5 ft
1	41+43.2		20" Fir	N 43° 20' W 41.4 ft
			18" Maple	N 76° E 43.0 ft
1	46+77		10" Cedar	N 48° 10' W 27.1 ft
			10" Fir	S 59° 10' E 19.8 ft
1	52+80		22" Fir	N 27° 16' W 29.5 ft
			14" Maple	S 89° W 37.8 ft
2	60+95.6		9" Fir	N 15° 30' W 25.3 ft
			10" Fir	S 48° E 20.7 ft

SOLAR OBS 10:00 AM 3/3/23  
Set at Sta 27+93.4 F.S. 25+96.2 Def L. To Sun 45° 36'  
Measured Alt 32° 06' Magnetic Course S 37° 30' E  
Lat. of base line N 45° 30'  
Correction for 28 TmPs (52.12' x 28) 2' 26"  
Lat of Observation 43° 05'  
Measured Alt. 32° 06'  
Correction for 2 hours 0' 01"  
True Alt. 32° 05'  
Dec. of Sun, Greenwich Noon 7° 06.2'  
Corr for 6 hrs 0.57'  
Dec. at time of Observation 7° 00.5'

Q = Tan Lat. x Tan Alt. - (Sin Dec. x Sec Lat x Sec Alt.)  
33224 x .61689 - (77216 x .3692 x 1.1202 - 78369)  
Time 10:00 AM March 3 1923

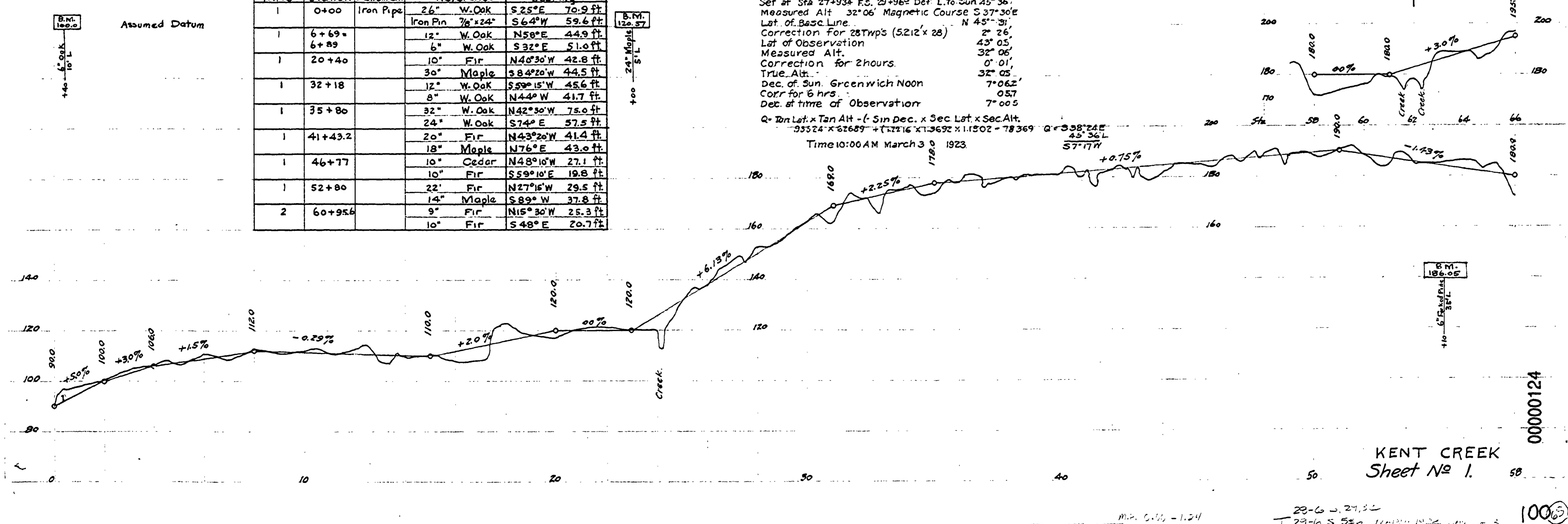

KENT CREEK  
Sheet No. 1

30 X

