

30 X

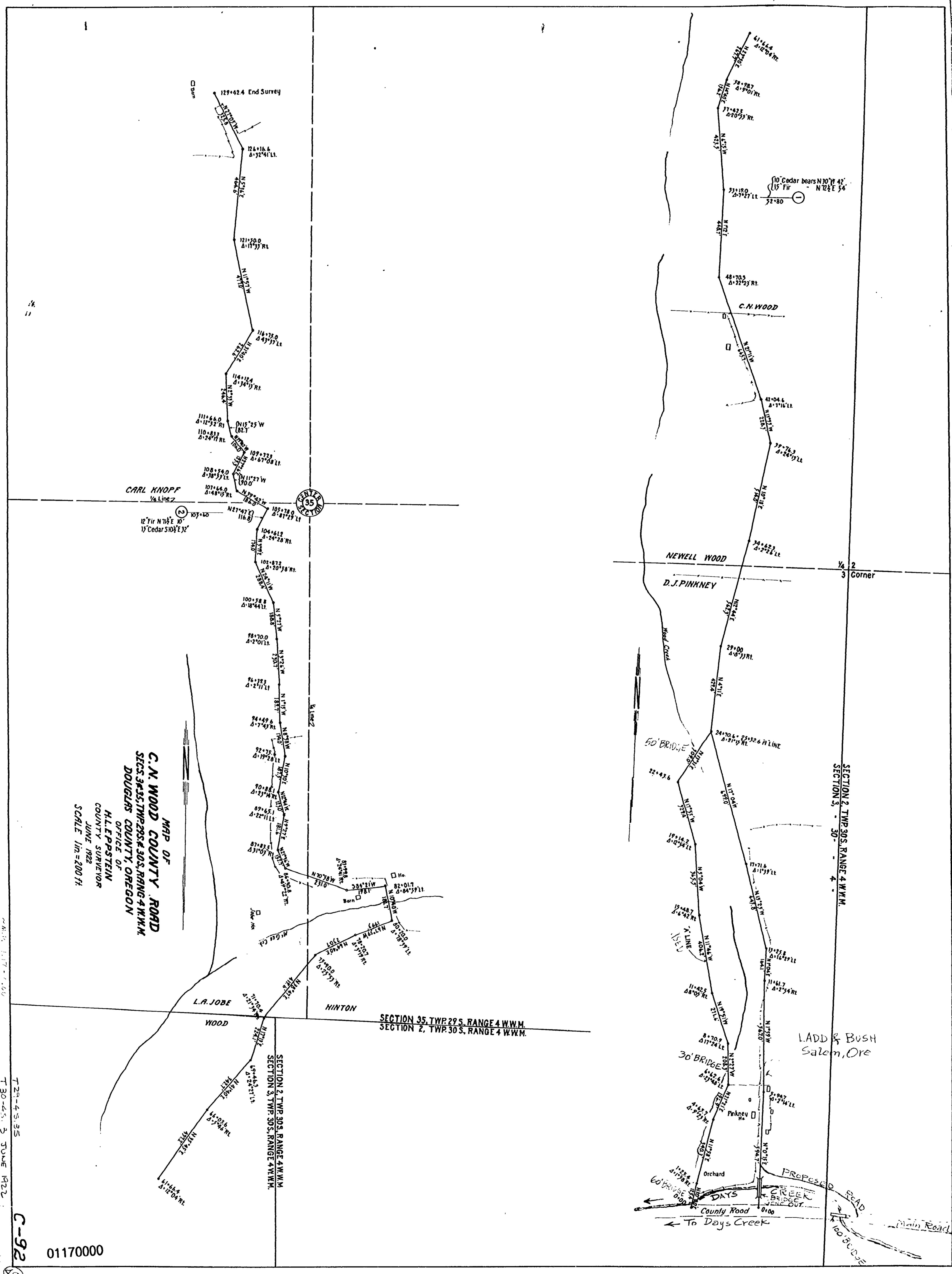
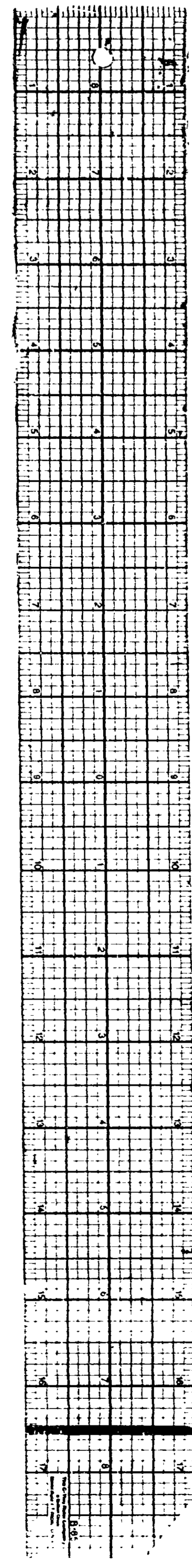

M.P. OF
C.N. WOOD COUNTY ROAD
SECS. 34-35, TWP. 29 S. & 30 S., RANGE 4 W.M.M.
DOUGLAS COUNTY, OREGON
OFFICE OF
H.L. EPSTEIN
COUNTY SURVEYOR
JUNE 1922
SCALE 1 in. = 200 FT.

01170000

T29-4-S-35
T30-4-S-3
June 1922
C-92