

WINCHESTER BAY

FILED
RECEIVED
AUG 6 1955
COUNTY SURVEYOR
DOUGLAS COUNTY, ORE.

ORDER dated 7-5-55
Court Jnl. 21 p. 657
EXTENSION OF CO. RD. 87A
ADOPTED BY RESOLUTION
OF THE COUNTY COURT
SHOWN IN RED 1955

- (s) C.C. Hill
COUNTY JUDGE
- (s) E.R. Metzger
COUNTY COMM.
- (s) Frank Ashley
COUNTY COMM.

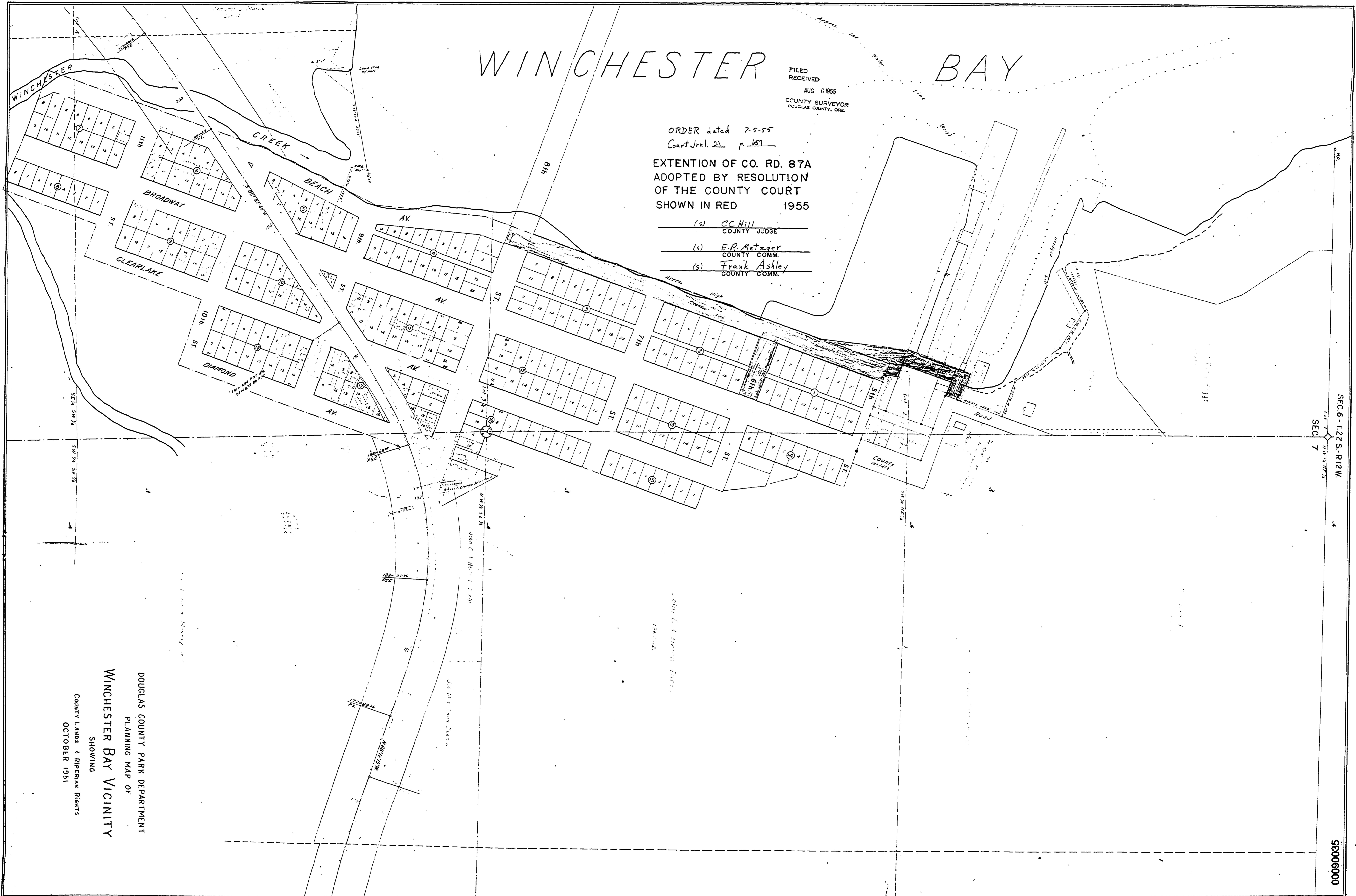

DOUGLAS COUNTY PARK DEPARTMENT
PLANNING MAP OF
WINCHESTER BAY VICINITY
SHOWING
COUNTY LANDS & RIPELAND RIGHTS
OCTOBER 1951

SEC. 6 - T22 S. R12W
SEC. 7

56008000

ROAD 87A
T22-12 SEC. 7
1955

30 X