

DOUGLAS COUNTY, OREGON  
 PLANS FOR PROPOSED PROJECT  
 GRADING & SURFACING  
**CAVITT CREEK ROAD NO. 82A**  
 MILE POINT 0.00 TO MILE POINT 0.57  
**1971**

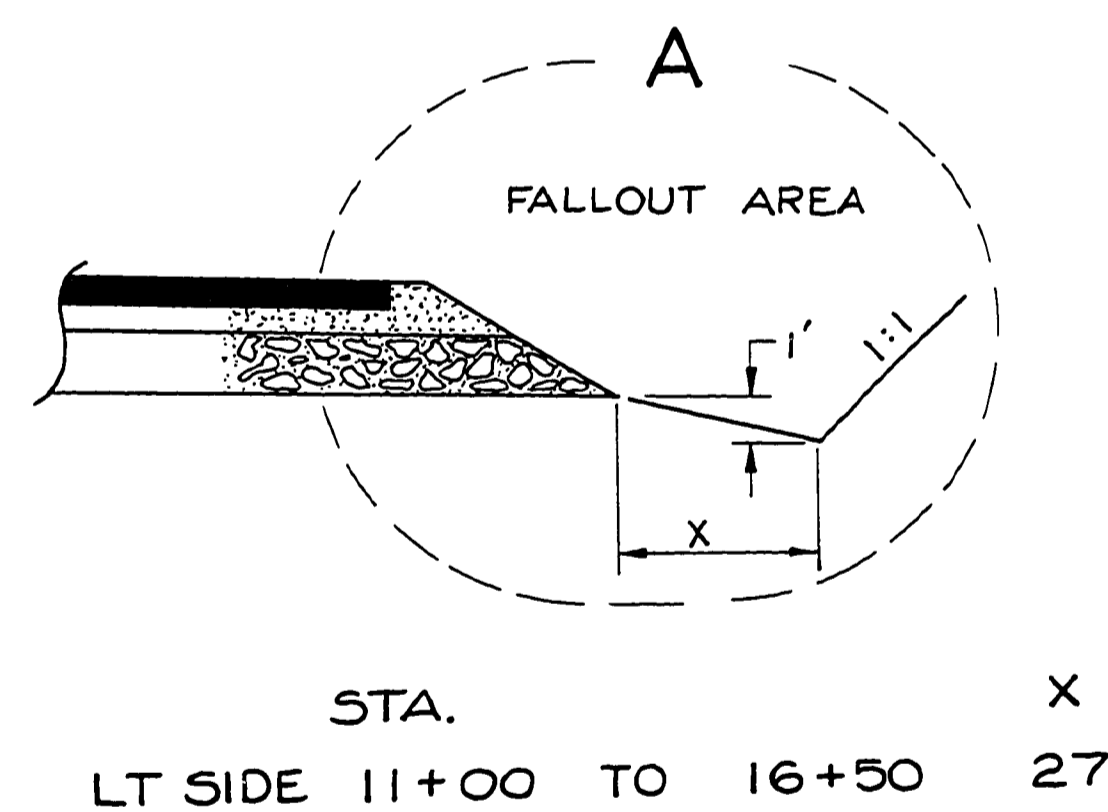
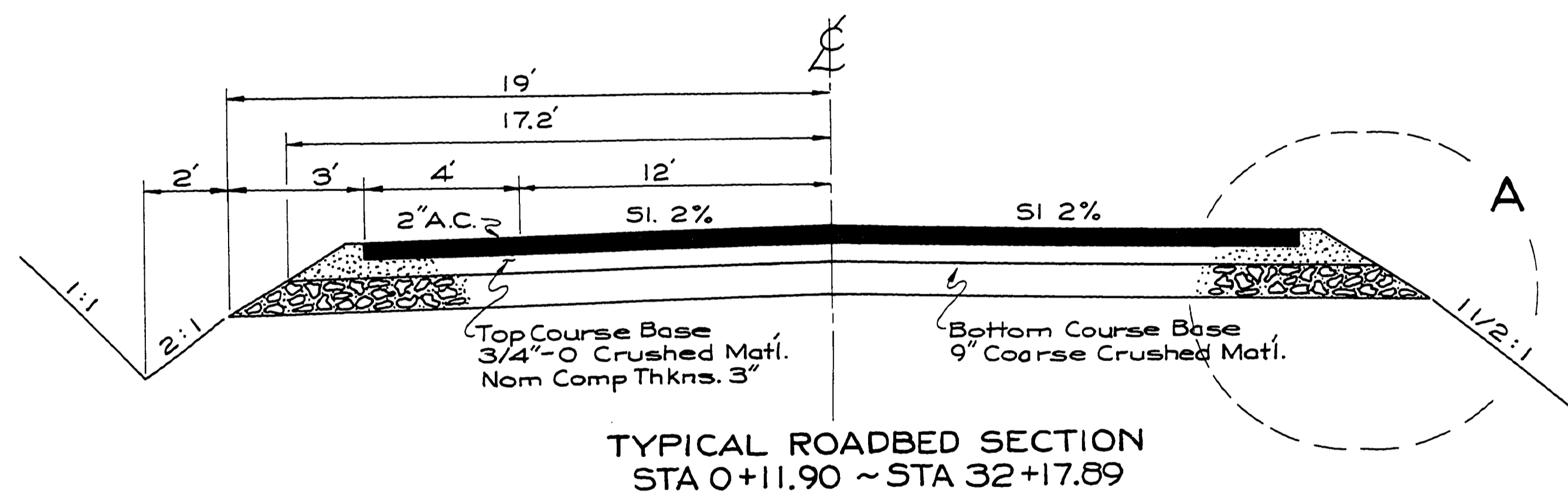
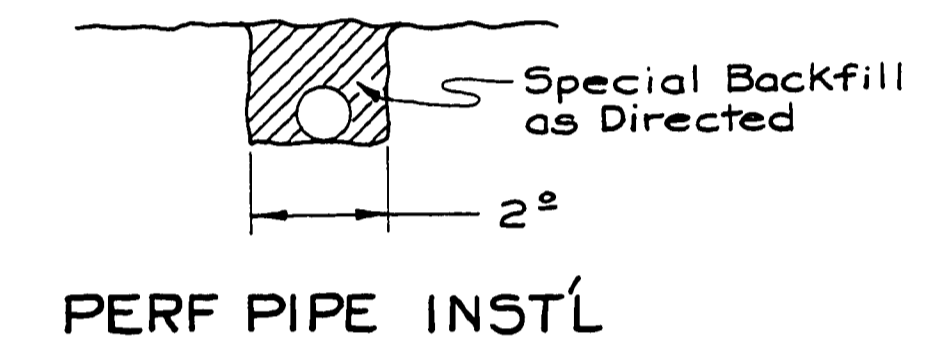
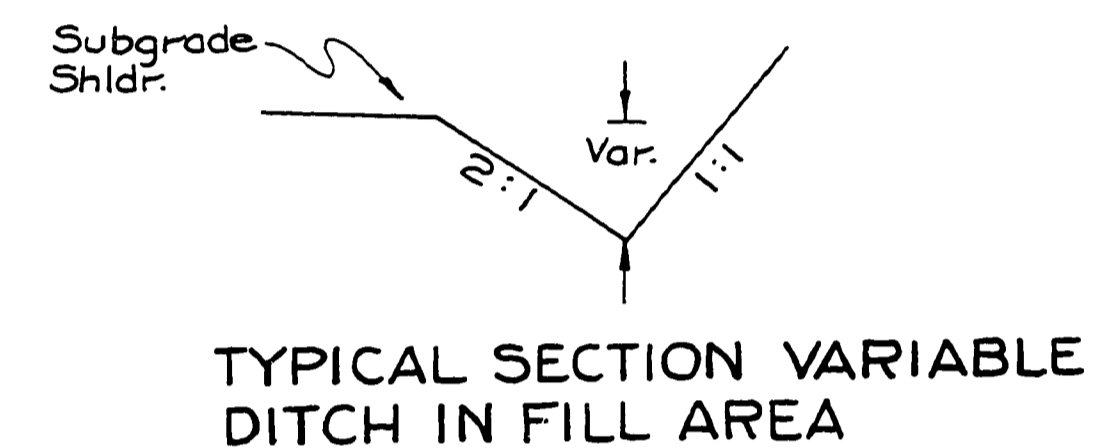
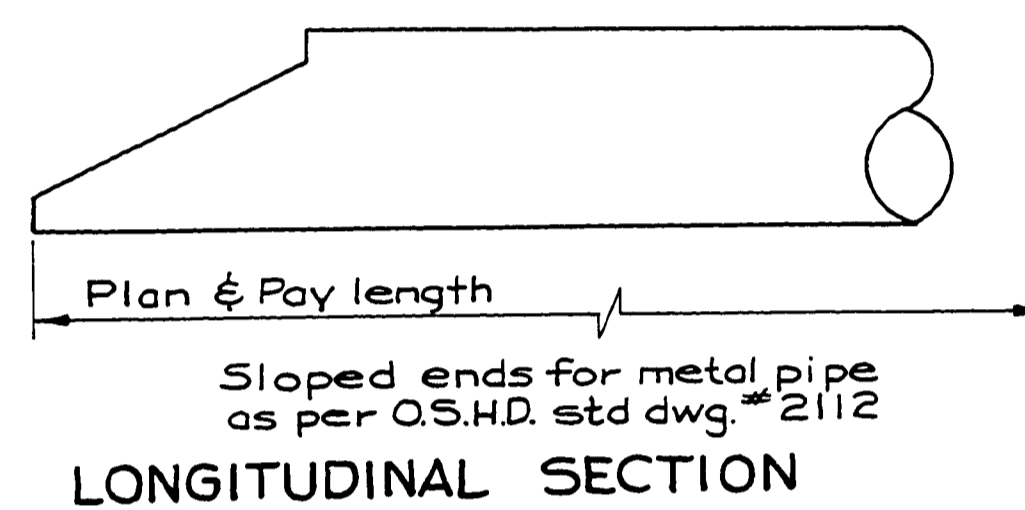
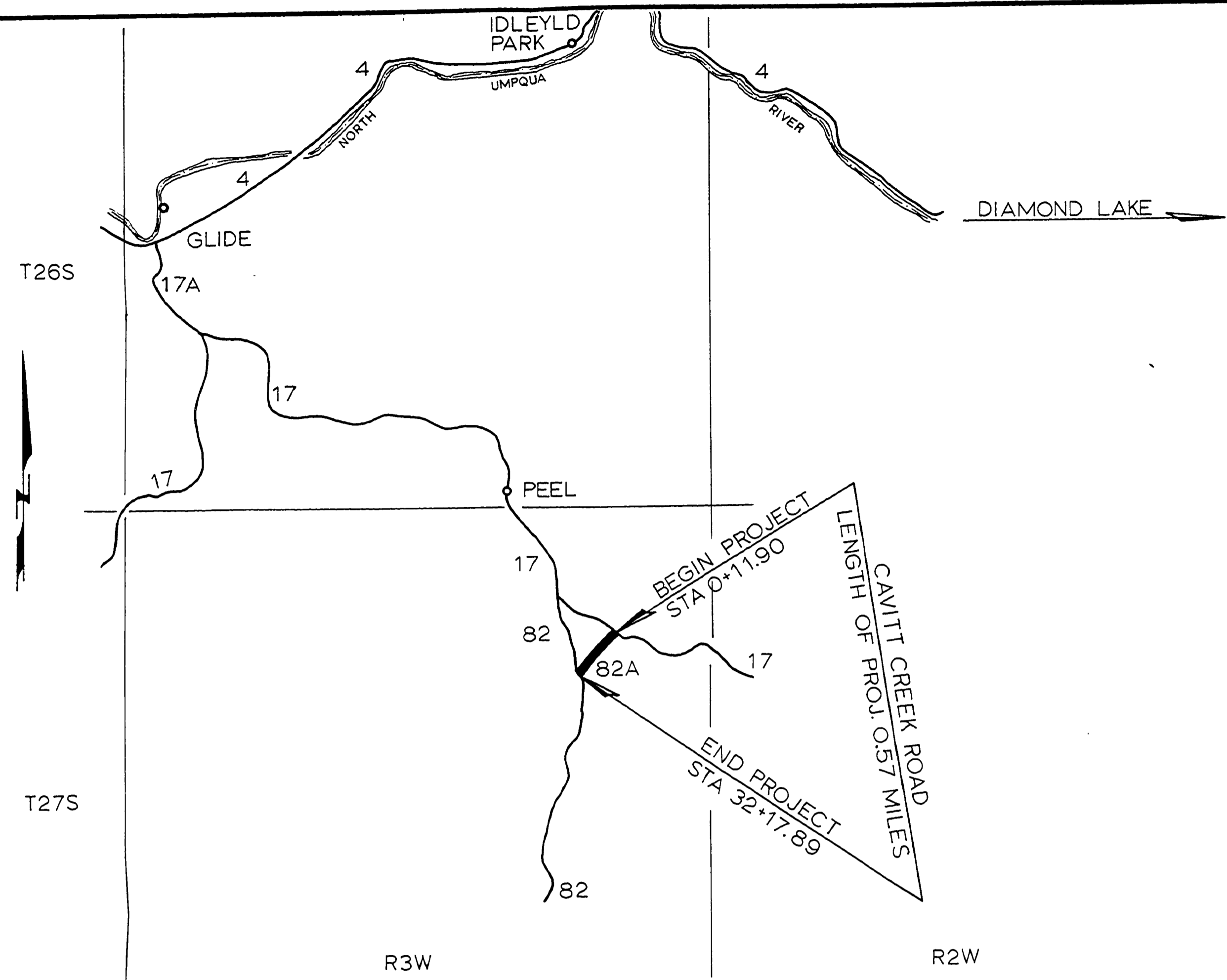

INDEX OF DRAWINGS

SHEET NUMBER	TITLE SHEET &
1	TYPICAL SECTIONS
2	QUANTITY SUMMARY
3	PIPE LIST
4	ROAD PLAN

STANDARD DRAWINGS  
 #9 (SYMBOLS)

TOTAL OF 5 SHEETS

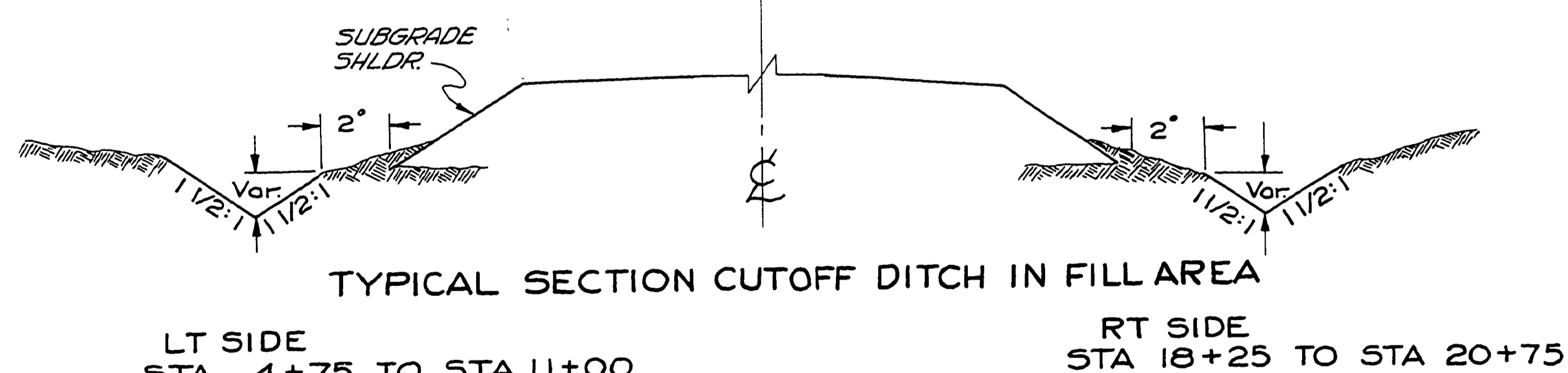

LT SIDE

STA 4+75 TO STA 11+00	
17+25 "	20+75
23+75 "	26+25
27+75 "	30+25

RT SIDE

STA 18+25 TO STA 20+75	
------------------------	--

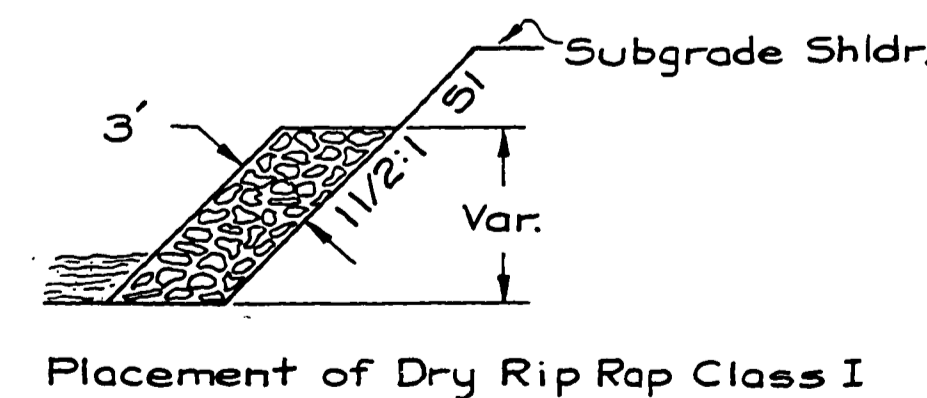

DOUGLAS COUNTY ROAD DEPT.  
**CAVITT CREEK RD #82A**  
 1971 SH. 1  
 GEORGE E. GRUBB COUNTY ENG.

0000005C