

TOWNSHIP 21 S. RANGE 11 W.W.M.

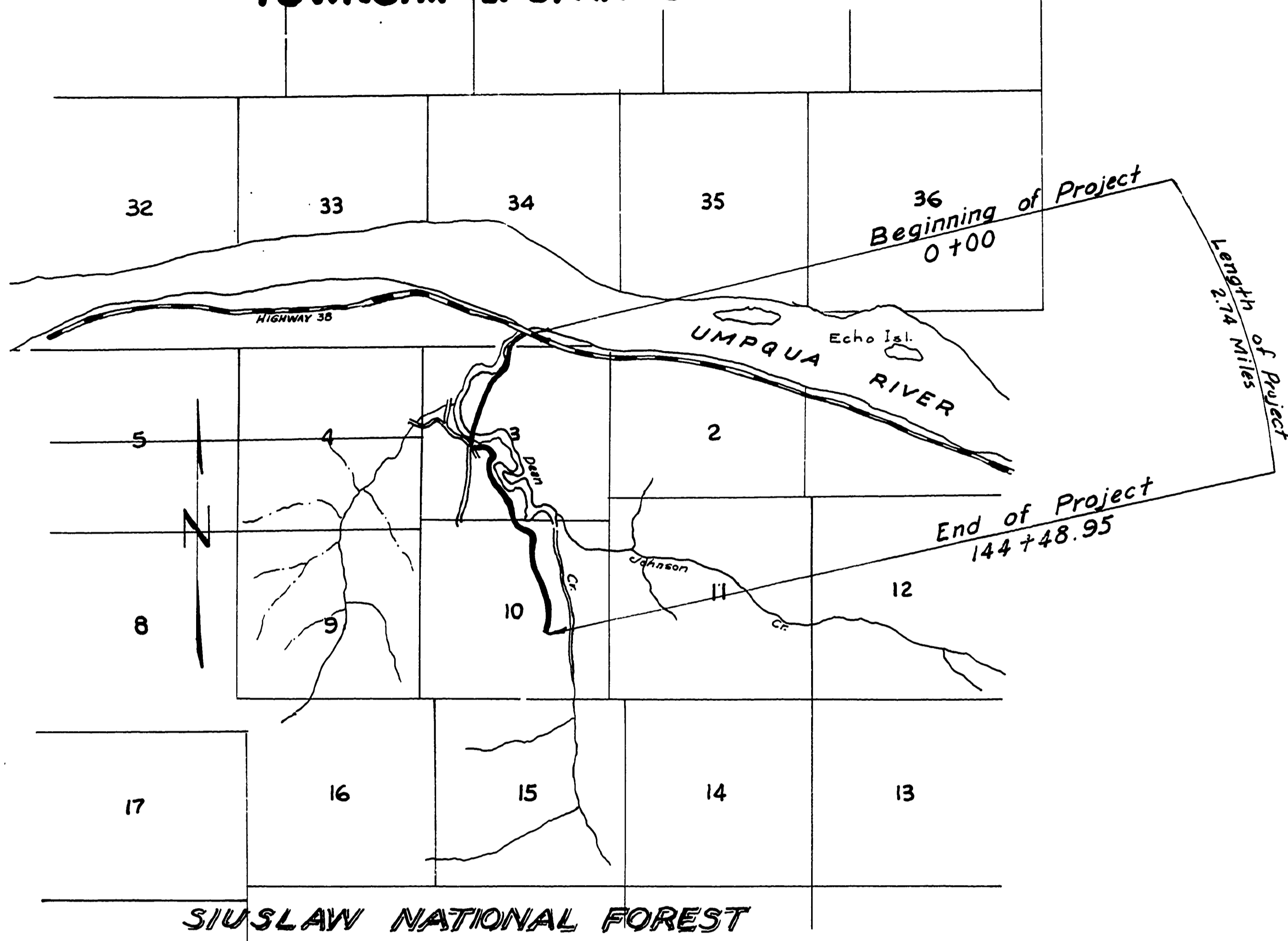

DOUGLAS COUNTY, OREGON
PLANS FOR CONSTRUCTED PROJECT
GRADING SURFACING
DEANS CREEK
COUNTY ROAD NO. 64
SEPTEMBER 1958

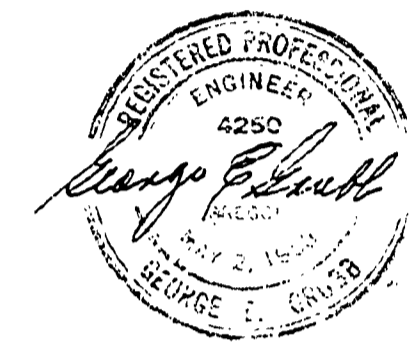

TYPICAL SECTIONS

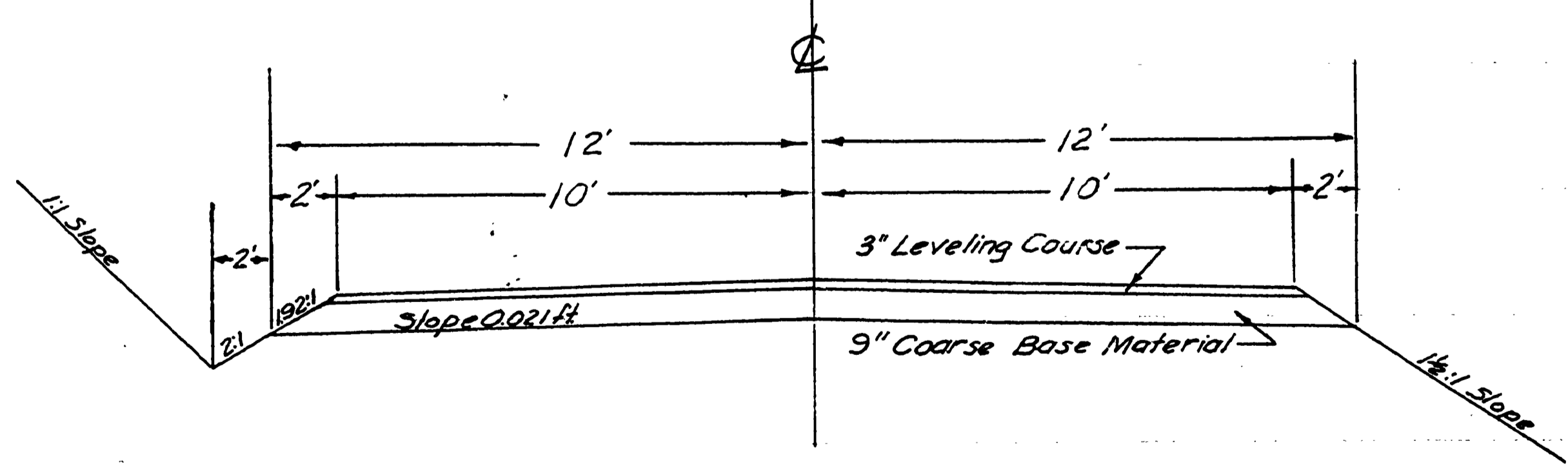

0000027C