

Clara M & Max R. Burkhart
 Qualified to West Side of Road
 Box 400 Sunshine Road, Roseburg, Ore.

Claude H. Short
 Qualified to East Side of Road
 Box 350 Sunshine Road, Roseburg, Ore.

● Indicate 3/4\"/>

FILED
 RECEIVED
 COUNTY SURVEYOR
 ROSEBURG, ORE.

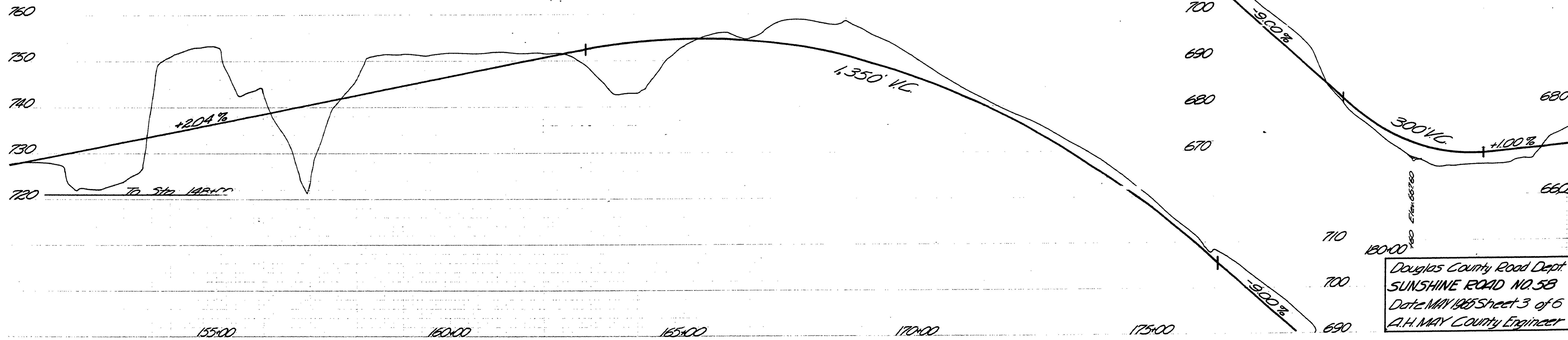

Douglas County Road Dept.
 SUNSHINE ROAD NO. 5B
 Date MAY 1965 Sheet 3 of 6
 A.H. MAY County Engineer

Max 1965
 G. Rd # 5B sht. 3 of 6 (8*)

M.P. 3.03-3.57

03030357