

SEC 25 T 27 S R 6 W W M

FILED  
RECEIVED  
JUN 21 1975  
COUNTY SURVEYOR  
DOUGLAS COUNTY, ORE.

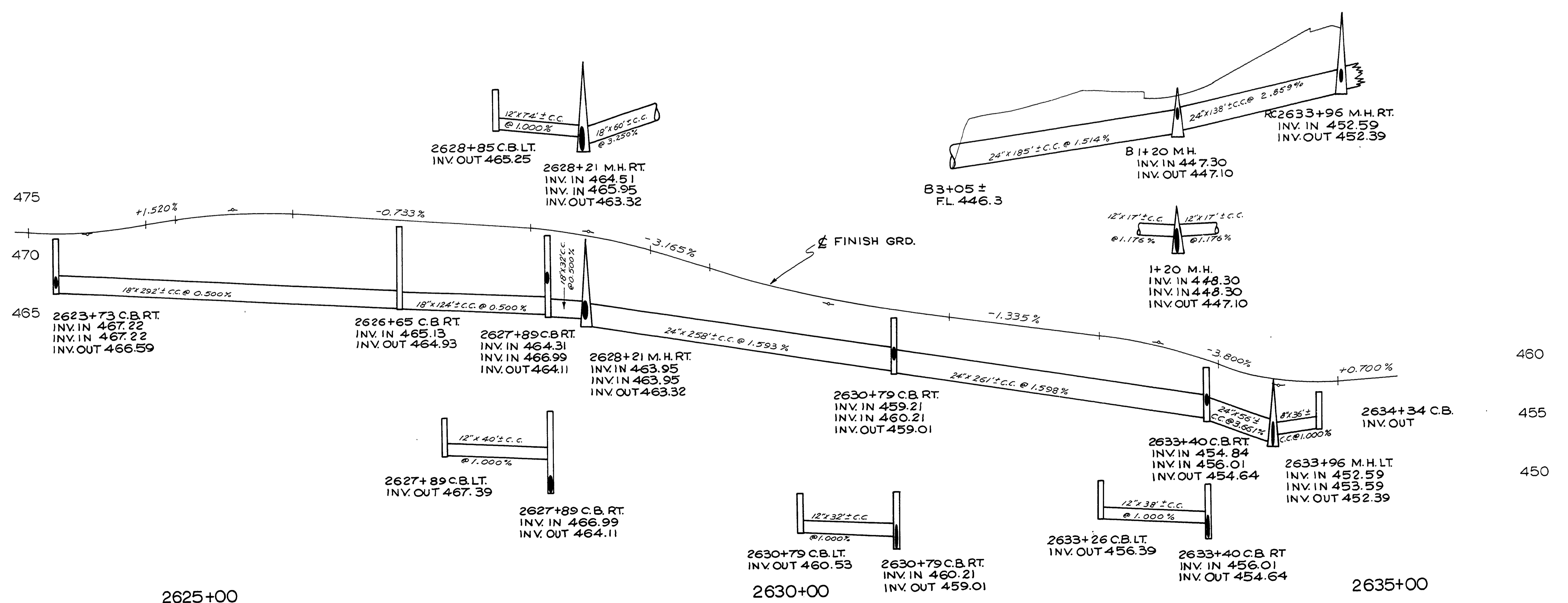
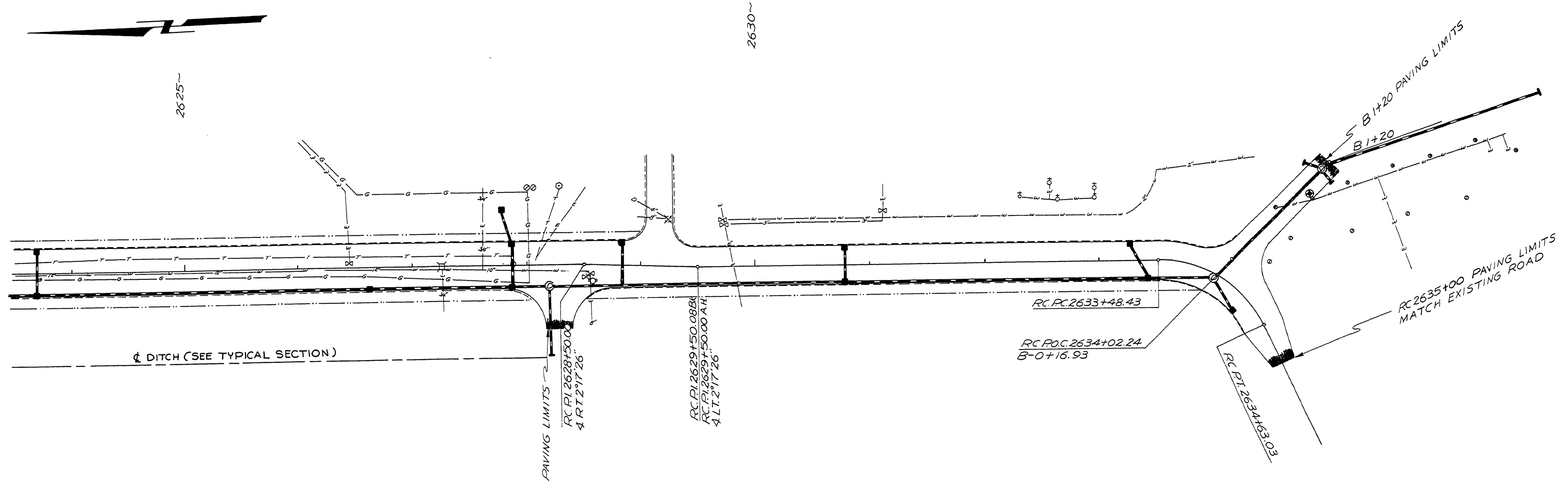

2625+00

2630+00

2635+00

M.P. 0.25-0.42

AS BUILT 6-19-78 P.W.F.  
DOUGLAS COUNTY  
PUBLIC WORKS DEPARTMENT  
FREAR STREET  
STORM DRAIN  
GEORGE E. GRUBB, DIRECTOR  
1977  
C. Rd. # 56 Sta. 10 of 15

0025004S

10/15