

NARRATIVE:
 Purpose of this survey was to acquire and monument additional road right-of-way. Existing right-of-way was determined from the centerline of the existing Scholfield County Road No. 55. Existing right-of-way width determined from Road Record Book 12, Page 18, 1954 Road Plans, and Deed Record Book 269, Page 761.

Bearings shown herein are based on the Oregon State Plane Coordinate System, south zone, NAD 27 using the following control stations: Douglas County Surveyor's Stations SC-13 and SC-14. Distances and stations shown herein are horizontal Grid factor used between Oregon State Plane Coordinate System and horizontal is 0.99992459, which includes scale and sea level factors.

- LEGEND:
- FOUND 5/8" IRON ROD
 - ⊙ FOUND BRASS CAP
 - SET 5/8" IRON ROD W/ALUMINUM CAP STAMPED "DOUGLAS CO RD DPT R-W"

FILED
 Date: 8-19-96 By: [Signature]
 This survey consists of:
 Map: CO. RD #55
 Narrative:
 Corner Rpt:
 DOUGLAS COUNTY SURVEYOR

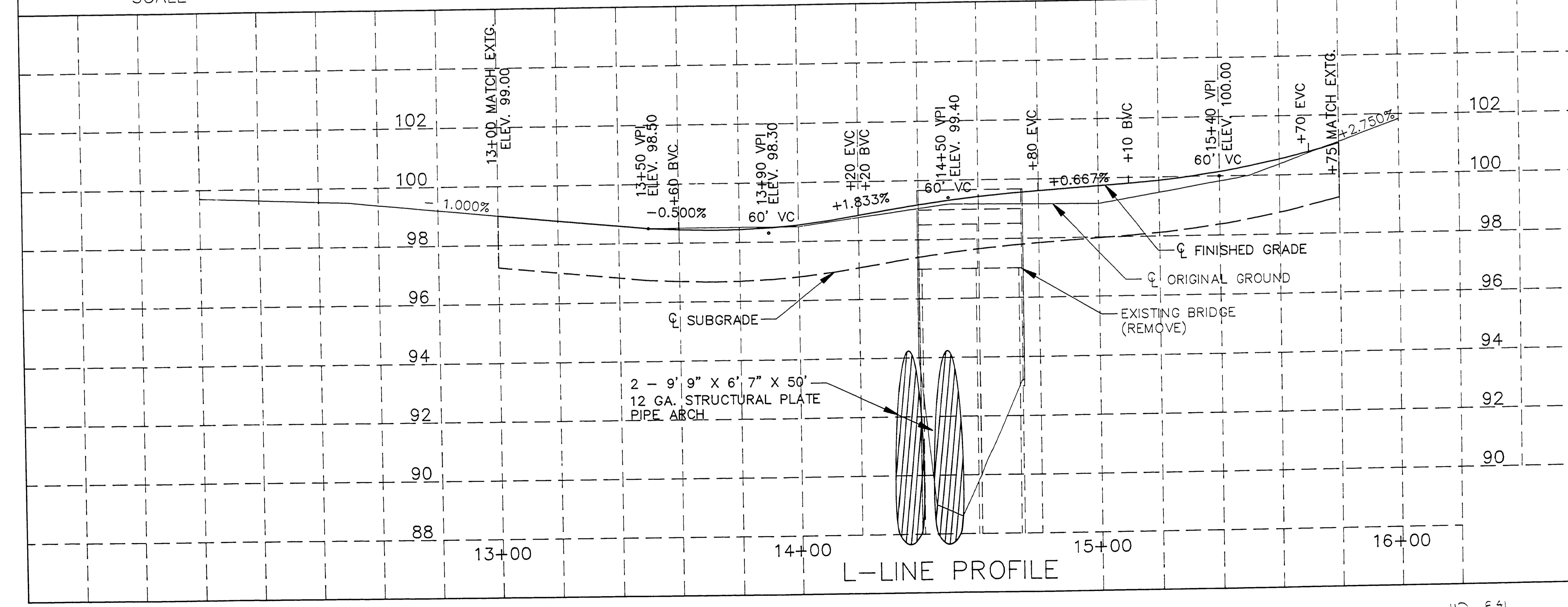

REGISTERED PROFESSIONAL LAND SURVEYOR
 Donald B. Beecroft Jr.
 OREGON JULY 25, 1991
 DONALD G. BEECROFT JR.
 2499
 EXPIRES 12-31-1997

NOTES Constructed 1995		DOUGLAS COUNTY DEPARTMENT OF PUBLIC WORKS BLACKS CREEK (MILLARD) BR. #19C371 SCHOLFIELD ROAD #55 AT M.P. 8.41 RIGHT-OF-WAY PLAN	
DESIGN: AMB	DRAWN: AMB	CHECKED: DLA	DIRECTOR: JIM ERWIN
DATE: AUG 1996	SCALE: AS SHOWN	SHEET 1 OF 1	

CO. RD. # 55

00000841

42 E 41