

Rd. 53  
By Resolution 1940  
Docket 710  
60' R/W

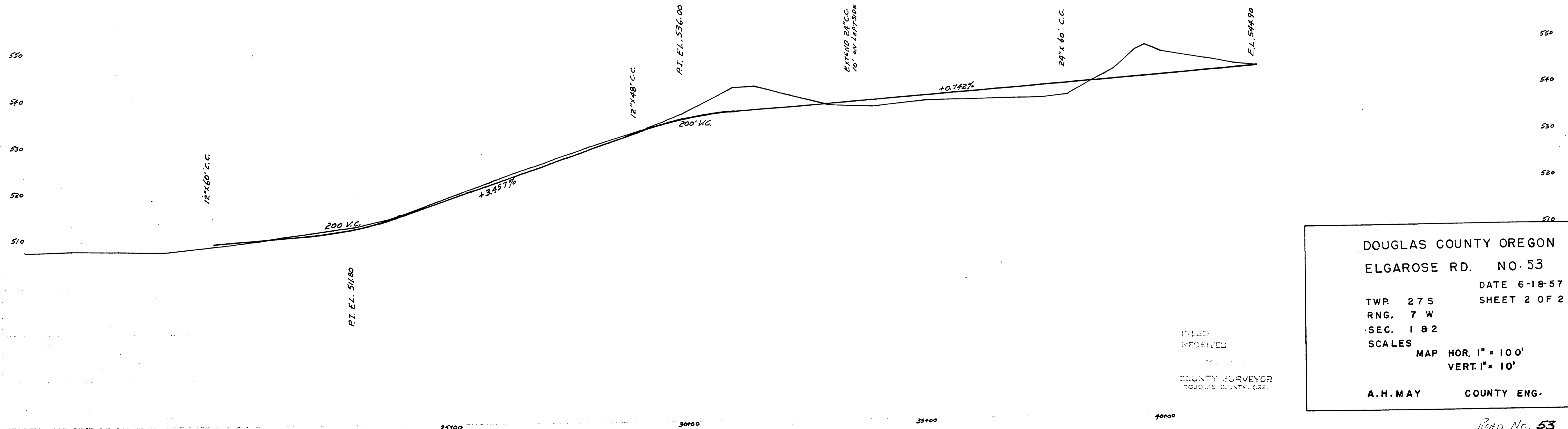

Lloyd A. Wilson  
237/236  
Alot of Lot 40

Note: Grades as shown  
Are Subgrades



DOUGLAS COUNTY OREGON  
ELGAROSE RD. NO. 53  
DATE 6-18-57  
TWP. 27 S SHEET 2 OF 2  
RNG. 7 W  
SEC. 1 8 2  
SCALES MAP HOR. 1" = 100'  
VERT. 1" = 10'  
A.H. MAY COUNTY ENG.

00390077

Rd. No. 53  
SHEET 2 OF 2

M.P. 0.39 - 0.77

