

• INDICATES 3/4" IRON ROD & 4X4 POSTS

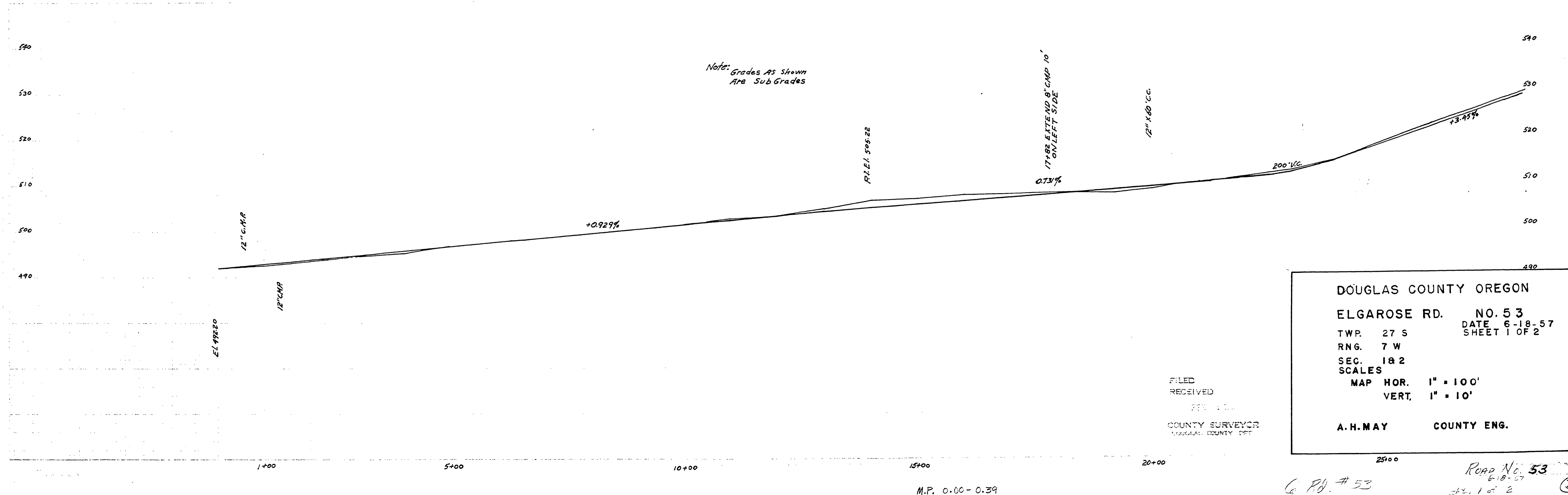

Note: Grades AS Shown Are Sub Grades



DOUGLAS COUNTY OREGON
 ELGAROSE RD. NO. 53
 TWP. 27 S DATE 6-18-57
 RING. 7 W SHEET 1 OF 2
 SEC. 18 2
 SCALES
 MAP HOR. 1" = 100'
 VERT. 1" = 10'
 A. H. MAY COUNTY ENG.

FILED
 RECEIVED
 COUNTY SURVEYOR
 DOUGLAS COUNTY OREGON

ROAD NO. 53
 6-18-57
 SHEET 1 OF 2

00000039