

**DOUGLAS COUNTY HIGHWAY IMPROVEMENT**  
**PROFILE AND ALIGNMENT**  
**CRITESER ROAD**  
**SHEET No 1**  
 SECTIONS 12 & 13, TYP 27S., RANGE 7 W.W.M.  
 STA. 0+00 TO STA. 52+86.7  
 OFFICE OF  
**F. C. FREAR**  
 COUNTY ROADMASTER  
 AUGUST 1922  
 SCALE: Hor. 1 in. = 100 ft. VERTICAL 1 in. = 10 ft.

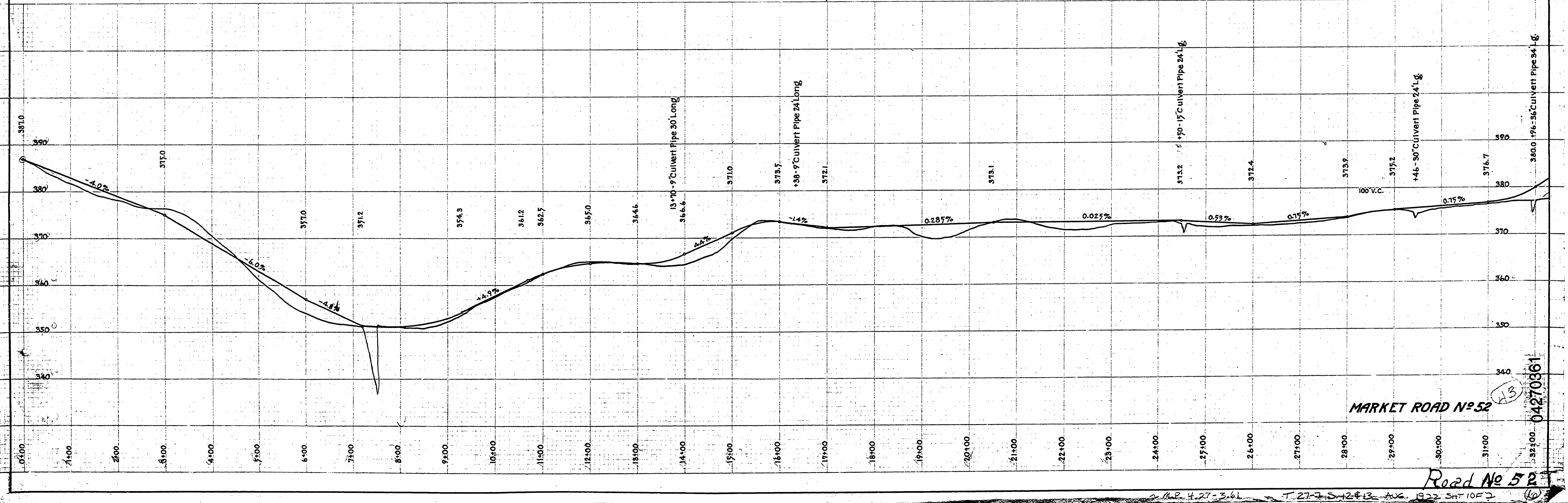

MARKET ROAD No 52

04270361  
 Road No 52

MAP 4-27-361 T 27-S 12-13 AUG. 1922 SHEET 1 OF 2