

NOTE (3) SIGNIFIES THE POINT TO WHICH THE SLOPE STAKE REFERS

# LOOKINGGLASS MELROSE, COUNTY ROAD NO.52 TYPICAL SECTIONS & INTERSECTION DETAIL

FILED  
RECEIVED  
JUL 13 1970  
COUNTY SURVEYOR  
DOUGLAS COUNTY, ORE.  
25

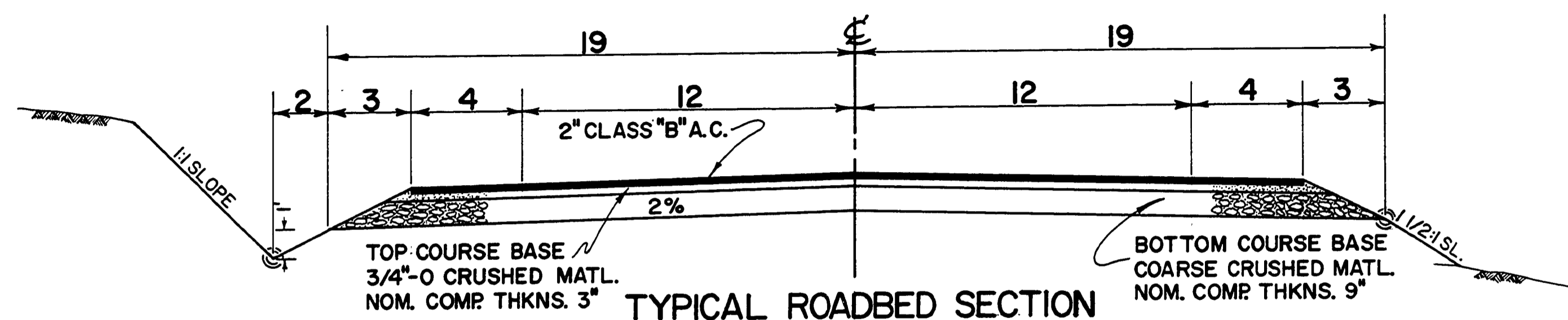

TYPICAL ROADBED SECTION

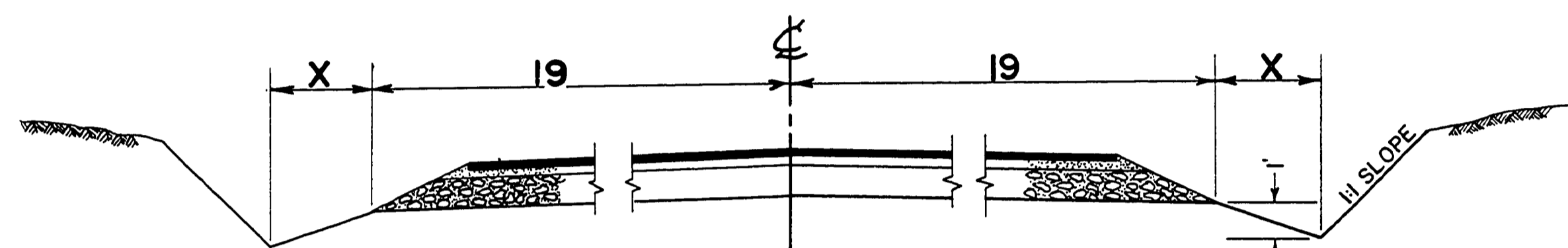

TYPICAL CUT WIDENING

STA	TO	STA	X
L <sup>2</sup> 67+00		L <sup>2</sup> 72+25	8
L 72+00		L 75+00	8
L 106+00		L 111+00	6 LT.

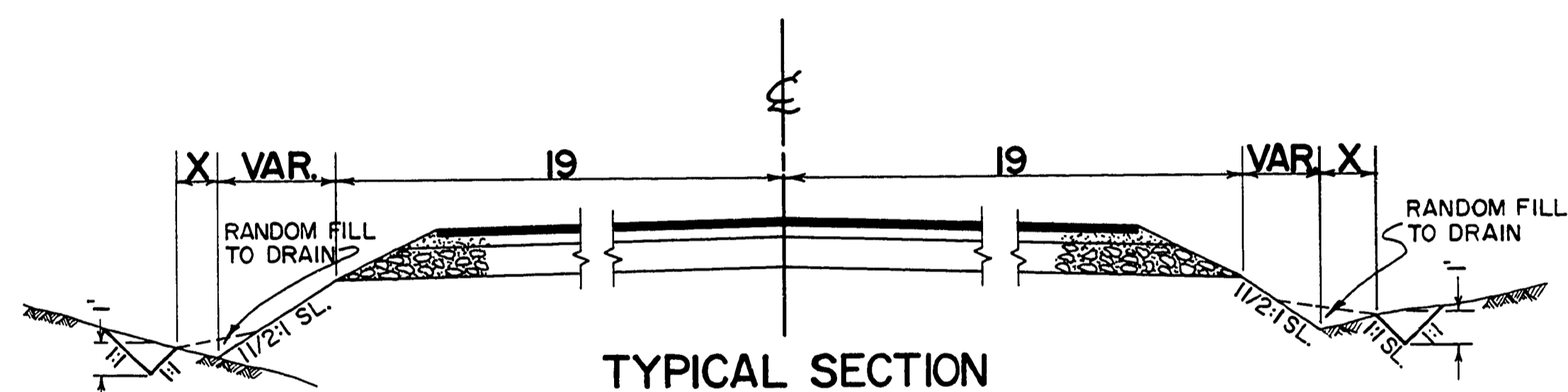

TYPICAL SECTION

STA	TO	STA	X	STA	TO	STA	X
L <sup>2</sup> 229+90		L <sup>2</sup> 231+50	2	L <sup>2</sup> 51+65		L <sup>2</sup> 59+75	2
L <sup>2</sup> 233+00		L <sup>2</sup> 235+30	2	L 77+25		L 81+70	2
L <sup>2</sup> 235+90		L <sup>2</sup> 238+00	2	L 132+80		L 134+20	2
				L <sup>3</sup> 181+50		L <sup>3</sup> 181+95	2
				L <sup>3</sup> 190+00		L <sup>3</sup> 193+75	2
				L <sup>3</sup> 205+00		L <sup>3</sup> 205+90	2
				L <sup>2</sup> 230+60		L <sup>2</sup> 235+30	4
				L <sup>2</sup> 241+00		L <sup>2</sup> 243+20	2
				L 254+00		L 255+00	2

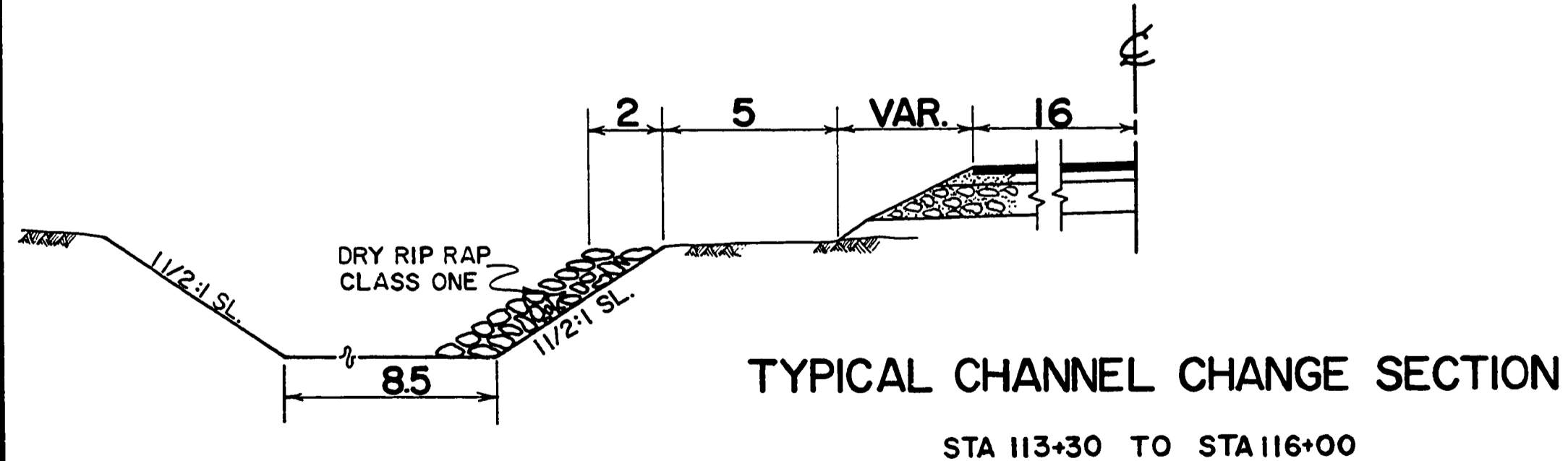

TYPICAL CHANNEL CHANGE SECTION

STA 113+30 TO STA 116+00

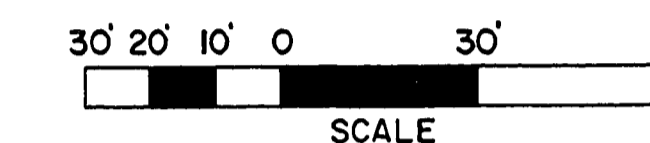
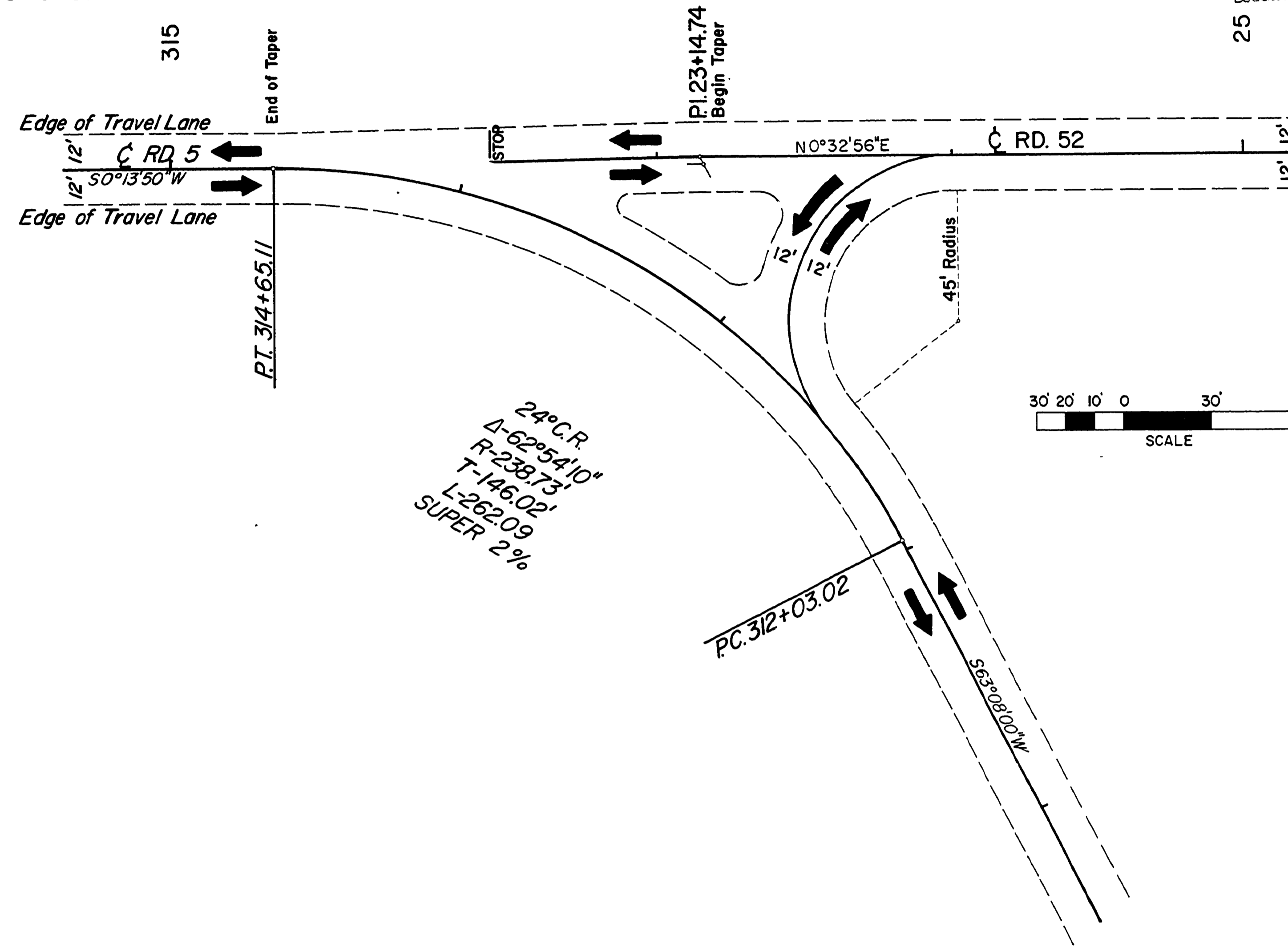

NOT REVISED  
AS CONSTRUCTED

DOUGLAS COUNTY ROAD DEPT.  
LOOKINGGLASS MELROSE # 52  
DATE: JUNE 1970 SHT 3  
GEORGE E. GRUBB COUNTY ENG.

1'0000TYP1