

NOTE: UTILITIES POLES SUBJECT TO RELOCATION
 INDICATES 3/8" IRON ROD R.W. PIN

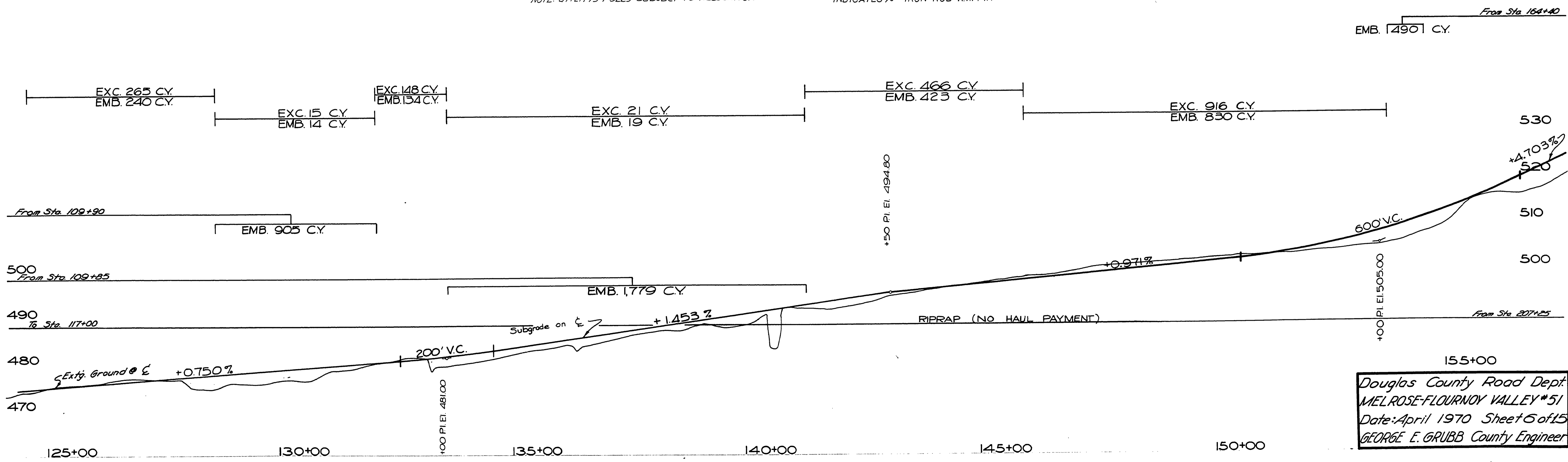

Douglas County Road Dept.
 MELROSE-FLOURNOY VALLEY #51
 Date: April 1970 Sheet 6 of 15
 GEORGE E. GRUBB County Engineer

C. Rd. # 51
 Apr. 1970
 SHEET 6 OF 15

M.P. 2.41-2.92

02410298