

DOUGLAS COUNTY OREGON
MEDLEYS-ELKHEAD RD. C50
 SECS. 31 & 32 - T. 23 S. - R. 4 W.
 F. C. FREAR, CO. ENGR.
 1932
 SHEET 4

SCALE { 1" = 10' VERT.
 1" = 100' HOR.

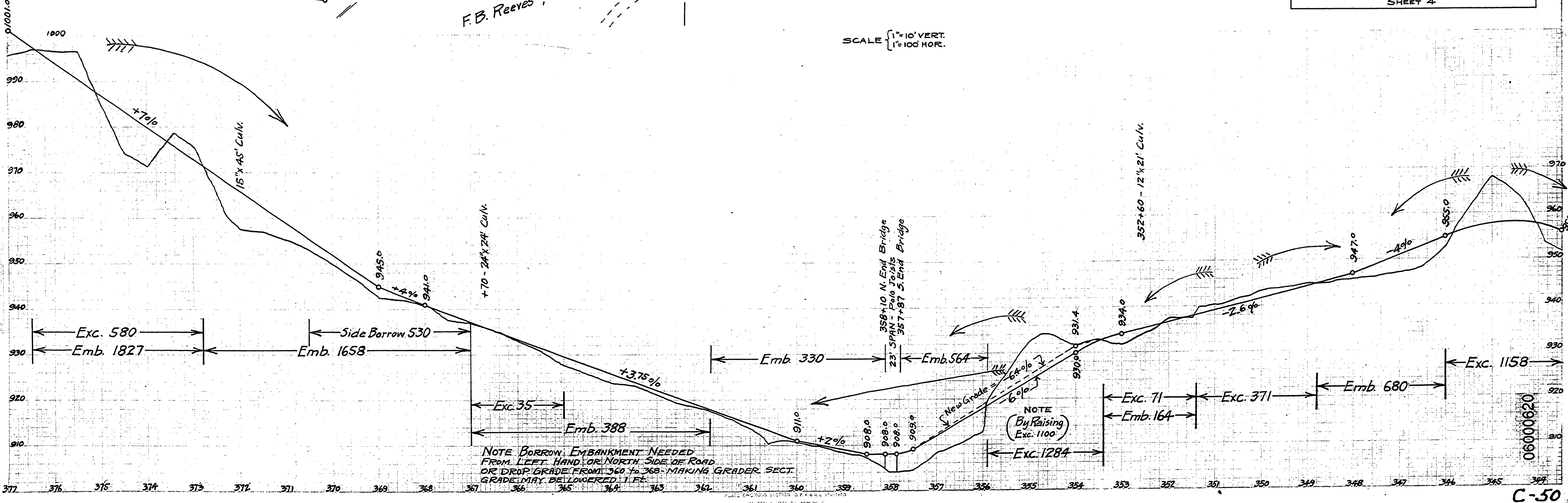

C-50

N.M.P. 600

T. 23 S. - R. 4 W. 1932 SHEET 4 OF 7