

DOUGLAS COUNTY OREGON
 LOWER SMITH RIVER C-48
 Sec's. 2 & 35, Twps. 20S, R11W,
 F.C. FREAR, ROADMASTER
 1931
 SHEET 19

Scale 1" = 10' Vert.
 1" = 100' Horiz.

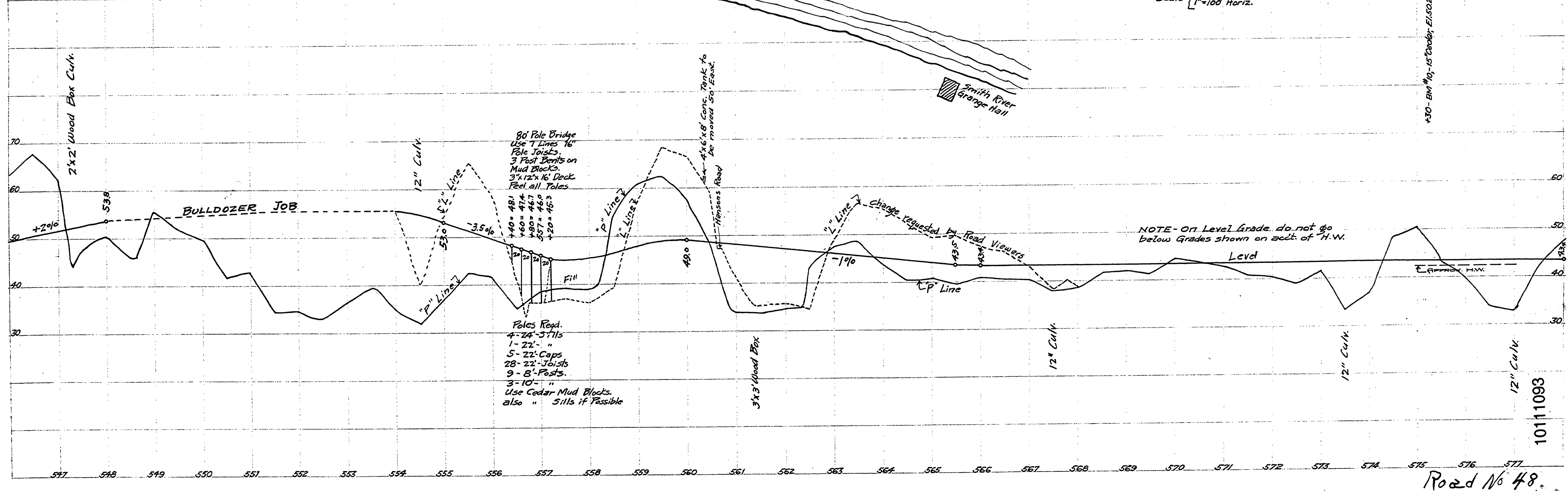

90' Pole Bridge
 Use 1 Line 1 1/2"
 Pole Joists,
 3 Post Bents on
 Mud Blocks.
 3" x 12" x 16' Deck
 Peel all Poles

Poles Req'd.
 4-24' 5" 1 1/2"
 1-22' "
 5-22' Caps
 28-22' Joists
 9-8' Posts
 3-10' "
 Use Cedar Mud Blocks
 also " Sills if Possible

NOTE - On Level Grade do not go below grades shown on acct. of H.W.

+30 - BM #10 - 15' Cedar, E15022

10111093

Road No 48

M.P. 10.11 - 10.93

20S-11

20S-11-1093-1094-1095-1096-1097-1098-1099