

DOUGLAS COUNTY OREGON
LOWER SMITH RIVER C.48
 SEC. 17, T. 21 S., R. 11 W.
 F.C. FREER ROADCORNER.
 1934 SHEET 9

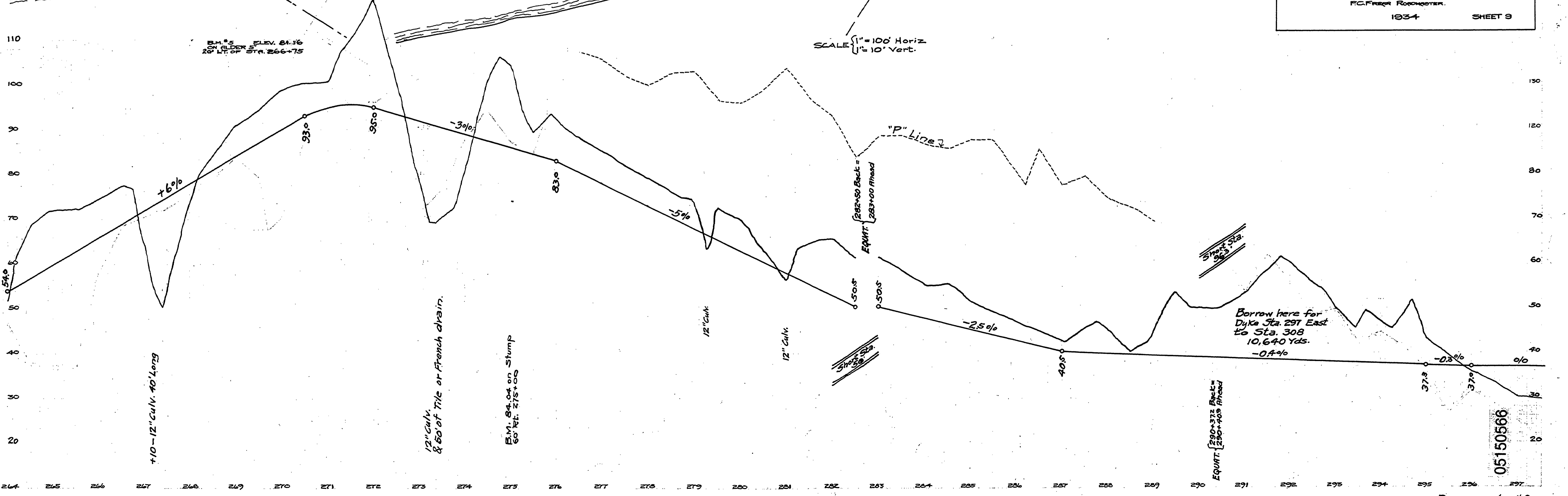

SCALE 1" = 100' Horiz.
 1" = 10' Vert.

05150566

Road No 48

N.M.P. 5.15-5.66

T. 21 S., R. 11 W., S. 17

13