

SEC. 24 T. 21 S. R. 12 W. W.M.

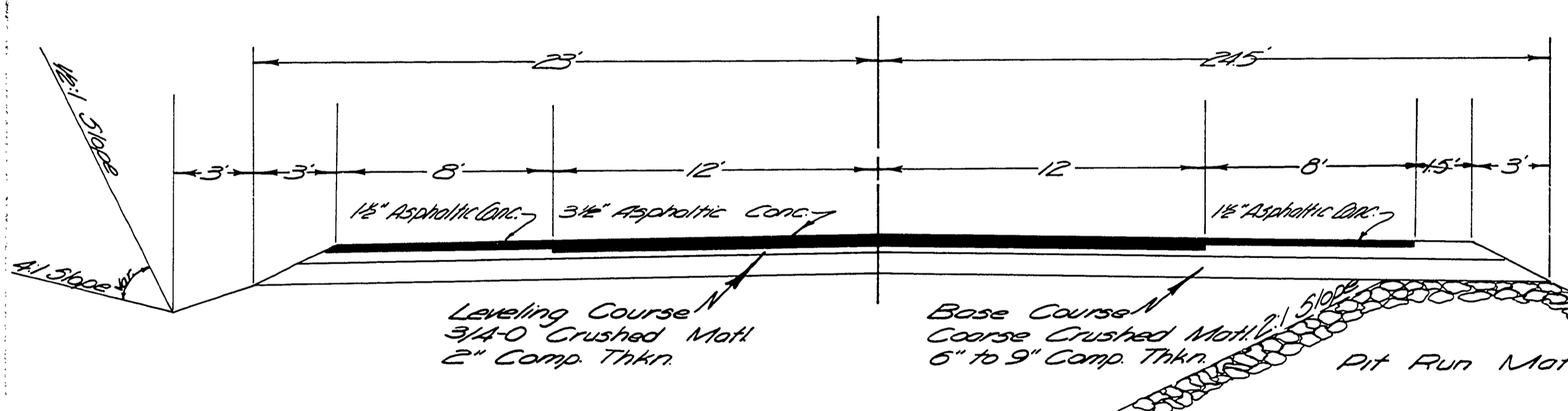

4° C.R.  
 Δ-62°34'00"  
 R-1432.40'  
 T-870.34'  
 L-1554.17'  
 Super. Rat. .068/ft.

Profile Scale 1"=5' Vert. 1"=50' Horiz.

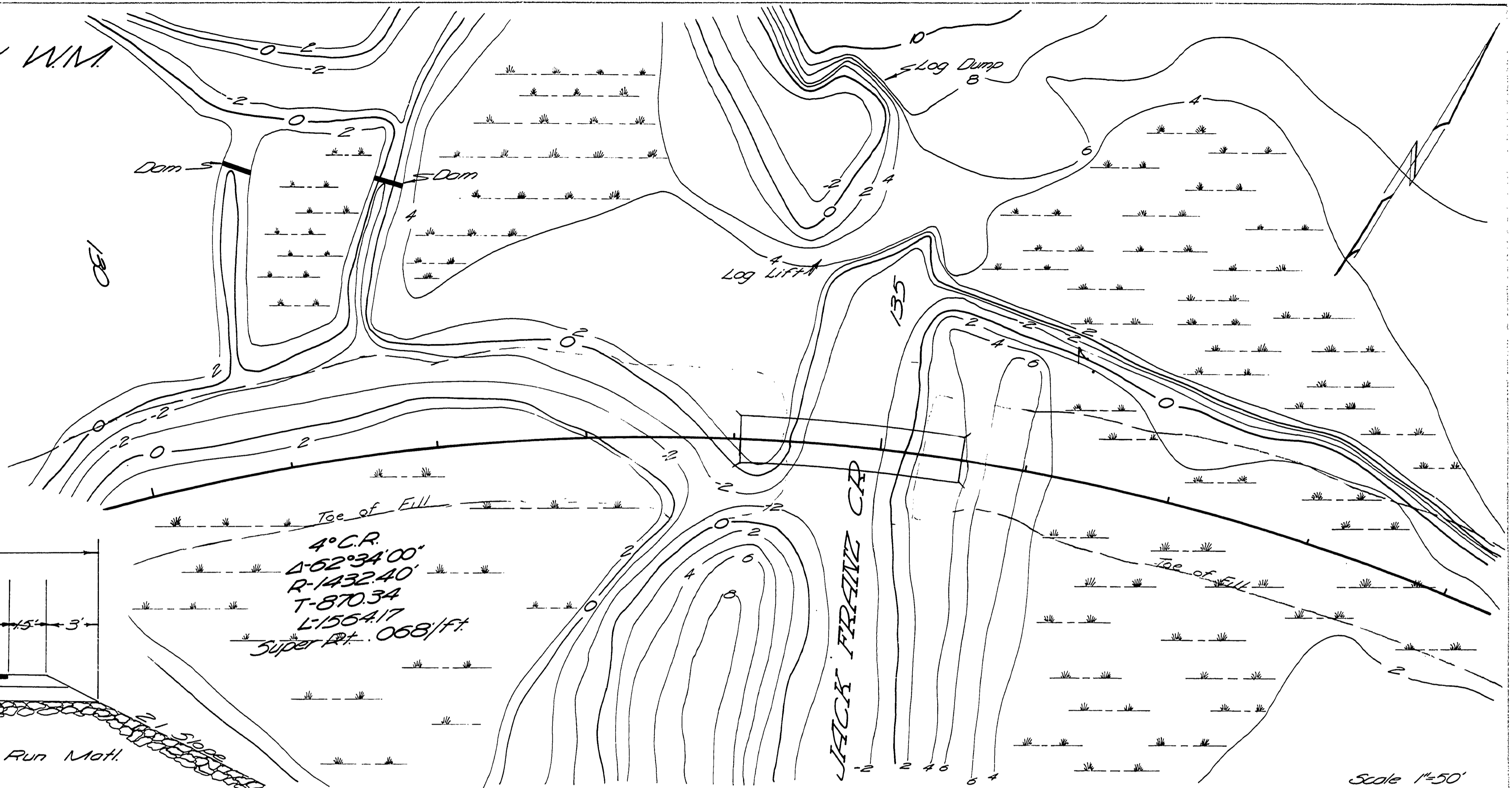
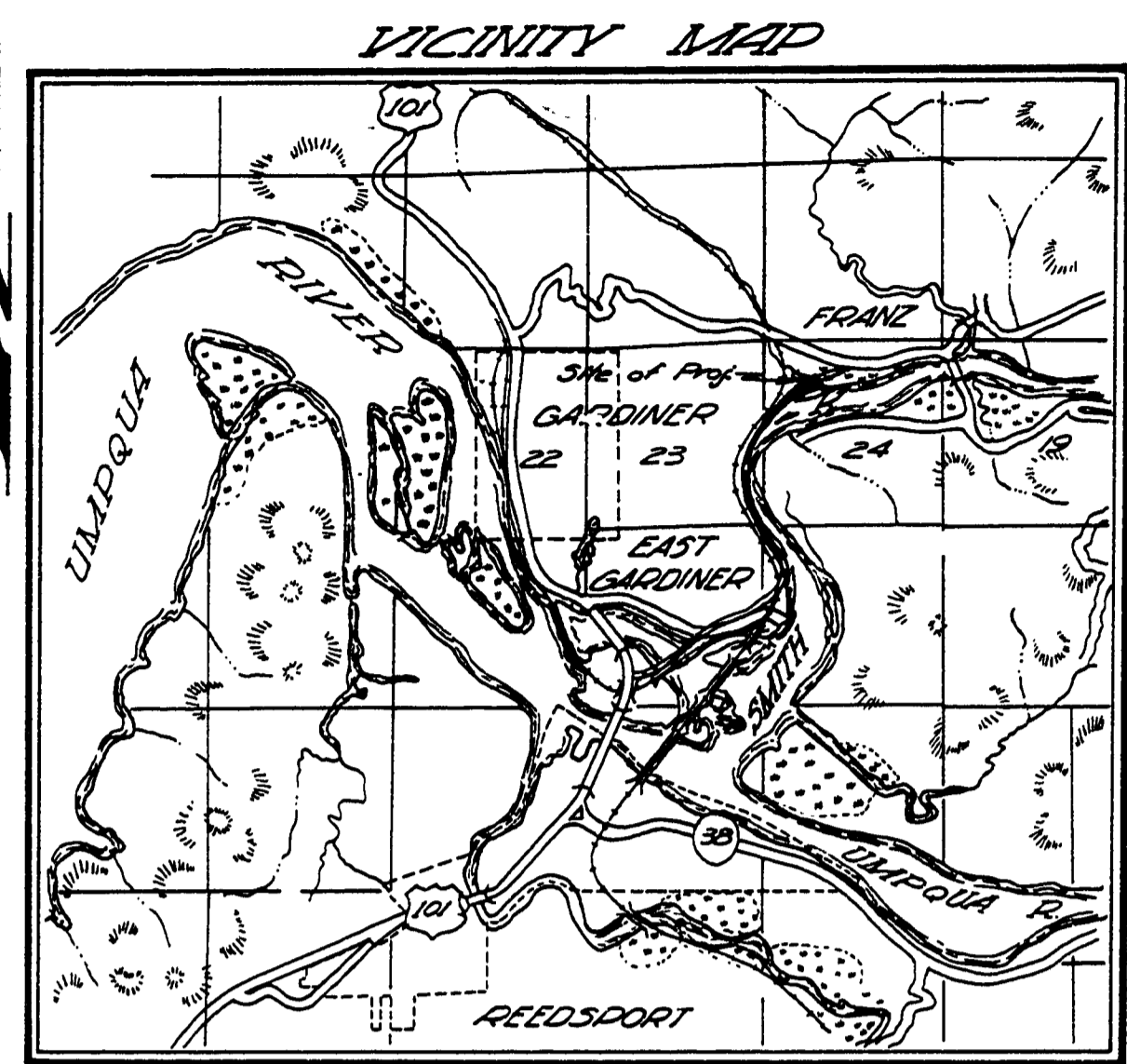
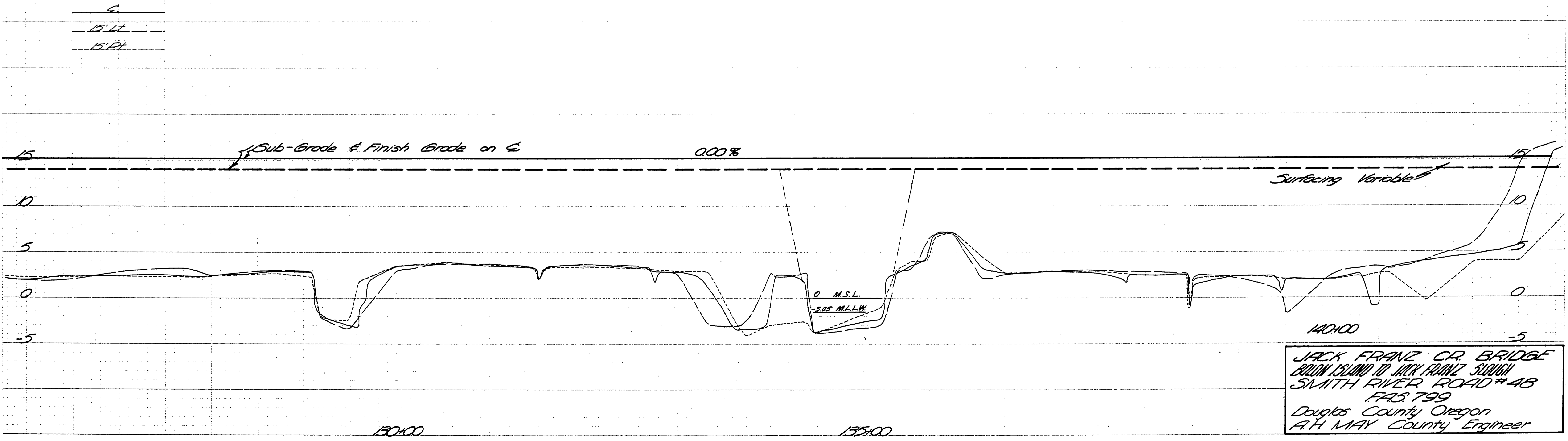

**JACK FRANZ CR BRIDGE**  
 BROWN ISLAND TO JACK FRANZ SLUGH  
 SMITH RIVER ROAD #48  
 FAS 799  
 Douglas County Oregon  
 A.H. MAY County Engineer