

SEC. 26 T21S R12W WM

OREGON STATE HWY DEPT. BRASS' CAP
 LOCATION NORTH WEST COR. SMITH RIVER BRIDGE P. 240-1938
 ELEVATION 14.03 M.S.L.

INTERNATIONAL PAPER
 LONGVIEW WASHINGTON

Begin Project 4.10.100 Smith River
 Sta. 57+11 thru 5.11.11.15

STA. 24+39 To STA. 27+42
 INST. GUARD RAIL 312.5
 LIN. FT. 2 END PIECES &
 29 GUARD RAIL BLOCKS

STA. 16+86 To STA. 19+23
 INST. GUARD RAIL
 237.5 LIN. FT.
 2 END PIECES
 23 GUARD RAIL
 BLOCKS

6° C.R.
 Δ 20° 15' 00"
 R 954.93
 T 170.53
 L 337.50'
 Super Rate .075/H

SMITH RIVER

INTERNATIONAL PAPER COMPANY
 LONGVIEW WASH.

Indicates 3/4" Iron Rod R/W Pin & 4x4 Post

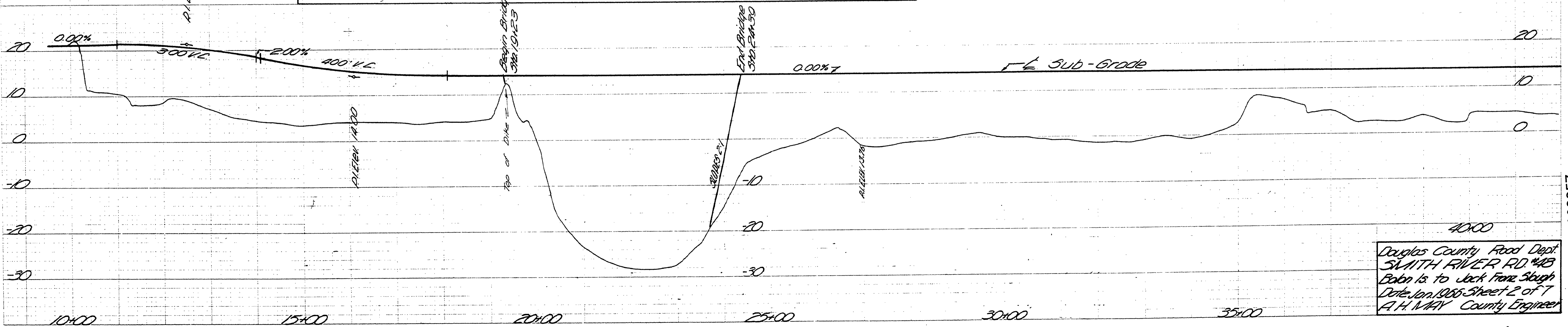
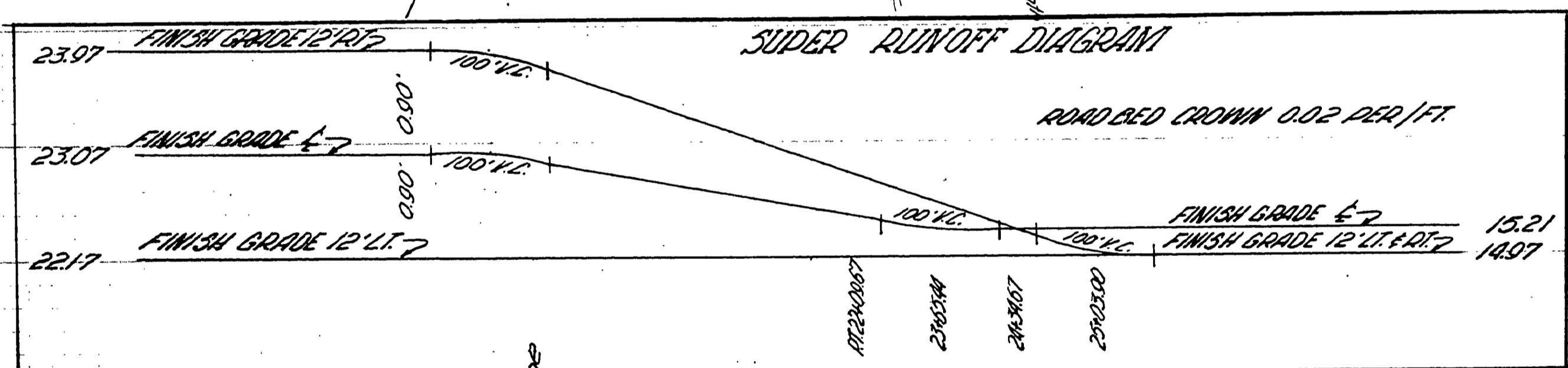

Douglas County Road Dept.
 SMITH RIVER RD. #403
 From Is. to Jack Franz Slough
 Date Jan. 1965 Sheet 2 of 7
 A.H. MAY County Engineer