

DOUGLAS COUNTY, OREGON
 PLANS FOR PROPOSED PROJECT
 ALIGNMENT & RIGHT-OF-WAY WIDTH
SOUTH UMPQUA EXT.
 COUNTY ROAD NO. 46
 OCTOBER 1960

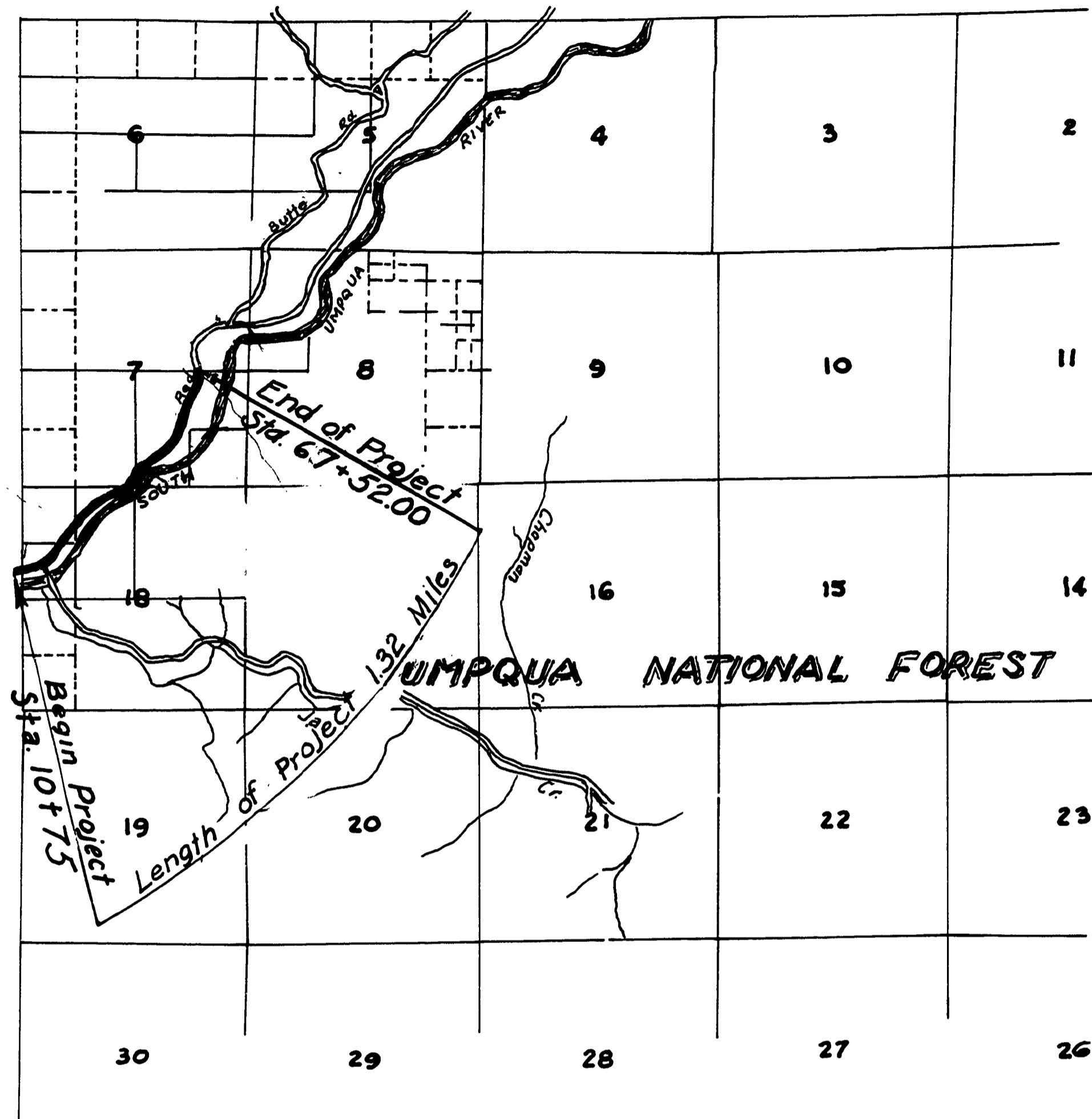

South Umpqua Extension, County Rd. No. 46
 adopted by resolution as recorded in
 Douglas County Court Journal Vol. 25
 Pg. 81 shown herein on 4 sheets
 Date May 24 1961
V. L. Jackson County Judge
E. R. [unclear] County Comm.
Ray [unclear] County Comm.



Approved by O. H. Wood Nov 24, 1964
 COUNTY ENGINEER

FILED
 RECEIVED
 MAY 11
 COUNTY SURVEYOR
 DOUGLAS COUNTY, OREGON

Sheet 1 of 4

Oct. 1960
 Co. Rd #46 St. 1 of 4 (68)

0536040C