

Verlon C. Powell

EQUATION  
 $\Delta 30^\circ 29' 30''$   
 $T 104.11$   
 $L 196.83$   
 (Douglas Co. line)

Note: From Equation Sta. 47+20.75 Bk. 35+90.00 Ah  
 Line is as shown on P.R.A. map Project No. 287-A.

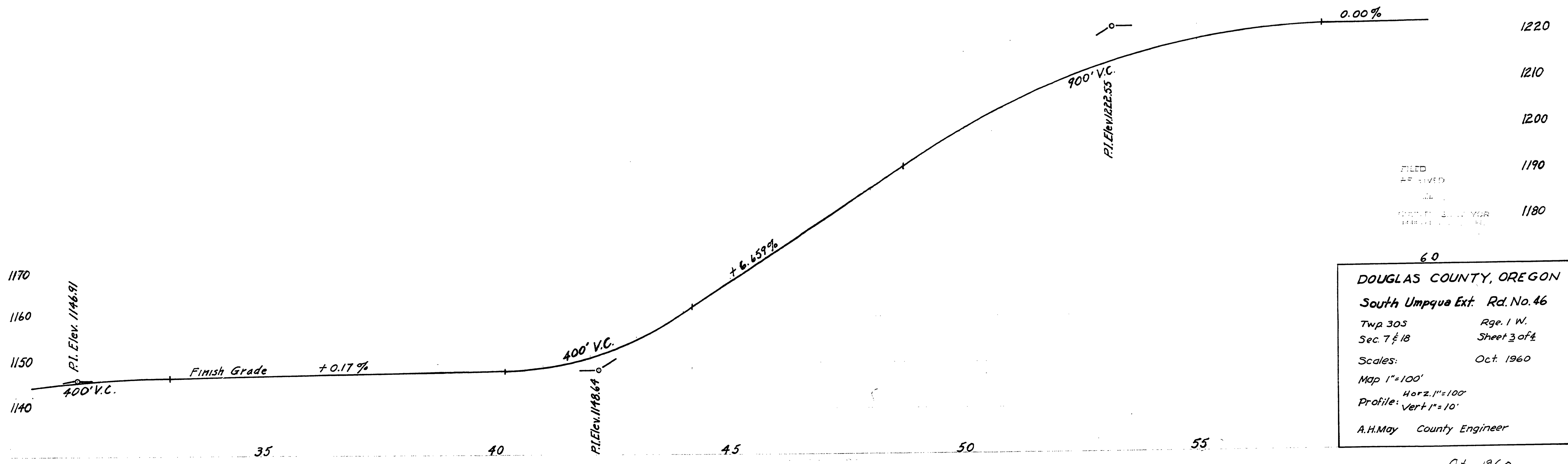

60  
**DOUGLAS COUNTY, OREGON**  
 South Umpqua Ext. Rd. No. 46  
 Twp 30S Rge. 1 W.  
 Sec. 7 & 18 Sheet 3 of 4  
 Scales: Oct. 1960  
 Map 1"=100'  
 Profile: Horiz. 1"=100'  
 Vert. 1"=10'  
 A.H. May County Engineer

M.P. 4.90 - 4.31

Co. Rd. #46 Oct. 1960  
 3 of 4 (70)