

DOUGLAS COUNTY, OREGON
 PLANS FOR PROPOSED PROJECT
 GRADING, ROCK PRODUCTION, PLACING
 AND PROCESSING BASE ROCK

TILLER-SOUTH UMPQUA RD. NO. 46
UNIT "B"

MILE POINT 5.57 to MILE POINT 3.33

—1975—

FILED
 Date: 5-21-2005 By: J.P.
 This survey consists of:
 Map: Co. RD. # 46
 Narrative:
 Corner Rpt:
 DOUGLAS COUNTY
 SURVEYOR

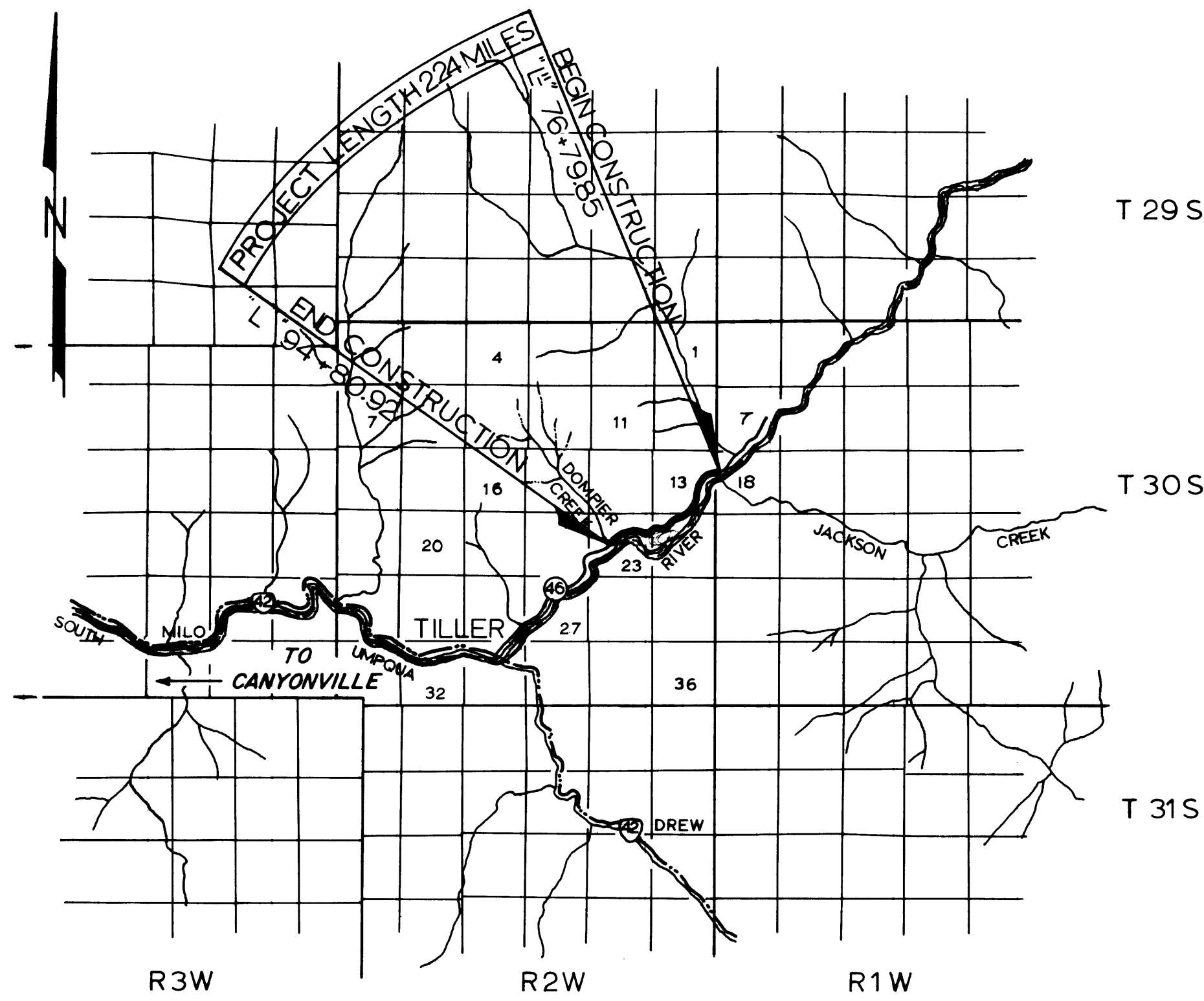

INDEX OF DRAWINGS
 SHEET NUMBER

1	TITLE SHEET
2	QUANTITY SUMMARY
3	TYPICAL SECTIONS
4	PIPE LIST, MAIL BOX STAND, DRIVEWAY TYPICALS & SLOPE STAKE EXAMPLE
5-9	ROAD PLANS
	STANDARD DRAWINGS
9	



AS BUILT 10-6-78 R.U.F.
 DOUGLAS COUNTY ROAD DEPT.
TILLER-SOUTH UMPQUA #46
 1975 SHT. 1A
 GEORGE E. GRUBB COUNTY ENGR.

0338055C