

PLAN
SURVEYED
PLOTTED
CHECKED
DATE
BY
NO. OF WAY CHECKED
NOTE BOOK NO.

PROFILE
SURVEYED
PLOTTED
CHECKED
DATE
BY
STRUCTURE NOTATIONS CHECKED
NOTE BOOK NO.

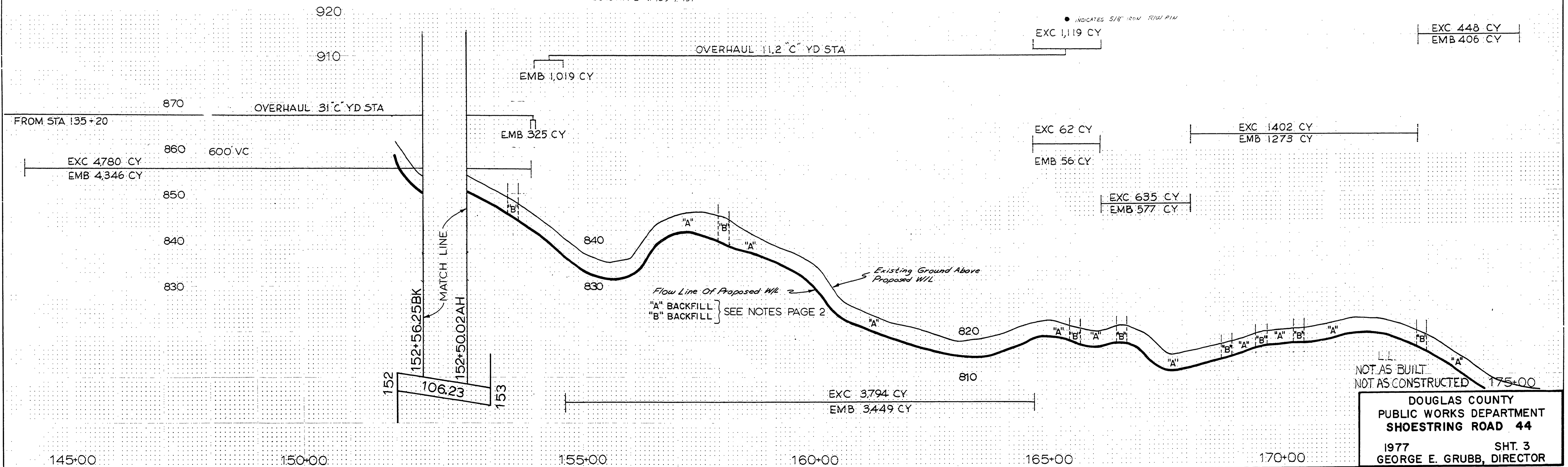

NOT AS BUILT
NOT AS CONSTRUCTED

DOUGLAS COUNTY
PUBLIC WORKS DEPARTMENT
SHOESTRING ROAD 44

1977 SHT. 3
GEORGE E. GRUBB, DIRECTOR

02810325