

• Indicates 3/4" Iron pins & 4x4 posts.

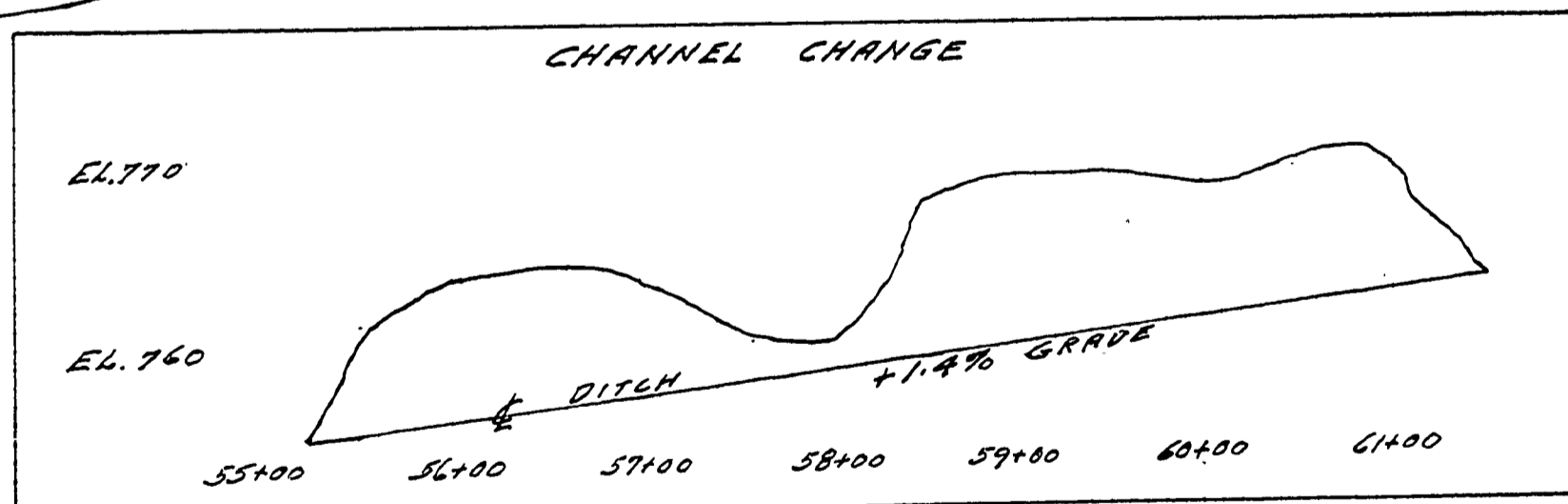
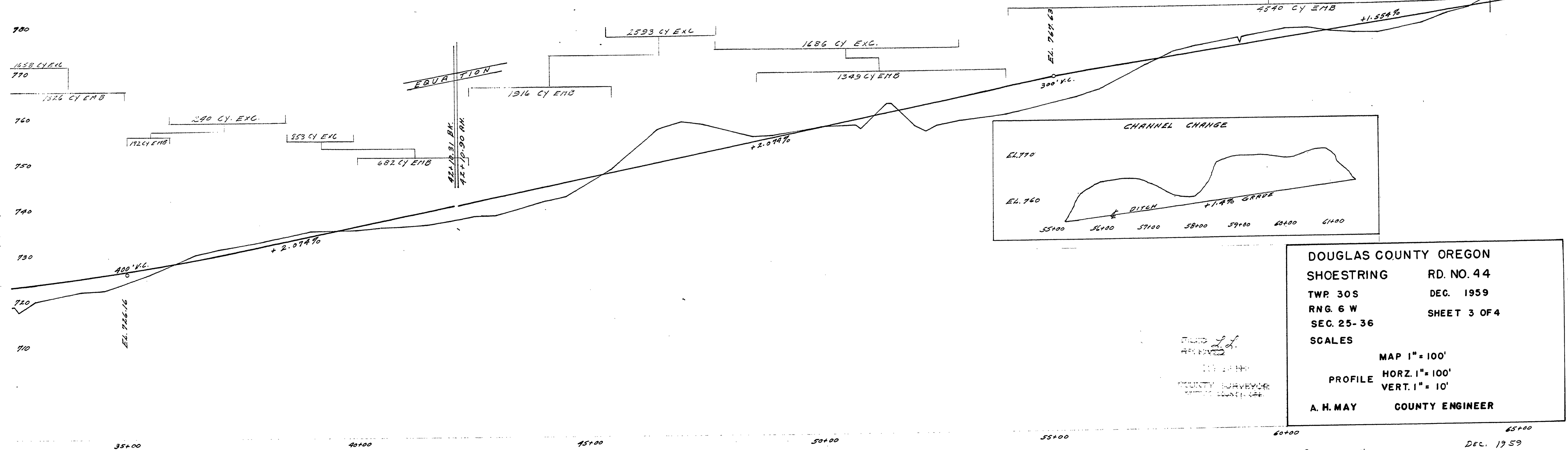

DOUGLAS COUNTY OREGON
 SHOESTRING RD. NO. 44
 TWP. 30S DEC. 1959
 RNG. 6 W SHEET 3 OF 4
 SEC. 25-36
 SCALES
 MAP 1" = 100'
 PROFILE HORZ. 1" = 100'
 VERT. 1" = 10'
 A. H. MAY COUNTY ENGINEER

00650125