

DOUGLAS COUNTY, OREGON
 PLANS FOR PROPOSED PROJECT
 GRADING & SURFACING

MYRTLE CREEK - DAYS CREEK RD. NO. 42
 MILE POINT 1.75 TO MILE POINT 2.57

1985

FILED
 RECEIVED *JK*
 MAY 10 1985
 COUNTY SURVEYOR
 DOUGLAS COUNTY, ORE.

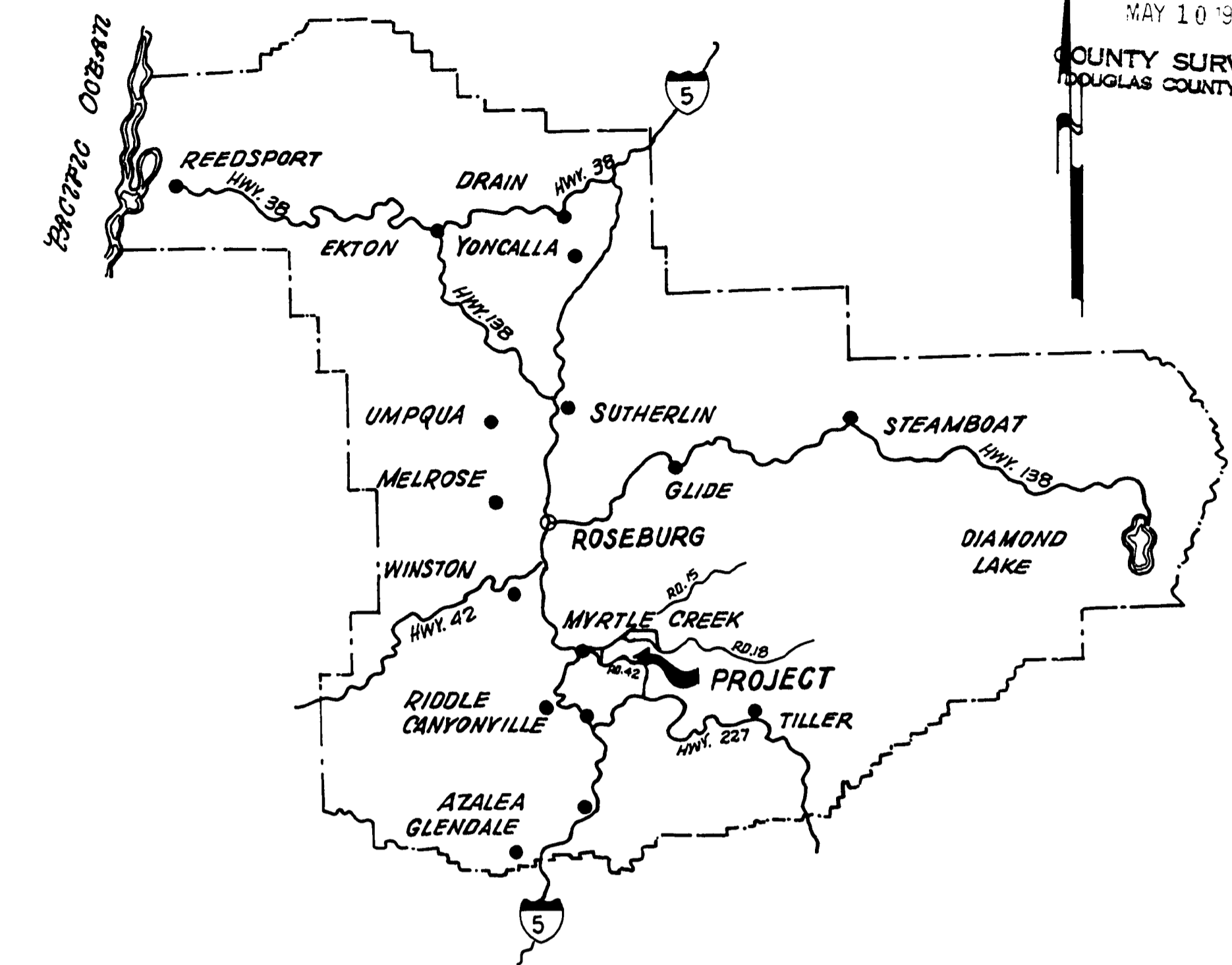

VICINITY MAP
 NO SCALE

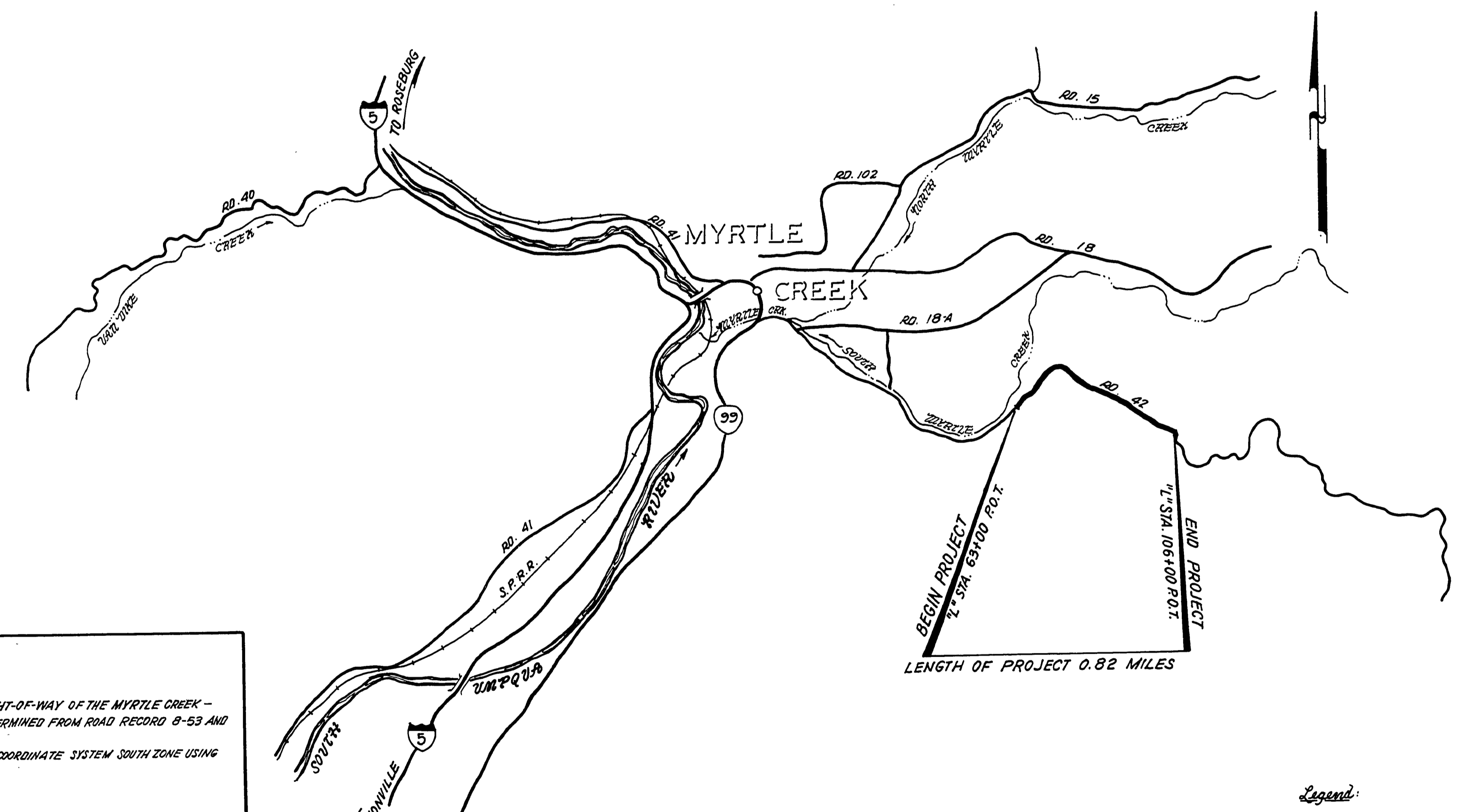

LOCATION MAP
 NO SCALE

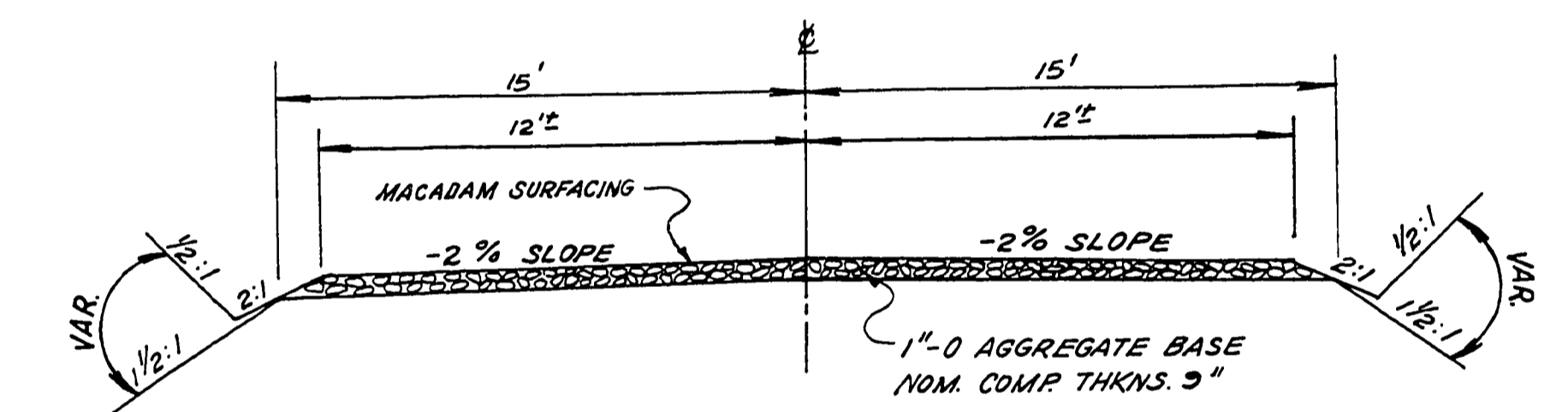

TYPICAL SECTION
 "L" STA. 63+00 ~ "L" STA. 106+00

NARRATIVE:

PURPOSE OF THIS SURVEY IS TO MONUMENT EXISTING ROAD RIGHT-OF-WAY OF THE MYRTLE CREEK - DAYS CREEK COUNTY ROAD NO. 42. PREVIOUS RIGHT-OF-WAY WAS DETERMINED FROM ROAD RECORD B-53 AND COURT JOURNAL S-207 USING THE OLD ROAD CENTERLINE.
 BEARINGS SHOWN HEREIN ARE BASED ON THE OREGON STATE PLANE COORDINATE SYSTEM SOUTH ZONE USING THE FOLLOWING CONTROL STATIONS:

DOUGLAS COUNTY SURVEYOR
 RIVERSIDE N. 506,422.21, E. 1,258,068.25
 6M-1 N. 506,399.09, E. 1,258,663.25
 3M-2 N. 508,124.96, E. 1,263,650.34

U.S. GEOLOGICAL SURVEY
 1 HJH 722 N. 508,589.97 E. 1,264,389.21

PLAN DISTANCES AND STATIONS SHOWN HEREIN ARE HORIZONTAL. GRID FACTOR USED BETWEEN OREGON STATE PLANE COORDINATE SYSTEM AND HORIZONTAL IS 0.9998634 WHICH INCLUDES SCALE AND SEA LEVEL FACTORS.
 DATUM FOR ELEVATIONS IS BASED ON MEAN SEA LEVEL.

INDEX OF DRAWINGS

SHEET NO.
 1 COVER
 2&3 PLAN AND PROFILE

AS CONSTRUCTED

- Legend:
- = ROADWAY CENTERLINE CONTROL POINT (NOT MONUMENTED)
 - = SET 3/8" x 30" IRON ROD W/ ALUMINUM CAP MARKED DOUGLAS CO. RD. DPT R-W
 - = FD. MON. (AS SHOWN)
 - ⊙ = FD. BRASS CAP (MARKED AS NOTED)



REGISTERED PROFESSIONAL LAND SURVEYOR
 Warren H. Poland
 OREGON
 4814 22nd St.
 WARREN H. POLAND
 1392

REVISIONS			DOUGLAS COUNTY COUNTY ENGINEERING DEPARTMENT	
Engr.	Drawn	Checked	K. L. ERICKSON, COUNTY ENGINEER	
KL	JLM	DA		
Approval: <i>Warren H. Poland</i>			Date: APRIL, 1985	Scale: AS SHOWN
			Drwg. No.	

0175025C

Rd #42 (25-A)