

NOTE:-  
 ● = 3/4" IRON ROD SET.  
 ○ = AS SHOWN  
 \* = "P-N" NAIL SET ON  $\Phi$   
 \* = AS SHOWN ON  $\Phi$   
 BEARINGS SHOWN ARE TRUE, BASED ON SOLAR OBSERVATION MADE OCTOBER 14, 1953.

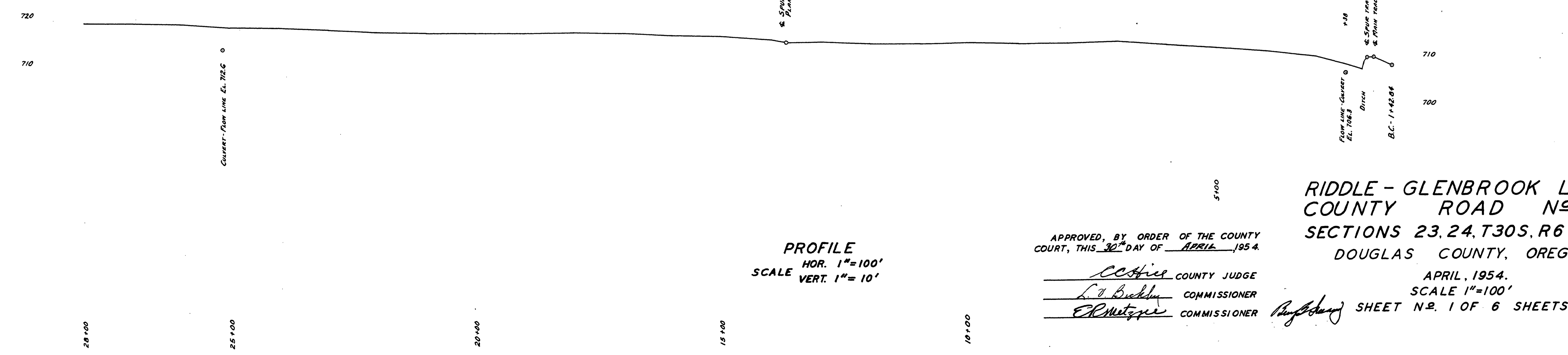

PROFILE  
 HOR. 1"=100'  
 SCALE VERT. 1"=10'

APPROVED, BY ORDER OF THE COUNTY COURT, THIS 30<sup>th</sup> DAY OF APRIL, 1954.

*C. H. ...* COUNTY JUDGE  
*L. V. ...* COMMISSIONER  
*E. R. Metzger* COMMISSIONER

RIDDLE - GLENBROOK LOOP  
 COUNTY ROAD No. 39  
 SECTIONS 23, 24, T30S, R6W, W.M.  
 DOUGLAS COUNTY, OREGON.

APRIL, 1954.  
 SCALE 1"=100'  
 SHEET No. 1 OF 6 SHEETS.

M.P. 0.58 - 0.23

Co. Rd # 39  
 Apr 1954  
 1 of 6

00580023