

MARTIN BUSHNELL
*Martin Bushnell to Douglas County
 40' Right of Way Sta. 33+30 to Sta. 66+00
 Road Record 8 Page 408*

**DOUGLAS COUNTY HIGHWAY
 IMPROVEMENT
 PROFILE AND ALIGNMENT
 OLLALA COOS-BAY
 OLLIVANT SECTION
 SEC'S. 27 - 34, TWP. 28 S., R. 7 W.M.
 STA. 30+00 TO STA. 63+15.0**
 OFFICE OF
 F. C. FREAR
 COUNTY ROADMASTER
 SCALE: HOR. 1 in = 100 FT. VER. 1 in = 10 FT.
 SHEET NO. 2

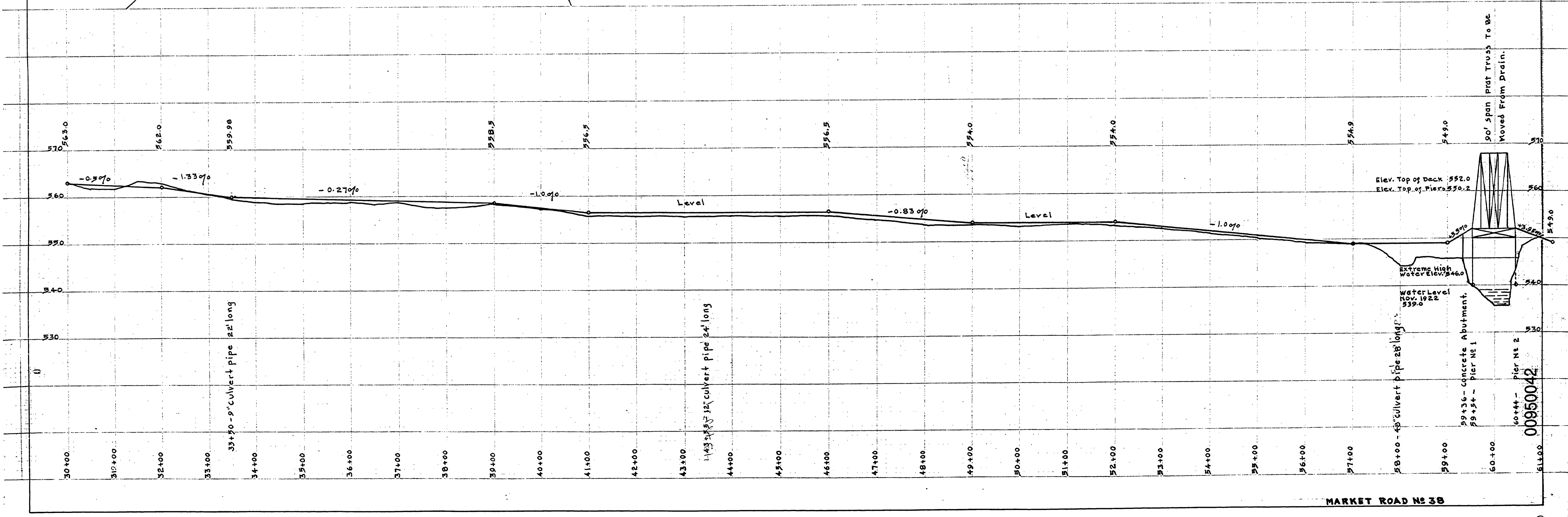

MARKET ROAD NO. 38

M.P. 0.95 - 0.42

T. 28 - 7 SEC'S. 27 - 34 TWP. 28 S. R. 7 W.M. SHEET NO. 2

00950042