

# DOUGLAS COUNTY OREGON AS CONSTRUCTED GRADING & SURFACING COW CREEK RD. NO. 36 ANCHOR SCHOOL TO DEVILS FLAT, SECTION APRIL 1965

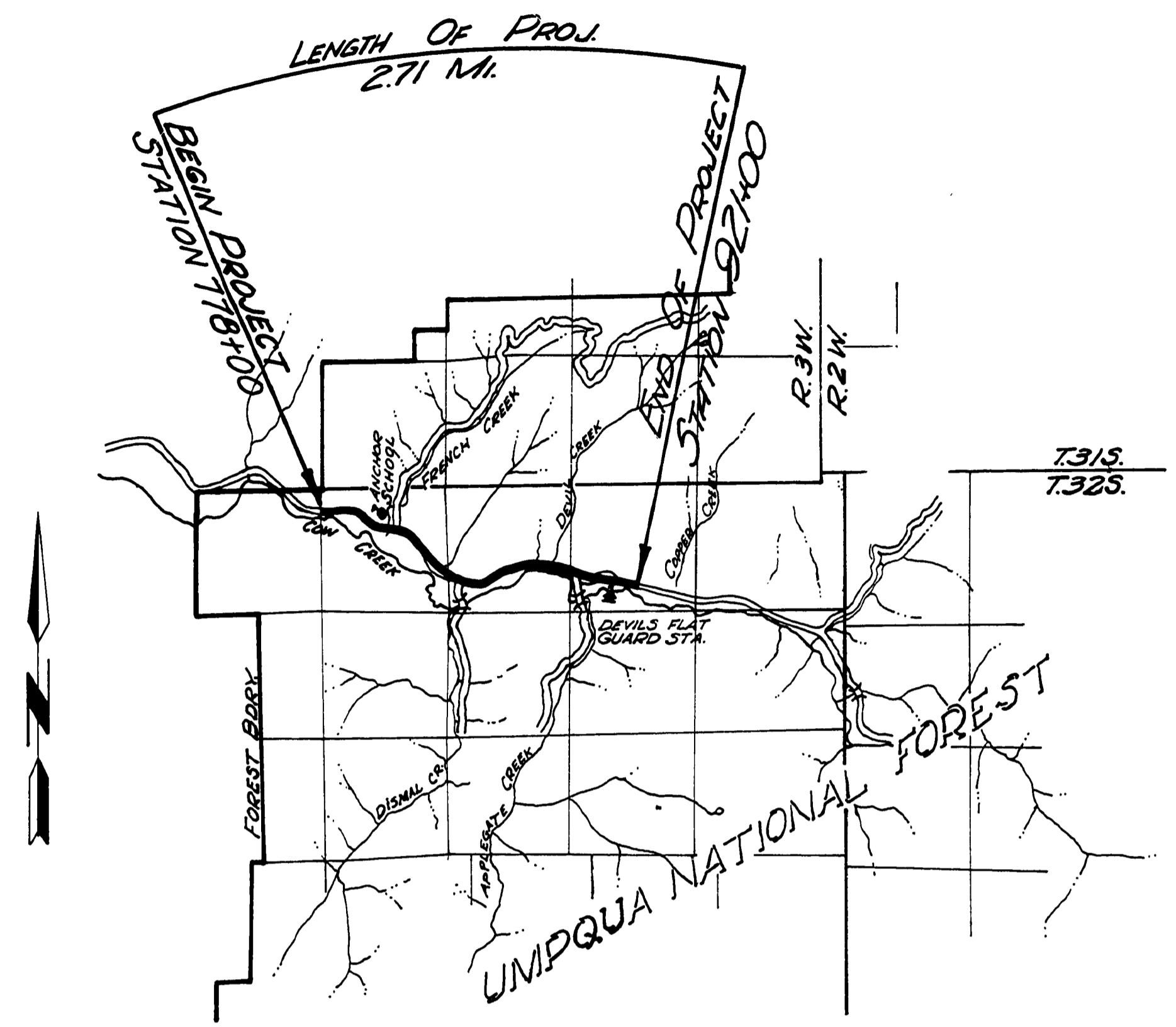

VICINITY MAP

APPROVED BY DOUGLAS COUNTY  
BOARD OF COMMISSIONERS THIS  
DAY March 1966

*Ralph Dolson*  
COMMISSIONER

COMMISSIONER  
*E. P. Peterson*  
COMMISSIONER

*Al. B. Pheasant* Date Mar. 2, 1966  
COUNTY ENGINEER

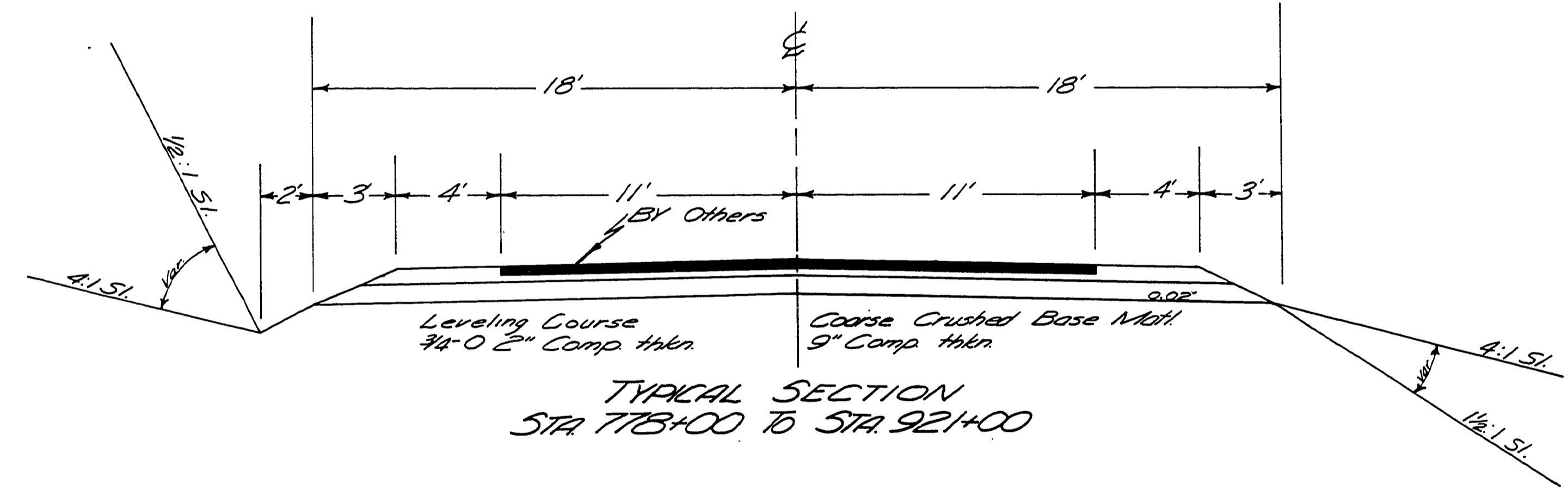

TYPICAL SECTION  
STA 778+00 TO STA 921+00

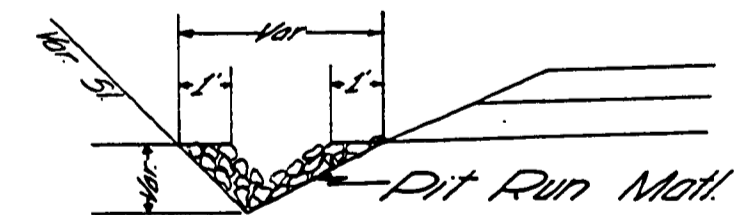

TYPICAL SEC. SPECIAL DITCH  
STA 826+25 TO STA 828+00  
STA 829+25 TO STA 834+35  
STA 840+47 TO STA 848+50

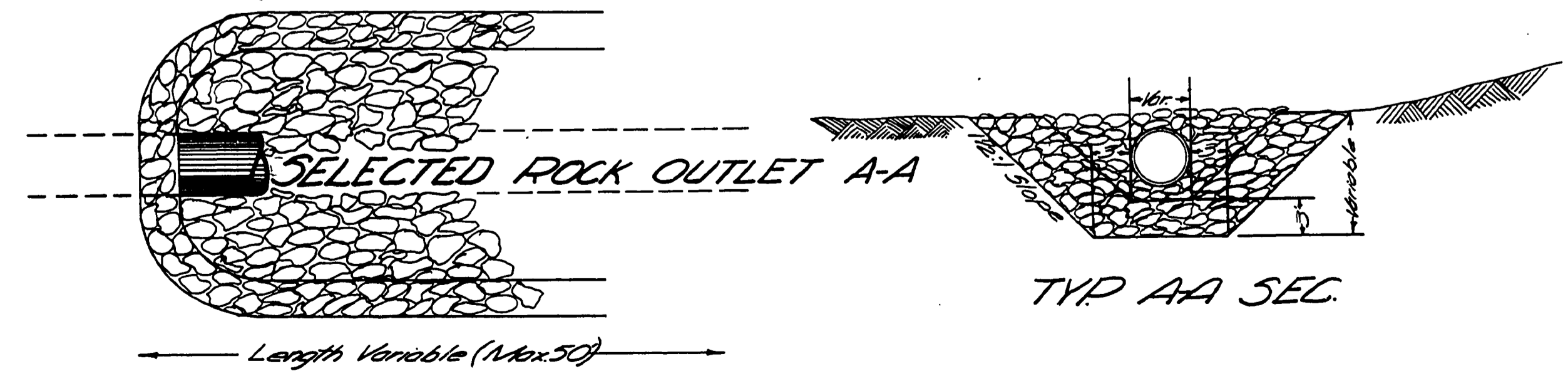

TYP AA SEC.

FILED  
RECEIVED  
MAR 3 1966  
COUNTY SURVEYOR  
DOUGLAS COUNTY, ORE.  
APR 1965