

NOTE - STATIONS ARE WEST OF EQUATION 2+17.19 = 0+00

NOTE - • DESIGNATES 3/8" IRON PIN ON R/W

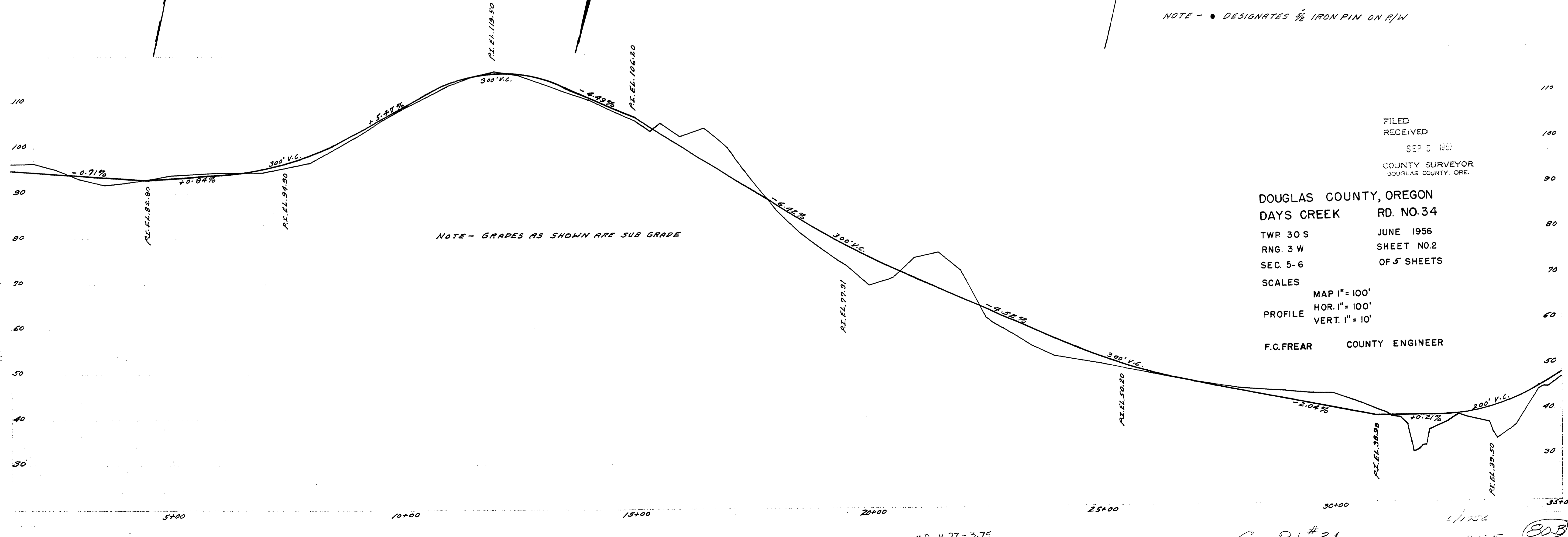

NOTE - GRADES AS SHOWN ARE SUB GRADE

FILED
RECEIVED
SEP 8 1956
COUNTY SURVEYOR
DOUGLAS COUNTY, ORE.

DOUGLAS COUNTY, OREGON
DAYS CREEK RD. NO. 34
TWP. 30 S
RNG. 3 W
SEC. 5-6
SCALES
MAP 1" = 100'
HOR. 1" = 100'
PROFILE VERT. 1" = 10'

F.C. FREAR COUNTY ENGINEER

M.P. 4.27 - 3.75

Co Rd # 34

04270375

80.5