

LOYAL EMERY

LOYAL EMERY

J. W. MCKEE

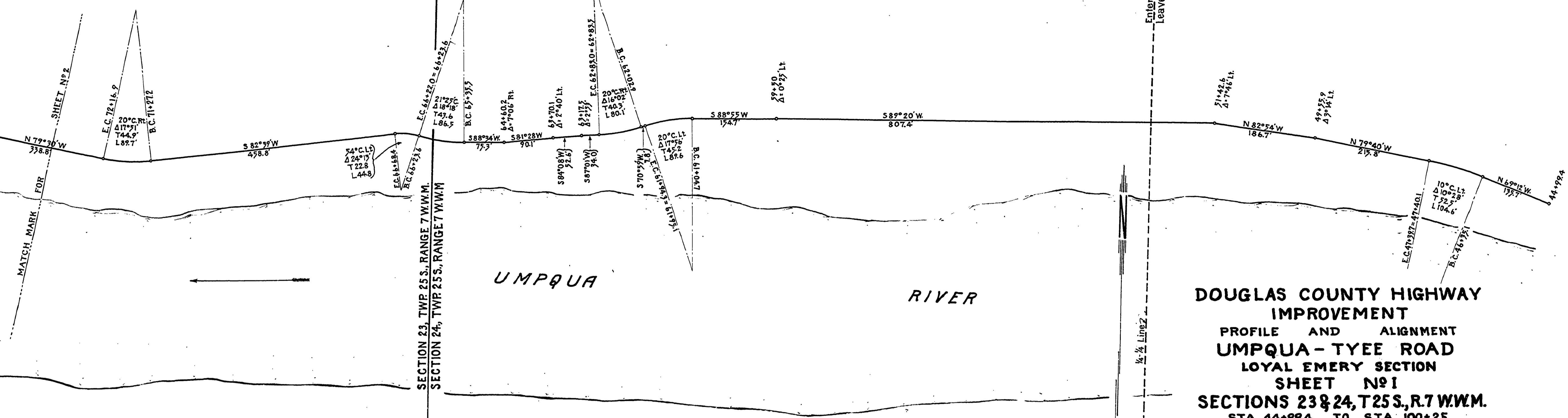

DOUGLAS COUNTY HIGHWAY IMPROVEMENT
PROFILE AND ALIGNMENT
UMPQUA - TYEE ROAD
LOYAL EMERY SECTION
SHEET No 1
SECTIONS 23 & 24, T25 S., R.7 W.W.M.
 STA. 44+99.4 TO STA. 100+25
 OFFICE OF
 F. C. FREAR
 COUNTY ROADMASTER
 SCALE: HOR. 1in=100ft. VERTICAL 1in=10ft.

SECTION 23, TWP 25 S., RANGE 7 W.W.M.
 SECTION 24, TWP 25 S., RANGE 7 W.W.M.
 SECTION 25, TWP 25 S., RANGE 7 W.W.M.

