

UMPQUA RIVER

MARTIN RASMUSSEN

DOUGLAS COUNTY HIGHWAY IMPROVEMENT

PROFILE AND ALIGNMENT

UMPQUA - TYEE
ROCKY POINT SECTION

SECS. 7-8-9-10-15-16, T.25S. R.7W. & SEC.12 T.25S. R.8W. W.M.

STA. 219+75.0 TO STA. 259+04.4

OFFICE OF
F. C. FREAR
COUNTY ROADMASTER

SCALE: HOR. 1 in. = 100 FT. VER. 1 in. = 10 FT.

OCT. 1923
SHEET NO 1

SEC. 21

BARN

HOUSE

HOUSE

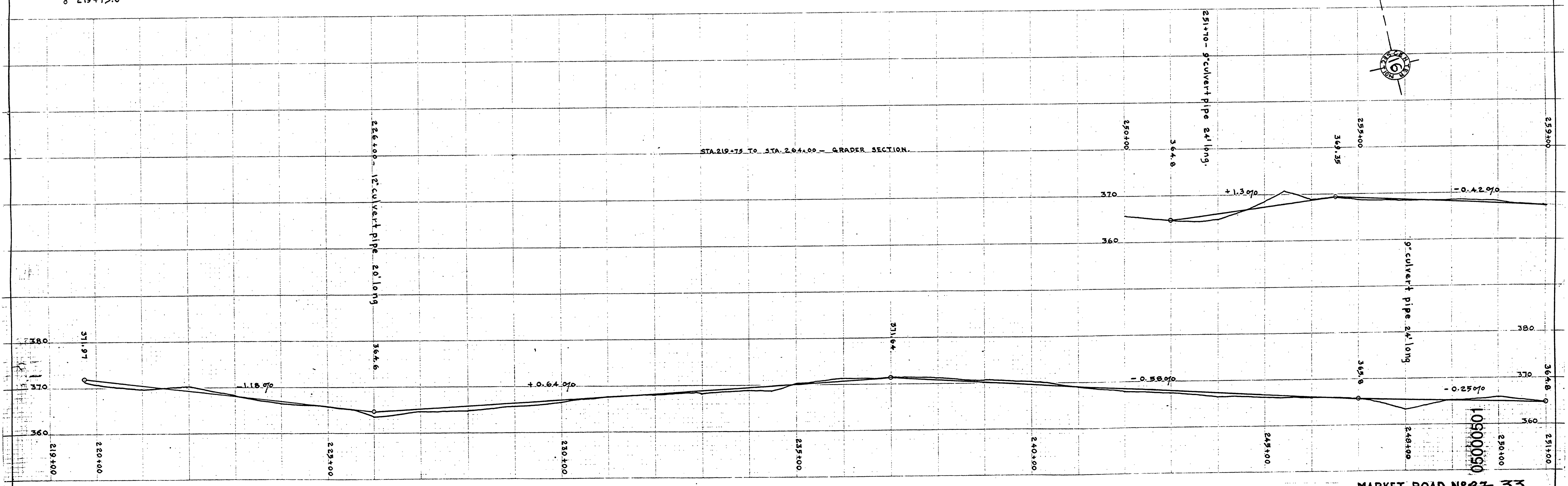

MARKET ROAD No 27-33

~M.B. 5.00 T.25. R.7W. (L.S.)