

T. 25 S. R. 6 W. W.M.

HENRY B. DAY D.L.C. 53

6° C.L.
Δ-35°52'00"
R-954.03'
T-309.05'
L-507.78'
Super-0.075'/H.

14° C.R.
Δ-84°25'45"
R-409.26'
T-371.28'
L-603.06'
Super-0.087'/H.

5° C.R.
Δ-35°18'00"
R-1145.92'
T-364.61'
L-706.00'
Super-0.072'/H.

WM TANNER
D.L.C. 62

KENNETH W. & ALICE M. MANNING

BY	DATE
ORIGINAL SURVEY	
SURVEYED	
PLOTTED	
IN DATE	
NOTE BOOK	
AREAS CHECKED	
NO.	

BY	DATE
ORIGINAL SURVEY	
SURVEYED	
PLOTTED	
IN DATE	
NOTE BOOK	
AREAS CHECKED	
NO.	

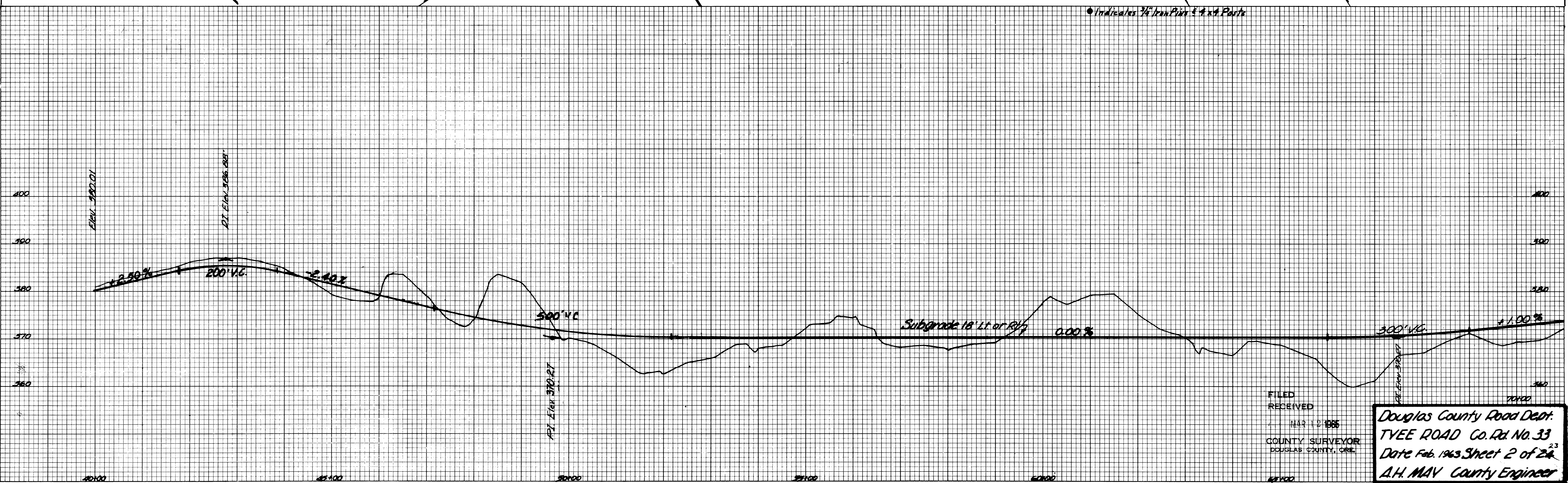

FILED
RECEIVED
MAR 12 1963
COUNTY SURVEYOR
DOUGLAS COUNTY, ORE.

Douglas County Road Dept.
TYEE ROAD Co. Rd. No. 33
Date Feb. 1963 Sheet 2 of 24
A.H. MAY County Engineer