

SEC. 29, T. 26S, R. 6W, W.M.

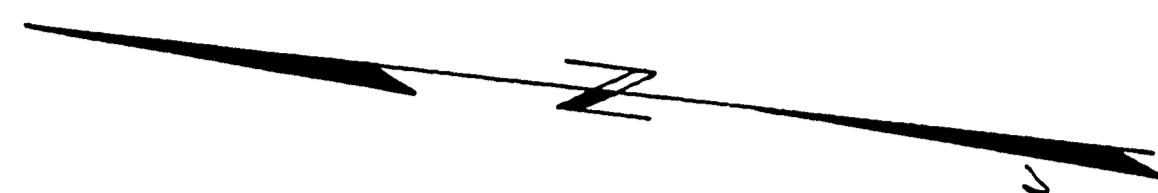

JOHN A. SINCLAIR
 RANDALL P. SINCLAIR
 ROBERT B. SINCLAIR
 GEORGINA BELLE KOHLHAGEN
 UND 1/4 INT
 285-99

ROBERT EDWARD & THELMA L. LARK
 228-137

EDWARD & GEORGINA KOHLHAGEN
 207-308

JAMES E. & MARLENE COOK
 354-822

COOK RICHIE
 754 CONST. RD. APPR.

754 CONST. RD. APPR.

754 CONST. RD. APPR.

754 CONST. RD. APPR.

754 CONST. RD. APPR.

754 CONST. RD. APPR.

754 CONST. RD. APPR.

754 CONST. RD. APPR.

754 CONST. RD. APPR.

754 CONST. RD. APPR.

754 CONST. RD. APPR.

754 CONST. RD. APPR.

754 CONST. RD. APPR.

754 CONST. RD. APPR.

754 CONST. RD. APPR.

754 CONST. RD. APPR.

754 CONST. RD. APPR.

754 CONST. RD. APPR.

754 CONST. RD. APPR.

754 CONST. RD. APPR.

754 CONST. RD. APPR.

754 CONST. RD. APPR.

754 CONST. RD. APPR.

754 CONST. RD. APPR.

754 CONST. RD. APPR.

754 CONST. RD. APPR.

754 CONST. RD. APPR.

754 CONST. RD. APPR.

754 CONST. RD. APPR.

754 CONST. RD. APPR.

754 CONST. RD. APPR.

754 CONST. RD. APPR.

754 CONST. RD. APPR.

LABRIE H. DITCHIE
 338-120

LABRIE H. DITCHIE
 338-120

HUGH & CLOE RITCHIE
 90-142

F. GRAHAM & BELLE EWENS
 331-438

SEE SHEET 7 FOR INTERSECTION DETAIL
 INST. 48" C.M.P. 64' UNDER RD. APPR.

CONST. 4" BOT. DITCH 19+25 to 20+75
 50' UNDER RD. APPR.

MILDED 1.5" NASH
 311-477

10° C.R.
 $\Delta = 21' 41"$
 $R = 372.96$
 $T = 109.73$
 $L = 216.82$

ALL CUT SLOPES 1:1

• Indicates 5/8" Iron Rod R/W Pins 4"x4" Post

430
 420
 410
 400
 390

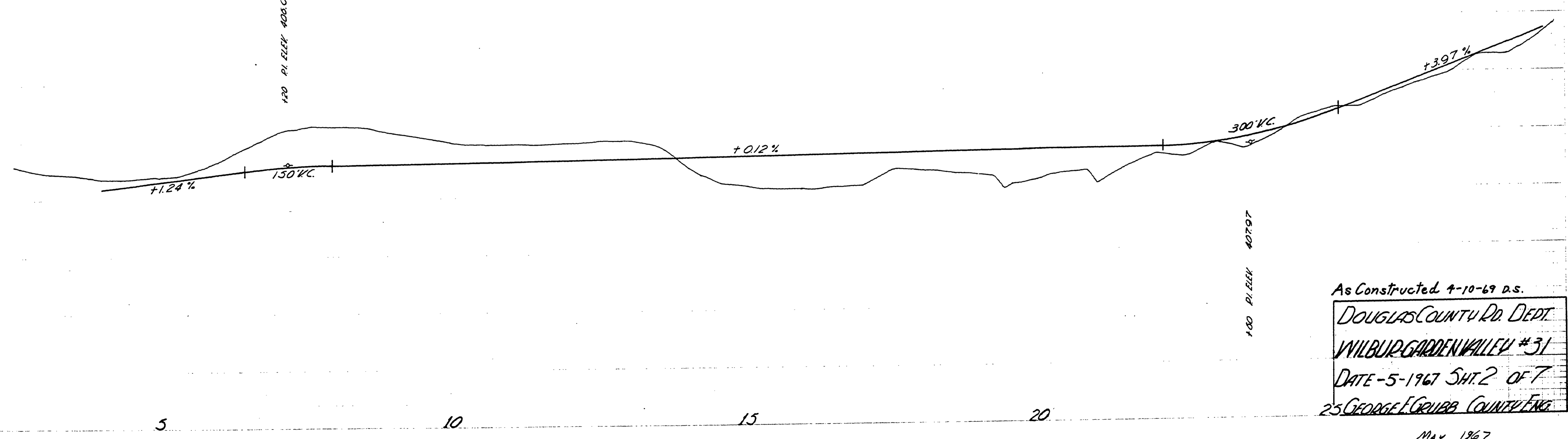

As Constructed 4-10-69 a.s.
 DOUGLAS COUNTY RD. DEPT.
 WILBUR GARDEN VALLEY #31
 DATE - 5-1967 SH. 2 OF 7
 25 GEORGE GRUBB COUNTY ENG.

06460615

MAY, 1967

Co. Rd. # 31 skt. 2 of 7

(51)

M.P. 6.46-6.15