

FILED
RECORDED
MAY 10 1955
COUNTY SURVEYOR
DOUGLAS COUNTY, OREG.

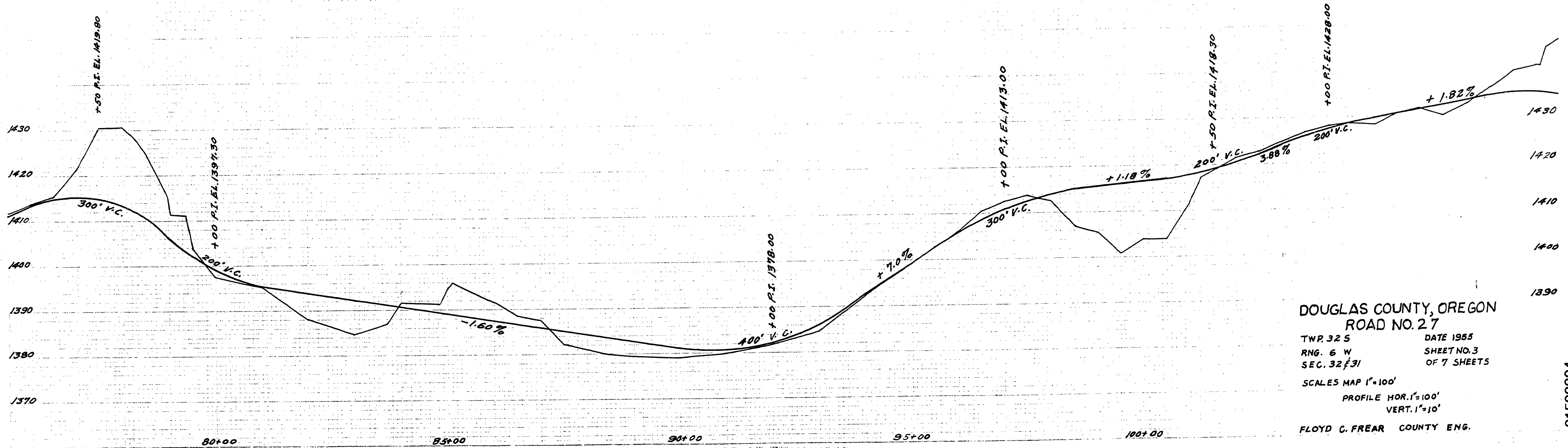

DOUGLAS COUNTY, OREGON
ROAD NO. 27
TWP. 32 S DATE 1955
RNG. 6 W SHEET NO. 3
SEC. 32 f 31 OF 7 SHEETS
SCALES MAP 1"=100'
PROFILE HOR. 1"=100'
VERT. 1"=10'
FLOYD C. FREAR COUNTY ENG.

M.P. 1.50-2.04

1955
Co. Rd. # 27 sht. 3 of 7

01500204

15