

DOUGLAS COUNTY HIGHWAY IMPROVEMENT

PROFILE AND ALIGNMENT OF YONCALLA-HAYHURST ROAD (JORDAN HILL SECTION)

SECTIONS 7 & 8 Twp 23 S R 5 W. N. M.
 F.C. From County Surveyor & Roadmaster
 April 1920

N.E. Cor. Sec 1
 1/4 Sec. N. 27 1/2° E. 1505° ft.

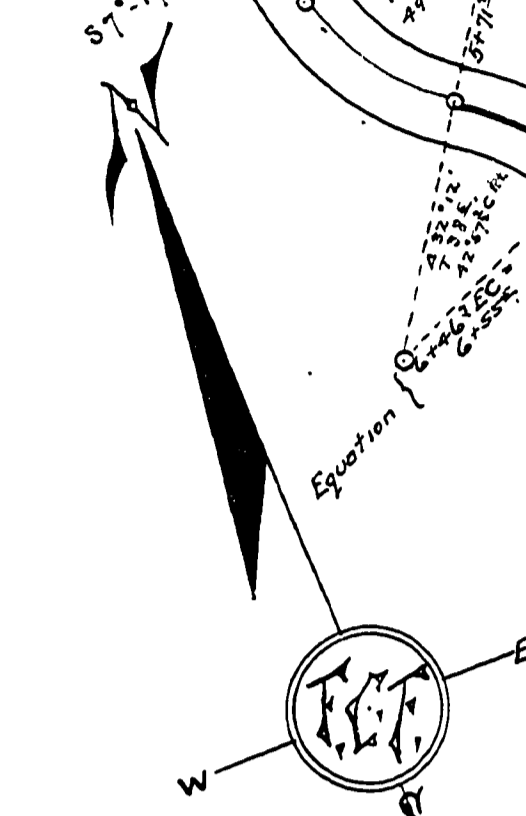

Geo. A. Brown to Douglas County
 40' Right of way St. 0+00-14+13.5
 Consideration \$125 Nov. 10, 1917
 R.R. 873, 263
 Note: First call of deed in error

Scale 1 in. = 100 ft.

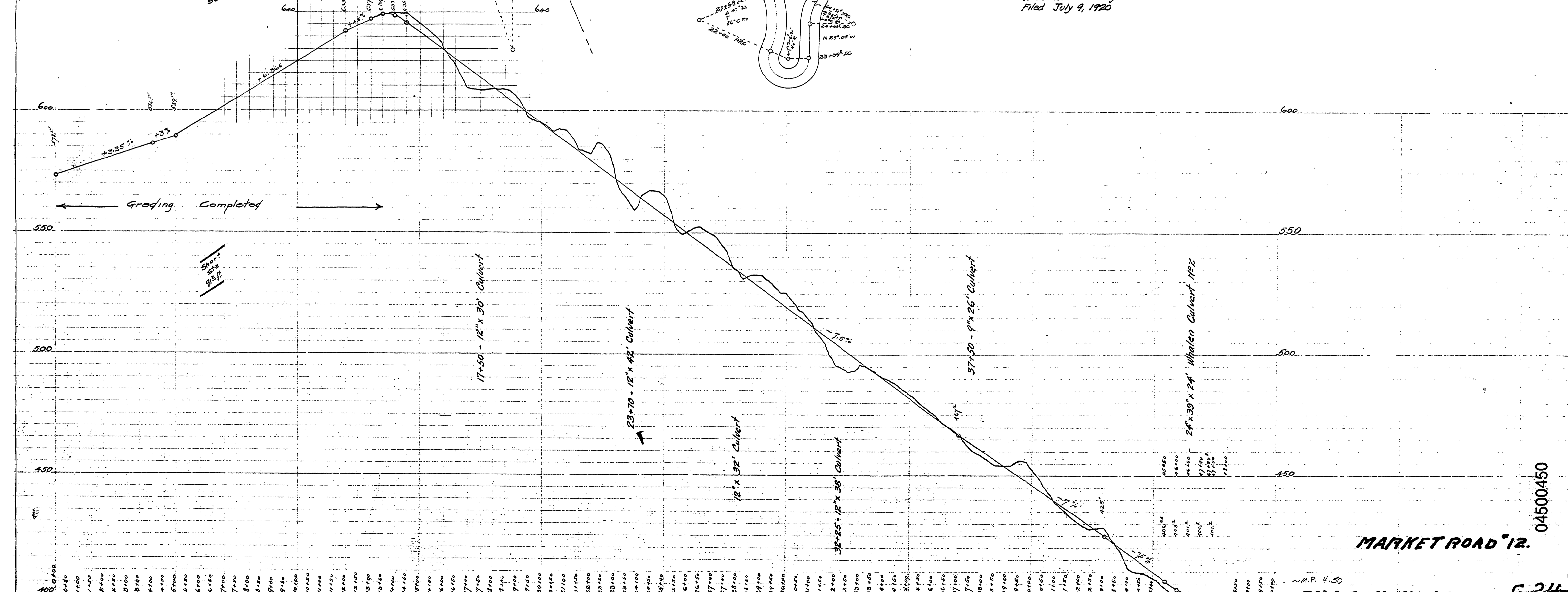

110% Grade Can be Obtained

John Jordan to Douglas County
 40' Right of way St. 13+76.5 to 36+89
 Consideration \$235.22
 Road Record 8 Page 350
 Filed July 9, 1920

-11%
 CHANGE AUG. 1920
 PETERSON DONATED
 NO DEED EXECUTED

T.H. Mitchell to Douglas County
 40' Right of way St. 36+89 to 44+57
 Consideration \$125.00
 July 9, 1920 Road Record 8 Page 350

MARKET ROAD 12.

04500450

N.M.P. 4.30
 T. 23-S. SEC. 7 & 8. APRIL 1920

F. 214