

NOTE: GRADES AS SHOWN ARE SUB GRADE

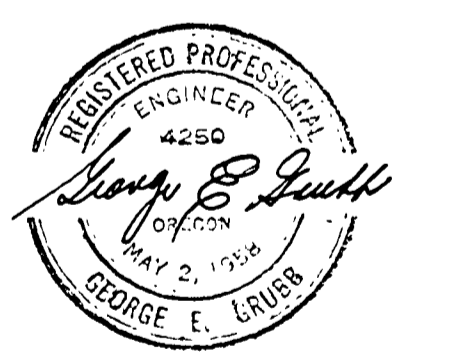
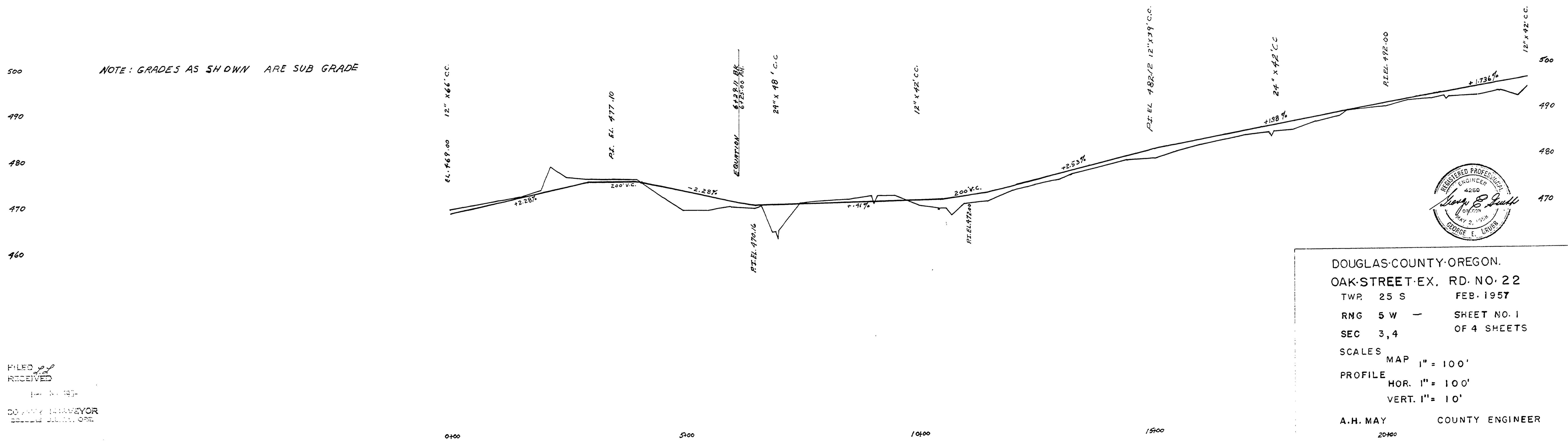

DOUGLAS COUNTY, OREGON.  
 OAK STREET EX. RD. NO. 22  
 TWP. 25 S FEB. 1957  
 RNG. 5 W SHEET NO. 1  
 SEC. 3, 4 OF 4 SHEETS  
 SCALES  
 MAP 1" = 100'  
 PROFILE HOR. 1" = 100'  
 VERT. 1" = 10'  
 A.H. MAY COUNTY ENGINEER

FILED  
 RECEIVED  
 COUNTY ENGINEER  
 DOUGLAS COUNTY, OREG.

00100056

M.P. 0.10 - 0.56

COPY #22 FEB 1957

