

FILED
RECEIVED
JUL 13 1957
COUNTY SURVEYOR
DOUGLAS COUNTY, OREGON

M. MARTIN NORRIS & EMMA E. NORRIS
THAT PORTION OF E 1/4 OF SW 1/4
BETWEEN COUNTY ROAD & CREEK
209/523

GEORGE J. & MURIEL J. PALITZCH
209/522
ALLE 1/4 OF SW 1/4 EXCEPT THAT PORTION
BETWEEN COUNTY ROAD & CREEK

NE 1/4 SW 1/4

NW 1/4 SE 1/4

GEORGE J. & MURIEL J. PALITZCH
249/212

NOTE:
O = 5/8 IRON PIN ON RIGHT OF WAY LINE

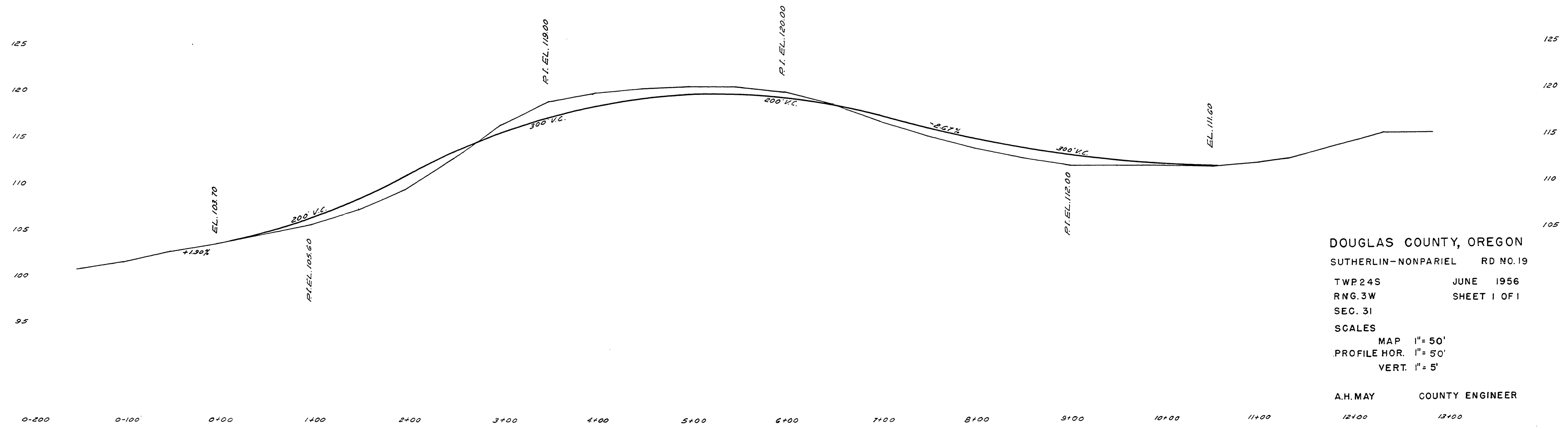

DOUGLAS COUNTY, OREGON
SUTHERLIN-NONPARIEL RD NO. 19
TWP. 24S JUNE 1956
RNG. 3W SHEET 1 OF 1
SEC. 31
SCALES
MAP 1" = 50'
PROFILE HOR. 1" = 50'
VERT. 1" = 5'

A.H. MAY COUNTY ENGINEER
12+00 13+00

APPROX. R.P. 13.04 - 13.25

13041325

23