

Note: Bearings and coordinates shown are based on the Lambert Grid Projection, Oregon, South Zone. Subdivision of sections is only approximate and should not be relied on. Corners marked "Found" have been located.

FILED  
RECEIVED  
COUNTY ENGINEER  
DOUGLAS COUNTY, OREG.

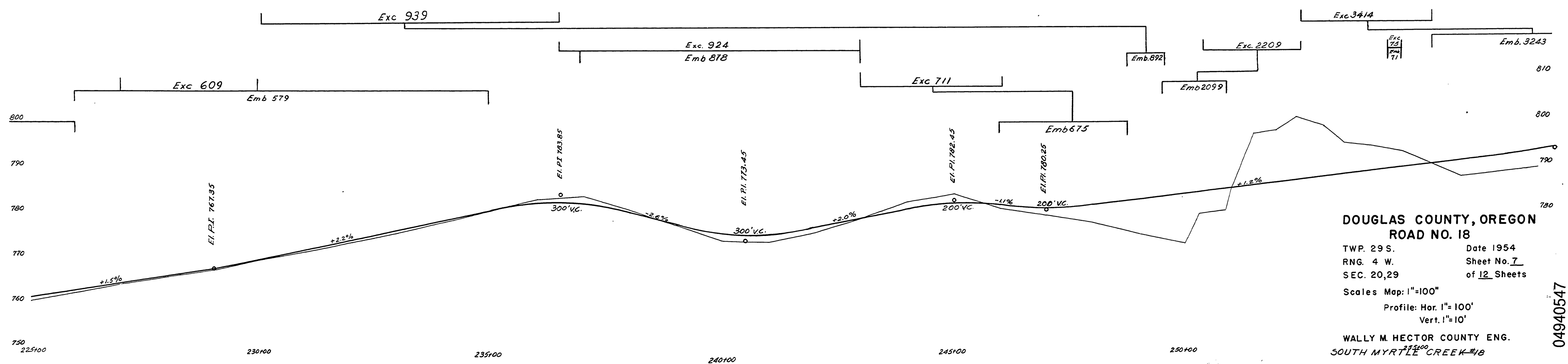

**DOUGLAS COUNTY, OREGON  
ROAD NO. 18**

TWP. 29 S. Date 1954  
RNG. 4 W. Sheet No. 7  
SEC. 20, 29 of 12 Sheets

Scales Map: 1"=100"  
Profile: Hor. 1"=100'  
Vert. 1"=10'

WALLY M. HECTOR COUNTY ENG.  
SOUTH MYRTLE CREEK #18

File # 18 1954 7 of 12

M.P. 4.94 - 5.47

04940547

