

Note: Bearings shown are based on Lambert Grid Projection, Oregon, South Zone. Subdivision of Sections is only an approximation and should not be relied on. Corners marked "Found" have been located.

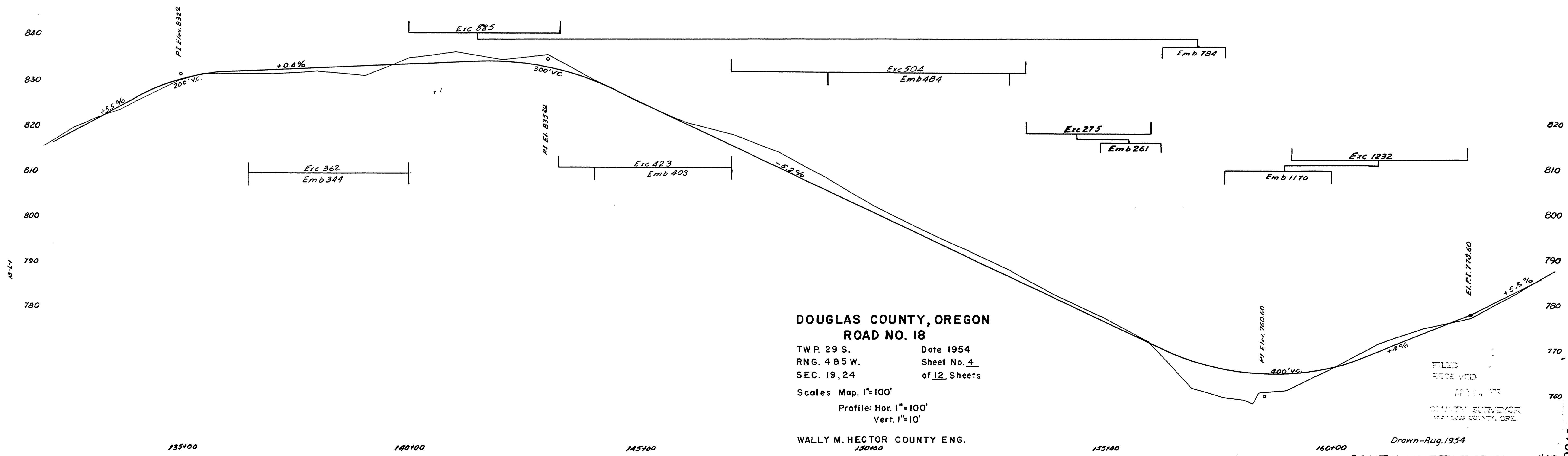

DOUGLAS COUNTY, OREGON
ROAD NO. 18
 TWP. 29 S. Date 1954
 RNG. 485 W. Sheet No. 4
 SEC. 19, 24 of 12 Sheets
 Scales Map. 1"=100'
 Profile: Hor. 1"=100'
 Vert. 1"=10'
 WALLY M. HECTOR COUNTY ENG.

FILED
 RECEIVED
 COUNTY SURVEYOR
 DOUGLAS COUNTY, ORE.

Drawn - Aug. 1954
 SOUTH MYRTLE CREEK RD #18
 P. # 18

03010363