

NOTE-Bearing and coordinates based on the Lambert Grid Projection Oregon, South Zone True North lies N 1° 43' 00" E

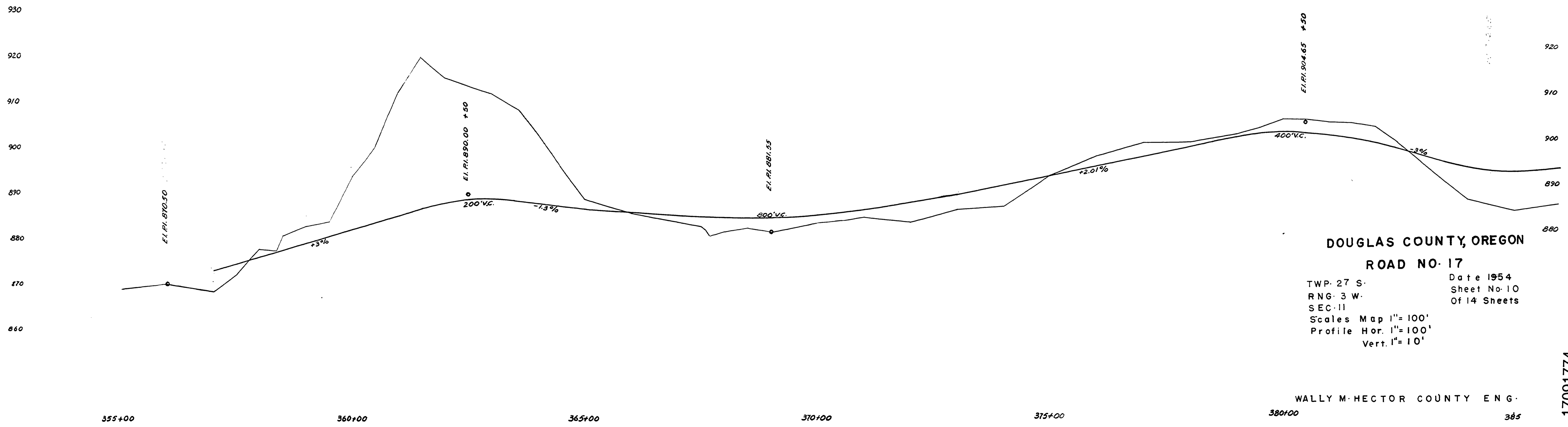

DOUGLAS COUNTY, OREGON  
 ROAD NO. 17  
 TWP. 27 S. Date 1954  
 RNG. 3 W. Sheet No. 10  
 SEC. 11 Of 14 Sheets  
 Scales Map 1" = 100'  
 Profile Hor. 1" = 100'  
 Vert. 1" = 10'

WALLY M. HECTOR COUNTY ENG.

M.P. 17.09 - 17.74

R/W # 17 159 200 10 19

17091774

