

• Indicates 3/4" Iron Pins & 4x4 Posts

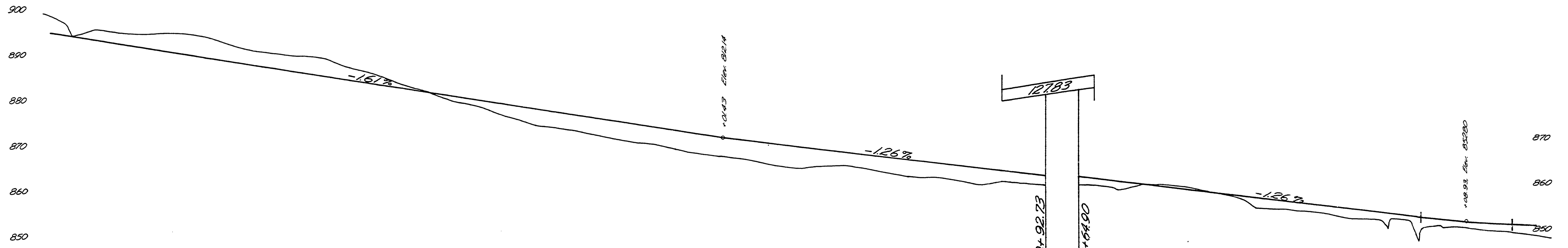

FILED
 RECEIVED
 DEC 11 1964
 COUNTY SURVEYOR
 DOUGLAS COUNTY, ORE.

Douglas County Road Dept.
BUCKHORN SECT Rd #17
 Date June 10, 1964 Sheet 7 of 11
 A.H. MAY County Engineer

08640926

500

505

510

515

520

525

530

M.P. 8.64 - 9.26

Rd # 17 June 1964 Sht. 7 of 11

93