

DOUGLAS COUNTY OREGON

AS CONSTRUCTED

GRADING & SURFACING

BUCKHORN ROAD

COUNTY ROAD #17

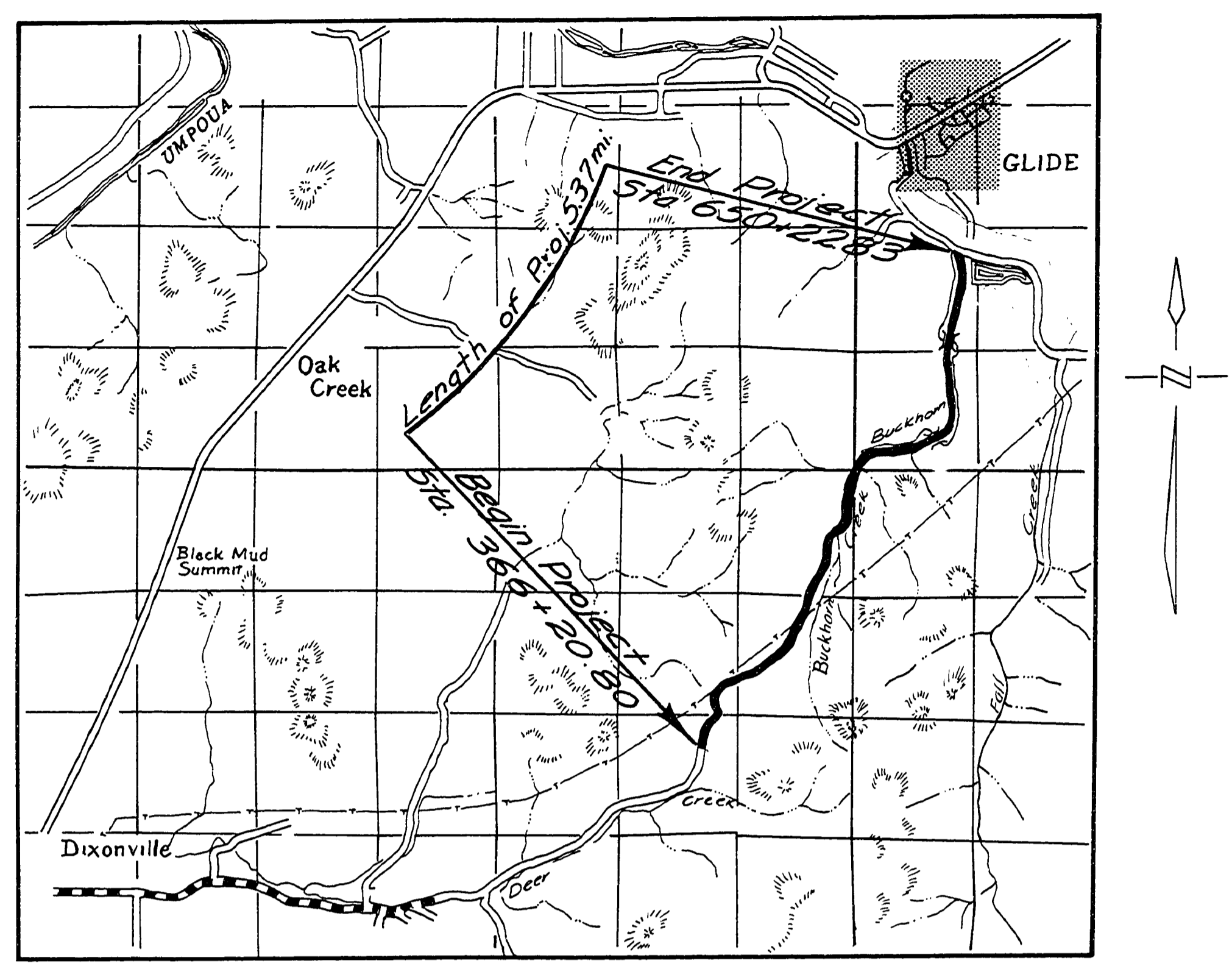

VICINITY MAP

Adopted by Resolution of
The County Court this 20th
day of May, 1964

V.T. Jackson
JUDGE
R. McFadden
COMMISSIONER
Paul Dorn
COMMISSIONER

Approved *W.H. Maul* Date Nov 16, 1964
COUNTY ENGINEER

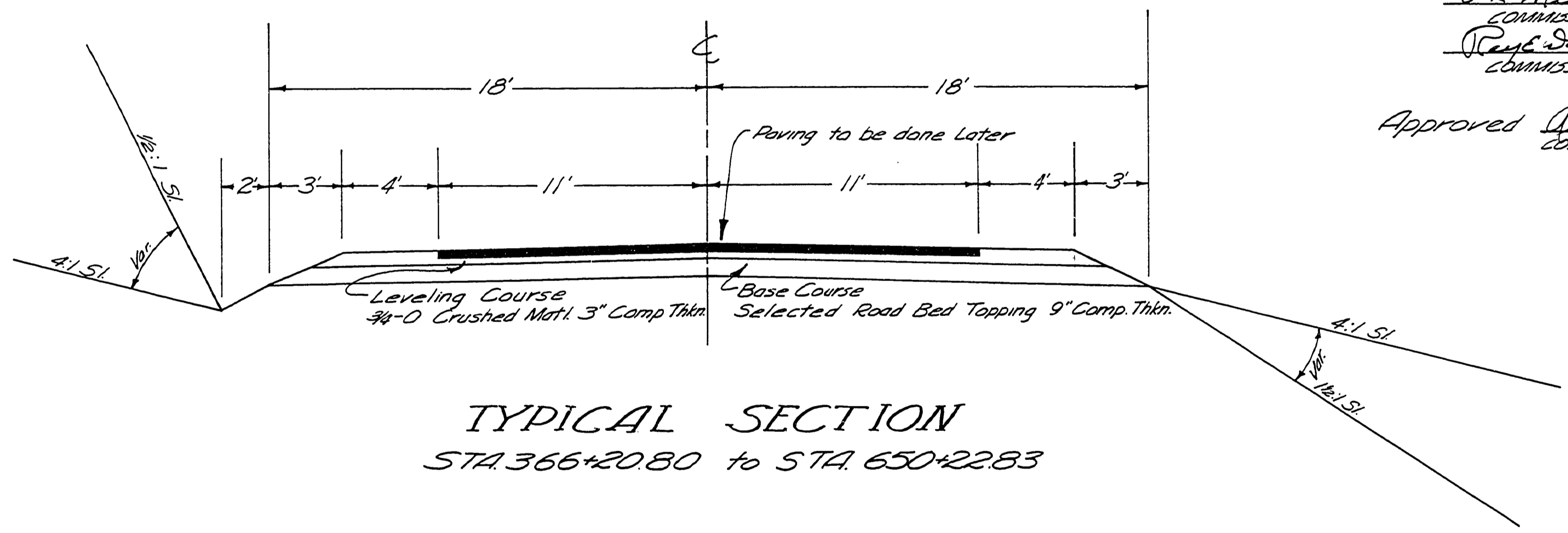

TYPICAL SECTION
STA. 366+20.80 to STA. 650+22.83

FILED
RECEIVED
COUNTY SURVEYOR
DOUGLAS COUNTY, ORE.

0610114C