

TWP. 28S. RNG. 6W.W.M.

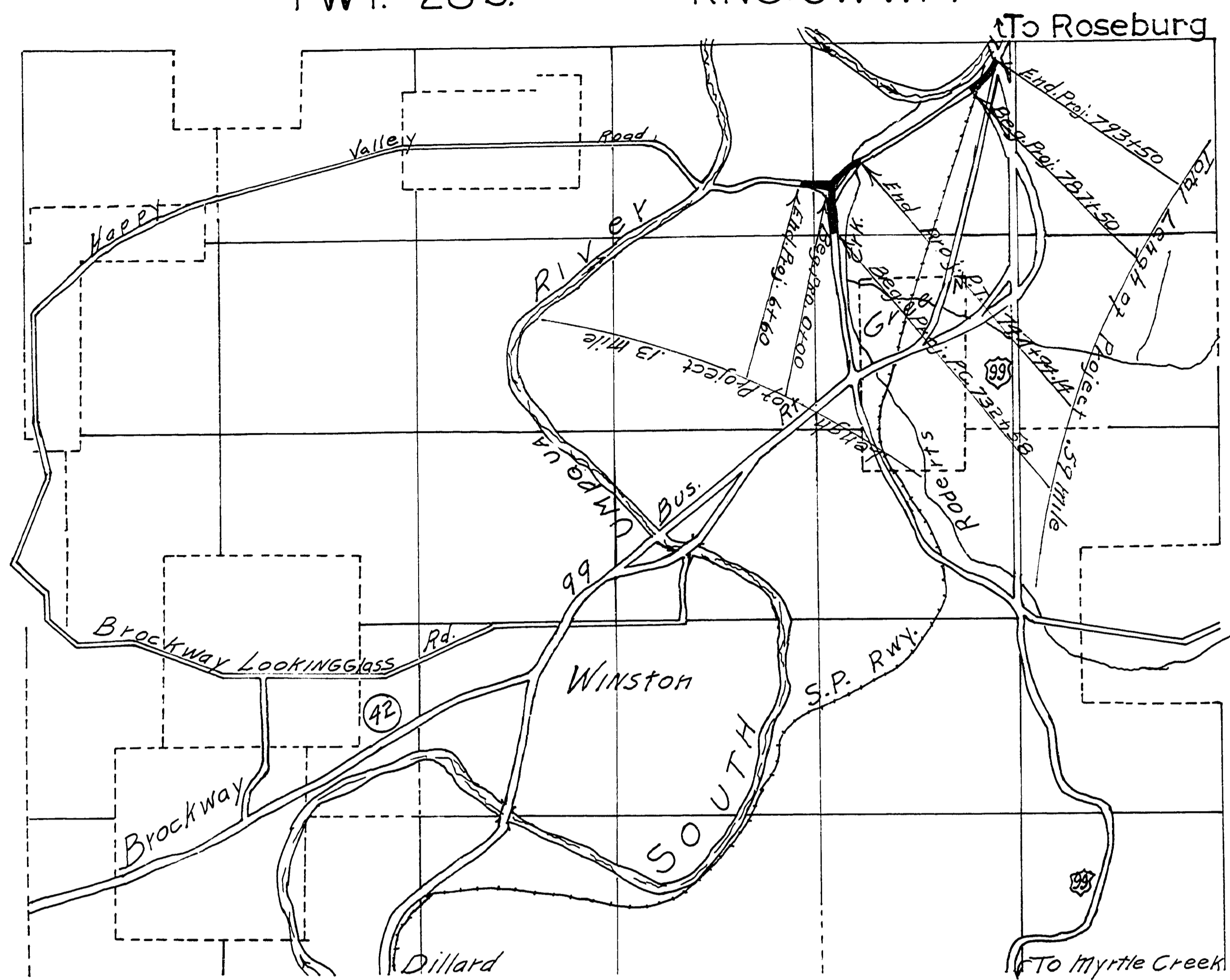

DOUGLAS COUNTY OREGON
 PLANS FOR PROPOSED PROJECT
AS CONSTRUCTED
 DIXONVILLE CARNES ROAD
 PROPOSED CHANNEL CHANGE
 COUNTY ROAD NO. 16
 COUNTY ROAD NO. 26
 FEB. - JULY. 1960



FILED
 RECEIVED
 FEB 15 1960
 COUNTY SURVEYOR
 DOUGLAS COUNTY, ORE.

DOUGLAS COUNTY OREGON
 DIXONVILLE CARNES RD. ^{No. 16}
 Twp. 27-28S Sec. 2
 Rng. 6 W Sheet 1 of 3
 Scales: Feb.-JULY. 1960
 Map 1" = 100'
 Profile Hor. 1" = 100'
 Vert. 1" = 10'
 A. H. May County Engineer

1411144C

